

Corporate & Community Services Committee Meeting

Agenda for Monday 21 September 2015

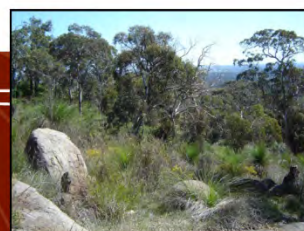

**shire of
kalamunda**

NOTICE OF MEETING CORPORATE & COMMUNITY SERVICES COMMITTEE

Dear Councillors

Notice is hereby given that the next meeting of the Corporate & Community Services Committee will be held in the Council Chambers, Administration Centre, 2 Railway Road, Kalamunda on **Monday 21 September 2015 at 6.30pm.**

Dinner will be served prior to the meeting, at 5.30pm.

Rhonda Hardy
Chief Executive Officer
16 September 2015

Our Vision and Our Values

Our Vision

The Shire will have a diversity of lifestyle and people. It will take pride in caring for the natural, social, cultural and built environments and provide opportunities for people of all ages.

Our Core Values

Service – We deliver excellent service by actively engaging and listening to each other.

Respect – We trust and respect each other by valuing our difference, communicating openly and showing integrity in all we do.

Diversity – We challenge ourselves by keeping our minds open and looking for all possibilities and opportunities.

Ethics – We provide honest, open, equitable and responsive leadership by demonstrating high standards of ethical behavior.

Our Aspirational Values

Prosperity – We will ensure our Shire has a robust economy through a mixture of industrial and commercial development.

Harmony – We will retain our natural assets in balance with our built environment.

Courage – We take risks that are calculated to lead us to a bold new future.

Creativity – We create and innovate to improve all we do.



INFORMATION FOR THE PUBLIC ATTENDING COMMITTEE OR COUNCIL MEETINGS

Welcome to this evening's meeting. The following information is provided on the meeting and matters which may affect members of the public.

If you have any queries related to procedural matters, please contact a member of staff.

Council Chambers – Seating Layout



Standing Committee Meetings – Procedures

1. Standing Committees are open to the public, except for Confidential Items listed on the Agenda.
2. Shire of Kalamunda Standing Committees have a membership of all 12 Councillors.
3. Unless otherwise advised a Standing Committee makes recommendations only to the next scheduled Ordinary Council Meeting.
4. Members of the public who are unfamiliar with meeting proceedings are invited to seek advice prior to the meeting from a Shire Staff Member.
5. Members of the public are able to ask questions at a Standing Committee Meeting during Public Question Time. The questions should be related to the purposes of the Standing Committee.
6. Members of the public wishing to make a comment on any Agenda item may request to do so by advising staff prior to commencement of the Standing Committee Meeting.
7. Comment from members of the public on any item of the Agenda is usually limited to three minutes and should address the Recommendations at the conclusion of the report.
8. To facilitate the smooth running of the meeting, silence is to be observed in the public gallery at all times except for Public Question Time.
9. All other arrangements are in general accordance with Council's Standing Orders, the Policies and decision of person chairing the Committee Meeting.

Emergency Procedures

Please view the position of the Exits, Fire Extinguishers and Outdoor Assembly Area as displayed on the wall of Council Chambers.

In case of an emergency follow the instructions given by Council Personnel.

We ask that you do not move your vehicle as this could potentially block access for emergency services vehicles.

Please remain at the assembly point until advised it is safe to leave.

INDEX

1.0	OFFICIAL OPENING.....	6
2.0	ATTENDANCE, APOLOGIES AND LEAVE OF ABSENCE PREVIOUSLY APPROVED	6
3.0	PUBLIC QUESTION TIME	6
4.0	PETITIONS/DEPUTATIONS	6
5.0	CONFIRMATION OF MINUTES OF PREVIOUS MEETING.....	6
6.0	ANNOUNCEMENTS BY THE PRESIDING MEMBER WITHOUT DISCUSSION.....	6
7.0	MATTERS FOR WHICH MEETING MAY BE CLOSED	6
8.0	DISCLOSURE OF INTERESTS.....	6
9.0	REPORTS TO COUNCIL	7
	33. DEBTORS AND CREDITORS REPORT FOR THE PERIOD ENDED 31 AUGUST 2015.....	8
	34. RATES DEBTORS REPORT FOR THE PERIOD ENDED 31 AUGUST 2015.....	55
	35. COMMUNITY CARE QUARTERLY REPORT – JUNE 2015	60
	36. COMMUNITY GROUPS LEASE POLICY PROPOSED AMENDMENTS	71
	37. COMMUNITY SPORT AND RECREATION FACILITIES FUND ANNUAL GRANTS 2015/16.....	79
	38. DRAFT PIONEER PARK MASTER PLAN	88
	39. SHIRE OF KALAMUNDA ADVISORY COMMITTEES – PROPOSED CHANGES	95
	40. PICKERING BROOK STONE FRUIT FESTIVAL.....	99
	41. LESMURDIE TENNIS CLUB (INC.) OF 22 FALLS ROAD, LESMURDIE – TERM OF LEASE	110
10.0	MOTIONS OF WHICH PREVIOUS NOTICE HAS BEEN GIVEN	115
11.0	QUESTIONS BY MEMBERS WITHOUT NOTICE	115
12.0	QUESTIONS BY MEMBERS OF WHICH DUE NOTICE HAS BEEN GIVEN	115
13.0	URGENT BUSINESS APPROVED BY THE PRESIDING MEMBER OR BY DECISION.....	115
14.0	MEETING CLOSED TO THE PUBLIC.....	115
15.0	CLOSURE	115

AGENDA

1.0 OFFICIAL OPENING

2.0 ATTENDANCE, APOLOGIES AND LEAVE OF ABSENCE PREVIOUSLY APPROVED

3.0 PUBLIC QUESTION TIME

A period of not less than 15 minutes is provided to allow questions from the gallery on matters relating to the functions of this Committee. For the purposes of Minuting, these questions and answers will be summarised.

4.0 PETITIONS/DEPUTATIONS

5.0 CONFIRMATION OF MINUTES OF PREVIOUS MEETING

5.1 That the Minutes of the Corporate & Community Services Committee Meeting held on 17 August 2015, as published and circulated, are confirmed as a true and accurate record of the proceedings.

Moved:

Seconded:

Vote:

Statement by Presiding Member

"On the basis of the above Motion, I now sign the minutes as a true and accurate record of the meeting of 17 August 2015".

6.0 ANNOUNCEMENTS BY THE PRESIDING MEMBER WITHOUT DISCUSSION

7.0 MATTERS FOR WHICH MEETING MAY BE CLOSED

7.1 Nil.

8.0 DISCLOSURE OF INTERESTS

8.1 Disclosure of Financial and Proximity Interests

- a. Members must disclose the nature of their interest in matters to be discussed at the meeting. (Section 5.65 of the *Local Government Act 1995*.)
- b. Employees must disclose the nature of their interest in reports or advice when giving the report or advice to the meeting. (Section 5.70 of the *Local Government Act 1995*.)

8.2 Disclosure of Interest Affecting Impartiality

- a. Members and staff must disclose their interest in matters to be discussed at the meeting in respect of which the member or employee had given or will give advice.

9.0 REPORTS TO COUNCIL

Please Note: declaration of financial/conflict of interests to be recorded prior to dealing with each item.

Declaration of financial / conflict of interests to be recorded prior to dealing with each item.

33. Debtors and Creditors Report for the Period Ended 31 August 2015

Previous Items	N/A
Responsible Officer	Director Corporate Services
Service Area	Finance
File Reference	FI-CRS-002
Applicant	N/A
Owner	N/A
Attachment 1	Creditors Payment Listing for the month of August 2015
Attachment 2	Summary of Debtors for the month of August 2015
Attachment 3	Summary of Creditors for the month of August 2015

PURPOSE

1. To receive the monthly report on creditors payment listings for the month of August 2015 (Attachment 1).
2. To receive the monthly report on debtors and creditors (Attachments 2 and 3).

BACKGROUND

3. Council has requested reports detailing outstanding debtors and creditors on a monthly basis.

DETAILS

Debtors

4. Invoices over 30 days total \$29,133.88, excluding trust balances, debts of significance are:
 - Haynes Street Larder, \$1,067.00, health services fees;
 - JJ's Sweet Bliss, \$1,067.00, health services fees;
 - MKP Management PTY, \$1,661.55, planning expenses;
 - The Ice Cream Man, \$1,067.00, health services fees; and
 - Zig Zag Gymnastics, \$2,291.67, hall hire.
5. Invoices over 60 days total \$19,205.69, debts of significance are:
 - Born to Sing, \$1,137.50, hall hire;
 - Early Bird Learning, \$1,680.00, hall hire;
 - FA Raja, \$1,243.00, health services fees;
 - Plume Estate, \$1,148.13, private works – signage; and
 - Zig Zag Café, \$5,102.06, lease / operating expenses.

6. Invoices over 90 days total \$14,332.38, excluding Forrestfield Industrial Area Development Scheme balances, debts of significance are:
- Kalamunda & Canning Rugby League, \$2,695.88, operating expenses;
 - Forrestfield United, \$3388.07, loan;
 - Kalamunda Cricket Club, \$2,730.71, operating expenses; and
 - Zig Zag Café, \$2,655.31, lease / operating expenses.

Creditors

7. Payments totalling \$3,213,086.97 were made during the month of August 2015. Standard payment terms are 30 days from the end of the month, with local businesses and contractors on 14 day terms.
8. Significant Municipal payments made in the month were:

Supplier	Purpose	\$
Australian Tax Office	PAYG payments	508,903.31
Beaver Tree services	Tree pruning services – various locations	89,005.62
DMC Cleaning	Cleaning services – various locations	54,969.29
Granotek Contracting	Skate park construction – Hartfield Park Recreation Centre – final claim	130,900.00
Eastern Metropolitan Regional Council	Domestic/Waste Charges and disposal fees	153,826.80
IT Vision	Annual licence fee- synergy soft database	81,494.60
YMCA of Perth Inc	Management agreement – charges for the final quarter to 30 June 2015	89,125.30
Perth Waste Pty Ltd	Weekly collection and disposal of waste services	130,343.14
Synergy	Power charges – various locations	174,447.70
Telstra Corporation	Telephone expenses	88,135.25
WML Consultants Pty Ltd	Supply design plans for various projects	57,361.65
WA Local Government Superannuation Plan	Superannuation contributions	274,330.59

These payments total \$1,832,843.25 and represent 57% of all payments for the month.

Payroll

9. Salaries are paid in fortnightly cycles. A total of \$1,111,868.27 was paid in net salaries for the month of August 2015.

10. Details are provided in (Attachment 1) after the creditor's payment listing.

Trust Account Payments

11. The Trust Accounts maintained by the Shire relate to the following types:

- CELL 9 Trust
- POS Trust
- BCITF Levy
- Building Licence Levy
- Unclaimed Monies

12. The following payments were made from the Trust Accounts in the month of August 2015.

Cell 9 Trust		Amount (\$)
Date	Description	
24/8/2015	McLeods Solicitors – acquisition of a portion of 30 Hale Rd, Wattle Grove	692.00
24/8/2015	MI Singh Family Trust – Consultancy services review of Cell 9 infrastructure costs and contributions	15,200.00
BCITF Levy		Amount (\$)
Date	Description	
6/8/2015	Building and Construction Industry – payment for July 2015	29,554.10
Building Licence Levy		Amount (\$)
Date	Description	
21/8/2015	Terra Spei Pty Ltd – Building services levy refund	5,715.16

STATUTORY AND LEGAL CONSIDERATIONS

13. In accordance with the requirements of the *Local Government (Financial Management) Regulations 1996 (Regulation 13)* a list of accounts paid by the Chief Executive Officer is to be prepared each month and presented in the manner required as per the Regulation.

POLICY CONSIDERATIONS

14. Nil.

COMMUNITY ENGAGEMENT REQUIREMENTS

15. Nil.

FINANCIAL CONSIDERATIONS

16. Nil.

STRATEGIC COMMUNITY PLAN

Strategic Planning Alignment

17. *Kalamunda Advancing: Strategic Community Plan to 2023*

OBJECTIVE 6.8 - To ensure financial sustainability through the implementation of effective financial management, systems and plans.

Strategy 6.8.4 Provide effective financial services to support the Shire's operations and to meet sustainability planning, reporting and accountability requirements.

SUSTAINABILITY

Social Implications

18. Nil.

Economic Implications

19. Nil.

Environmental Implications

20. Nil.

RISK MANAGEMENT CONSIDERATIONS

Debtors

21.

Risk	Likelihood	Consequence	Rating	Action/Strategy
The Shire is exposed to the potential risk of the debtor failing to make payments resulting in the disruption of cash flow.	Possible	Minor	Medium	Ensure debt collections is rigorously managed.

Creditors

22.

Risk	Likelihood	Consequence	Rating	Action/Strategy
Adverse credit records due to the Shire defaulting on creditor.	Possible	Minor	Medium	Ensure all disputes are resolved in a timely manner.

OFFICER COMMENT

23. Nil.

Voting Requirements: Simple Majority

OFFICER RECOMMENDATION (C&C 33/2015)

That Council:

1. Receives the list of payments made from the Municipal Accounts in August 2015 (Attachment 1) in accordance with the requirements of the *Local Government (Financial Management) Regulations 1996 (Regulation 12)*.
2. Receives the list of payments made from the Trust Accounts in August 2015 as noted in point 13 above in accordance with the requirements of the *Local Government (Financial Management) Regulations 1996 (Regulation 12)*.
3. Receives the outstanding debtors (Attachment 2) and creditors (Attachment 3) reports for the month of August 2015.

Moved:

Seconded:

Vote:

Attachment 1

Chq/EFT	Date	Name	Description	Amount
863	29/07/2015	AUSTRALIAN TAXATION OFFICE	TAXATION	172056.50
864	04/08/2015	LES MILLS AUSTRALIA	MONTHLY LICENCE FEE - AUGUST 2015	1030.56
865	11/08/2015	IINET TECHNOLOGIES PTY LTD	INTERNET ACCESS - AUGUST 2015	685.99
866	12/08/2015	AUSTRALIAN TAXATION OFFICE	TAXATION	169414.97
867	12/08/2015	FLEETCARE PTY LTD	STAFF CONTRIBUTIONS TO NOVATED / OPERATING LEASING - JULY 2015	4288.08
868	17/08/2015	WESTERN AUSTRALIAN TREASURY CORPORATION	LOAN NO.219 FIXED COMPONENT	17037.83
869	17/08/2015	COMMONWEALTH BANK BUSINESS CARD	BUSINESS CORPORATE CARD – VARIOUS COSTS HACC ACTIVITY OFFICER \$341.14 HACC ACTIVITY OFFICER \$678.00 LIBRARY SERVICES TEAM LEADER \$484.78 HACC ACTIVITY OFFICER \$298.95 HACC ACTIVITY OFFICER \$6.67 BUILDING MAINTENANCE OFFICER \$649.63 HACC ACTIVITY OFFICER \$100.07 FUNCTIONS CO-ORDINATOR \$2668.70 BUILDING MAINTENANCE OFFICER \$740.00 CO-ORDINATOR PROCUREMENT \$4235.53 HACC ACTIVITY OFFICER \$130.40 HACC ACTIVITY OFFICER \$225.00 HACC ACTIVITY OFFICER \$53.48 BUILDING MAINTENANCE OFFICER \$156.60 MANAGER HR \$5073.51 DAY CENTRE CO-ORDINATOR \$464.49	16306.95
870	18/08/2015	SG FLEET AUSTRALIA PTY LTD	MONTHLY LEASE FEES - JULY 2015	3824.03
871	25/08/2015	EASIFLEET MANAGEMENT	STAFF CONTRIBUTIONS TO NOVATED / OPERATING LEASES - AUGUST 2015	3466.53
872	26/08/2015	AUSTRALIAN TAXATION OFFICE	TAXATION	167431.84

Chq/EFT	Date	Name	Description	Amount
EFT44330	29/07/2015	A LEVIS & SONS WATER BORE DRILLERS	CLEAN OUT BORES AT HARTFIELD PARK	786.50
EFT44331	29/07/2015	STYLECORP CORPORATE WEAR	SUPPLY OF UNIFORM FOR VARIOUS STAFF MEMBERS	64.90
EFT44332	29/07/2015	WEX AUSTRALIA PTY LTD WRIGHT EXPRESS FUEL CARDS AUSTRALIA LTD	FUEL - PERIOD ENDING 27/07/15	4406.21
EFT44333	29/07/2015	SHAWSETT TRAINING PTY LTD	FIRST AID TRAINING FOR VARIOUS STAFF	1200.00
EFT44334	29/07/2015	NEVERFAIL SPRINGWATER LTD (KALA LIB)	BOTTLED WATER SUPPLIES / MAINTENANCE	83.20
EFT44335	29/07/2015	KALAMUNDA GLASS & WINDSCREENS ON WHEELS	GLASS REPAIRS / MAINTENANCE FOR VARIOUS LOCATIONS	510.00
EFT44336	29/07/2015	BACKSAFE AUSTRALIA	OFFICE SUPPLIES	519.20
EFT44337	29/07/2015	COMMUNITYWEST (INC)	REGISTRATION FOR 1 STAFF TO ATTEND BREAKFAST REABLEMENT VS CONSUMER CHOICE & CONTROL: CULTURE CLASH OR MARRIAGE MADE IN HEAVEN	29.00
EFT44338	29/07/2015	CABCHARGE AUSTRALIA LIMITED	CABCHARGE FEES	6.00
EFT44339	29/07/2015	NEVERFAIL SPRINGWATERLTD (FORRESTFIELD LIB)	BOTTLED WATER SUPPLIES / MAINTENANCE	114.21
EFT44340	29/07/2015	VE GRAPHICS PTY LTD	SUPPLY OF BANNERS FOR VARIOUS EVENTS	253.00
EFT44341	29/07/2015	VIP CARPET AND UPHOLSTERY CLEANING SERVICE	CARPET CLEANING AT VARIOUS LOCATIONS	680.00
EFT44342	29/07/2015	ANTHONY VINCENTI A & A HOLDINGS P/L	CROSSOVER CONTRIBUTION	400.00
EFT44343	29/07/2015	FRANK GYOERGY	FOOTPATH DEPOSIT REFUND	1000.00
EFT44344	29/07/2015	ELIZABETH PAYNE	SALE OF ARTWORK MAKURU EXHIBITION	140.00
EFT44345	29/07/2015	MARIA PERKINS	TRAVEL COMMUNITY VISITORS SCHEME REFUND	30.00
EFT44346	29/07/2015	IAN GILES ROGERS	FOOTPATH DEPOSIT REFUND	700.00
EFT44347	29/07/2015	KEITH JACOBSON	KEY BOND REFUND	50.00
EFT44348	29/07/2015	BENJAMIN THACKRAY	TRAVEL COMMUNITY VISITORS SCHEME REFUND	192.00
EFT44349	29/07/2015	BOGDAN T & HEATHER W PALMOWSKI	BALANCE OF FOOTPATH DEPOSIT REFUND	50.00
EFT44350	29/07/2015	HELEN HAYWARD	SALE OF ARTWORK MAKURU EXHIBITION	420.00

Chq/EFT	Date	Name	Description	Amount
EFT44351	29/07/2015	WA LOCAL GOVERNMENT SUPERANNUATION PLAN	SUPERANNUATION CONTRIBUTIONS	92677.70
EFT44352	29/07/2015	SHIRE OF KALAMUNDA STAFF SOCIAL CLUB	PAYROLL DEDUCTIONS	340.00
EFT44353	29/07/2015	CHILD SUPPORT AGENCY	PAYROLL DEDUCTIONS	575.68
EFT44354	29/07/2015	BUNNINGS BUILDING SUPPLIES	HARDWARE SUPPLIES FOR VARIOUS LOCATIONS	1343.59
EFT44355	29/07/2015	KALAMUNDA TOYOTA	PLANT / VEHICLE PARTS	1648.16
EFT44356	29/07/2015	WA LOCAL GOVERNMENT ASSOCIATION	WALGA ANNUAL MEMBERSHIP SUBSCRIPTION RENEWAL FEES 01/07/15 - 30/06/16	35391.47
EFT44357	29/07/2015	MCLEODS BARRISTERS & SOLICITORS	LEGAL EXPENSES	5932.41
EFT44358	29/07/2015	SESCO SECURITY CO	SECURITY MONITORING SERVICES FOR VARIOUS LOCATIONS	396.00
EFT44359	29/07/2015	LANDGATE VALUATIONS	VALUATIONS FOR VARIOUS LOCATIONS	1224.01
EFT44360	29/07/2015	WALKERS HARDWARE (MITRE 10)	HARDWARE SUPPLIES	226.82
EFT44361	29/07/2015	MCKAY EARTHMOVING PTY LTD	PLANT EQUIPMENT AND OPERATOR HIRE FOR VARIOUS LOCATIONS	8885.25
EFT44362	29/07/2015	BORAL CONSTRUCTION MATERIALS GROUP	ROAD MATERIALS FOR VARIOUS LOCATIONS	1871.49
EFT44363	29/07/2015	FASTA COURIERS	COURIER FEES	511.29
EFT44364	29/07/2015	THE WATERSHED WATER SYSTEMS	RETICULATION PARTS FOR VARIOUS RESERVES	5728.14
EFT44365	29/07/2015	SANDGROPER SEPTICS	SEPTIC / GREASE TANK CLEAN OUT SERVICES AT VARIOUS LOCATIONS	368.59
EFT44366	29/07/2015	MAJOR MOTORS PTY LTD	PLANT / VEHICLE PARTS	353.01
EFT44367	29/07/2015	ALSCO LINEN SERVICE	LINEN HIRE / LAUNDRY SERVICES	290.09
EFT44368	29/07/2015	BRADOCK PODIATRY SERVICES PTY LTD	PODIATRY SERVICES AT JACK HEALEY CENTRE	817.51
EFT44369	29/07/2015	DAYNITE TOWING SERVICE (WA) PTY LTD (FORMERLEY MOBITOW PTY LTD)	TOWING SERVICES	308.00
EFT44370	29/07/2015	KALA BOB KATS PTY LTD	PLANT EQUIPMENT AND OPERATOR HIRE FOR VARIOUS LOCATIONS	605.00
EFT44371	29/07/2015	DEPARTMENT OF PREMIER & CABINET STATE LAW PUBLISHER	GOVERNMENT GAZETTE ADVERTISING	213.75

Chq/EFT	Date	Name	Description	Amount
EFT44372	29/07/2015	LGIS INSURANCE BROKING SERVICES	MOTOR VEHICLE INSURANCE 30/06/15 - 30/06/16	4477.76
EFT44373	29/07/2015	GRONBEK SECURITY	SECURITY KEY SERVICES TO VARIOUS LOCATIONS	439.94
EFT44374	29/07/2015	GRIMES CONTRACTING PTY LTD	CONTRACTOR BUILDING MAINTENANCE FOR VARIOUS BUILDINGS	336.50
EFT44375	29/07/2015	TREE AESTHETICS	TREE LOPPING AND PRUNING AT VARIOUS LOCATIONS	220.00
EFT44376	29/07/2015	BGC ASPHALT	ROAD MATERIALS FOR VARIOUS LOCATIONS	1147.65
EFT44377	29/07/2015	FOODWORKS FRESH FORRESTFIELD	GROCERY SUPPLIES	1672.21
EFT44378	29/07/2015	LOGO APPOINTMENTS	HIRE OF TEMPORARY STAFF FOR DEPOT / ADMIN	16234.91
EFT44379	29/07/2015	J BLACKWOOD & SON LIMITED	PROTECTIVE WEAR / SUPPLIES	102.95
EFT44380	29/07/2015	PICKERING BROOK SPORTS CLUB (INC)	PICKERING BROOK GRANT FUNDING STAGE 2 CHANGEROOM VERANDAH PROJECT	13500.00
EFT44381	29/07/2015	HIGH WYCOMBE FAMILY CENTRE INC	ANNUAL CONTRIBUTION TOWARDS HIGH WYCOMBE CHILD HEALTH CLINIC OPERATIONAL COSTS	4426.15
EFT44382	29/07/2015	SUMMIT HOMES GROUP	FOOTPATH DEPOSIT REFUND	1500.00
EFT44383	29/07/2015	CRABBS KALAMUNDA (IGA)	GROCERY SUPPLIES	85.56
EFT44384	29/07/2015	CONTENT LIVING PTY LTD	FOOTPATH DEPOSIT REFUND	1000.00
EFT44385	29/07/2015	DALE ALCOCK HOMES PTY LTD	FOOTPATH DEPOSIT REFUNDS	5500.00
EFT44386	29/07/2015	KALAMUNDA VOLUNTEER BUSHFIRE BRIGADE	REIMBURSEMENT COSTS FOR VOLUNTEER BUSHFIRE BRIGADE	2042.01
EFT44387	29/07/2015	BANKWEST	AUDIT CERTIFICATE FEE	60.00
EFT44388	29/07/2015	PLUNKETT HOMES (1903) PTY LTD	PLANNING APPLICATION FEE REFUND	147.00
EFT44389	29/07/2015	FINISHING TOUCH	BUS CLEANING / DETAILING	200.00
EFT44390	29/07/2015	COMMISSIONER OF POLICE	VOLUNTEER POLICE CHECKS	14.70
EFT44391	29/07/2015	TOTAL EDEN PTY LTD	RETICULATION PARTS AS REQUIRED	174.76
EFT44392	29/07/2015	SEBEL FURNITURE	OFFICE FURNITURE FOR PETER ANDERTON CENTRE	10480.80

Chq/EFT	Date	Name	Description	Amount
EFT44393	29/07/2015	LOCAL GOVERNMENT MANAGERS AUSTRALIA (WA DIVISION)	SUBSCRIPTION RENEWAL 2015/16 FOR VARIOUS STAFF AND REGISTRATION FOR 1 STAFF TO ATTEND AGE FRIENDLY COMMUNITIES PD DAY	4128.00
EFT44394	29/07/2015	J CORP PTY LTD	FOOTPATH DEPOSIT REFUND	1000.00
EFT44395	29/07/2015	HILL TOP GROUP PTY	CONTRACTOR BUILDING MAINTENANCE FOR VARIOUS BUILDINGS	25383.98
EFT44396	29/07/2015	LOCAL GOVERNMENT PLANNERS ASSOCIATION	REGISTRATION FOR 1 STAFF TO ATTEND PLANNING AND DEVELOPMENT CONFERENCE	55.00
EFT44397	29/07/2015	TRACEY STEWART	HALL BOND REFUND	1050.00
EFT44398	29/07/2015	A KAPPELLA MUNDA CHOIR	HALL BOND REFUND	550.00
EFT44399	29/07/2015	RICHARD & CAROLINE A BABBAGE	PART DOG REGISTRATION REFUND	14.15
EFT44400	29/07/2015	CHRISTADELPHIAN WELFARE ASSOCIATION (WA) INC	REFUND OF 14/15 RATES AND ESL REBATE FOR 345 HAWTIN RD	7569.75
EFT44401	29/07/2015	CANNON HYGIENE AUSTRALIA PTY LTD	HYGIENE SERVICES FOR VARIOUS LOCATIONS	3687.74
EFT44402	29/07/2015	CONFECT EXPRESS	KIOSK SUPPLIES FOR HARTFIELD RECREATION CENTRE	406.41
EFT44403	29/07/2015	MASTERS ATHLETICS WA	KEY BOND REFUND ID #43711	50.00
EFT44404	29/07/2015	HILLVIEW LIFESTYLE VILLAGE PTY LTD	REFUND OF 14/15 RATES AND ESL REBATE FOR 597 KALAMUNDA ROAD	39337.48
EFT44405	29/07/2015	SPECIALISED SECURITY SHREDDING	SECURE DOCUMENT DISPOSAL BIN REMOVAL AND REPLACEMENT	55.00
EFT44406	29/07/2015	HERITAGE HOMES	FOOTPATH DEPOSIT REFUND	1500.00
EFT44407	29/07/2015	SIGNA RAMA	SUPPLY OF VARIOUS SIGNAGE	825.00
EFT44408	29/07/2015	THERESE KILKENNY	HALL & KEY BOND REFUND	350.00
EFT44409	29/07/2015	ELECTRICITY NETWORKS CORP T/A WESTERN POWER	SUPPLY OF POWDER COATING STREETLIGHTS KALAMUNDA	28398.70
EFT44410	29/07/2015	FORRESTFIELD TENNIS CLUB (INC)	FORRESTFIELD TENNIS CLUB HIRE FEES FROM HARTFIELD PARK REC CENTRE 26/06/15 - 30/06/15	24.00
EFT44411	29/07/2015	HILLS GAS SUPPLY	SUPPLY OF BOTTLED GAS FOR VARIOUS LOCATIONS	100.00

Chq/EFT	Date	Name	Description	Amount
EFT44412	29/07/2015	MAIDA VALE DELIVERY ROUND	PAPER AND MAGAZINES DELIVERIES FOR HIGH WYCOMBE LIBRARY	50.80
EFT44413	29/07/2015	GLENDA DAWN CHARLTON (PODIATRY)	PODIATRY SERVICES AT JACK HEALEY CENTRE	1120.73
EFT44414	29/07/2015	ALLEN JAMES BRIDGER	WHITEGOODS COLLECTION REFUND AT WASTE CENTRE	7.00
EFT44415	29/07/2015	SECURE TRAFFIC	TRAFFIC MANAGEMENT FOR VARIOUS LOCATIONS	2618.00
EFT44416	29/07/2015	JACKSON MCDONALD LAWYERS	LEGAL EXPENSES	385.00
EFT44417	29/07/2015	ST IVES VILLAGES PTY LTD	REFUND OF 14/15 RATES AND ESL REBATE FOR 17 SANDERSON ROAD	2874.52
EFT44418	29/07/2015	TANYA GRUMBALL	PART DOG REGISTRATION REFUND	77.50
EFT44419	29/07/2015	AUSTRALIAN SUPERANNUATION	SUPERANNUATION CONTRIBUTIONS	2193.32
EFT44420	29/07/2015	REST SUPERANNUATION	SUPERANNUATION CONTRIBUTIONS	2308.49
EFT44421	29/07/2015	ADELE IMMELMAN	REFUND OF INCORRECTLY DRAWN DIRECT DEBIT	300.00
EFT44422	29/07/2015	AMP RETIREMENT SAVINGS ACCOUNT	SUPERANNUATION CONTRIBUTIONS	244.16
EFT44423	29/07/2015	CBUS SUPERANNUATION	SUPERANNUATION CONTRIBUTIONS	226.89
EFT44424	29/07/2015	RESIDENTIAL BUILDING WA PTY LTD	FOOTPATH DEPOSIT REFUND	1000.00
EFT44425	29/07/2015	PETER TUCATS SUPERANNUATION FUND	SUPERANNUATION CONTRIBUTIONS	279.68
EFT44426	29/07/2015	COGNET NOMINEES PTY LTD ACF MAP SUPER FUND	SUPERANNUATION CONTRIBUTIONS	97.51
EFT44427	29/07/2015	AMP SUPER LEADER	SUPERANNUATION CONTRIBUTIONS	133.35
EFT44428	29/07/2015	VERA MURRAY	TRAVEL COMMUNITY VISITORS SCHEME REFUND	30.00
EFT44429	29/07/2015	HOSTPLUS PTY LTD	SUPERANNUATION CONTRIBUTIONS	228.14
EFT44430	29/07/2015	PH CONCRETE (WA) PTY LTD	FOOTPATH MAINTENANCE / REPAIRS FOR VARIOUS LOCATIONS	2318.76
EFT44431	29/07/2015	DISCOUNT HOME IMPROVEMENTS T/AS GRANNY FLATS WA	PLANNING APPLICATION FEE REFUND	162.70
EFT44432	29/07/2015	BEAVER TREE SERVICES	TREE REMOVAL / PRUNING FOR VARIOUS LOCATIONS	89005.62
EFT44433	29/07/2015	VISION SUPER PTY LTD	SUPERANNUATION CONTRIBUTIONS	849.36

Chq/EFT	Date	Name	Description	Amount
EFT44434	29/07/2015	KALEIDOSCOPE CRAFT KITS	DRY CLEANING / WASHING SERVICES FOR HARTFIELD PARK RECREATION	520.00
EFT44435	29/07/2015	KARIN HOTCHKIN	SALE OF ARTWORK - MAKURU EXHIBITION	126.00
EFT44436	29/07/2015	FIRST 5 MINUTES PTY LTD	WARDEN TRAINING COMBINED FOR STAFF FROM FF LIBRARY & HW LIBRARY, HW RECREATION CNTR & HARTFIELD PRK, KHACC	534.60
EFT44437	29/07/2015	STRATEGEN ENVIRONMENTAL CONSULTANTS	VARIATION FOR WILKINS ROAD ADVERTISING EXPENDITURE AND ONGOING WORKS FOR PROFESSIONAL SERVICES	8442.74
EFT44438	29/07/2015	EYEZON PTY LTD (WHAT'S ON)	ADVERTISING IN WHAT'S ON MAGAZINE	744.00
EFT44439	29/07/2015	ALDRIN DIAS	HALL BOND REFUND	364.70
EFT44440	29/07/2015	SHANE & JENNIFER BURNETT	FOOTPATH DEPOSIT REFUND	1500.00
EFT44441	29/07/2015	TOURISM COUNCIL WA	TOURISM COUNCIL / VISITOR CENTRE ASSOCIATION MEMBERSHIP & ATAP ACCREDITATION FEES 2015/16	1298.00
EFT44442	29/07/2015	FOXTEL	MONTHLY SUBSCRIPTION FEE FOR HPRC	205.00
EFT44443	29/07/2015	MACQUARIE EQUIPMENT RENTALS PTY LTD	HARTFIELD PARK RECREATION CENTRE CARDIO EQUIPMENT LEASE & KALAMUNDA WATER PARK EQUIPMENT LEASE	11969.60
EFT44444	29/07/2015	DONALD VEAL CONSULTANTS	ROAD SAFETY AUDIT KALAMUNDA/ABERNETHY RDS	3575.00
EFT44445	29/07/2015	KALAMUNDA ELECTRICS	ELECTRICAL REPAIRS / MAINTENANCE FOR VARIOUS LOCATIONS	6610.23
EFT44446	29/07/2015	SANJEEV SARAF & YUEN CHING TSUI	FOOTPATH DEPOSIT REFUND	1500.00
EFT44447	29/07/2015	A PLACE TO JUST BE	TRAINING ROOM HIRE & CATERING FOR 21 JULY	286.00
EFT44448	29/07/2015	MPJ (WA) PTY LTD	SUPERANNUATION CONTRIBUTIONS	565.96
EFT44449	29/07/2015	KCTT T/A KC TRAFFIC & TRANSPORT PTY LTD	TRAFFIC ENGINEERING CONSULTING AT VARIOUS LOCATIONS	8175.75
EFT44450	29/07/2015	JANE & NICHOLAS STOWE	HALL & KEY BOND REFUND, LESS SPECIAL CLEANING FEES	256.52

Chq/EFT	Date	Name	Description	Amount
EFT44451	29/07/2015	CUROST MILK SUPPLY	MILK SUPPLY FOR ADMINISTRATION CENTRE AND DEPOT	533.16
EFT44452	29/07/2015	FOOTHILLS MENS SHED INC	MANUFACTURE & SUPPLY FAIR GROUND STALL CHOCOLATE WHEEL & PICTURE FRAME FOR CBDC	310.00
EFT44453	29/07/2015	WATER CORPORATION SUPERANNUATION PLAN	SUPERANNUATION CONTRIBUTIONS	272.04
EFT44454	29/07/2015	MPK TREE SERVICES	TREE REMOVAL / BRANCH PRUNING AT VARIOUS LOCATIONS	5115.00
EFT44455	29/07/2015	A1 TROJAN PEST CONTROL	PEST CONTROL SERVICES FOR VARIOUS LOCATIONS	614.00
EFT44456	29/07/2015	STAN THE TYRE MAN (STAN'S TYRE SERVICE WA)	PLANT / VEHICLE PARTS	500.50
EFT44457	29/07/2015	HIT PRODUCTIONS PTY LTD	FINAL INSTALMENT OF GUARANTEE FOR 'AUSTRALIA DAY' PERFORMANCE 29/07/15	1466.67
EFT44458	29/07/2015	TWU SUPERANNUATION FUND	SUPERANNUATION CONTRIBUTIONS	217.13
EFT44459	29/07/2015	ATOD LTD	HALL & KEY BOND REFUND	455.00
EFT44460	29/07/2015	GUY CRAFT	HALL & KEY BOND REFUND	350.00
EFT44461	29/07/2015	AUSTRALIAN CATHOLIC SUPERANNUATION & RETIREMENT FUND (ACSRF)	SUPERANNUATION CONTRIBUTIONS	255.61
EFT44462	29/07/2015	LEBAR INVESTMENTS PTY LTD	FOOTPATH DEPOSIT REFUND	1500.00
EFT44463	29/07/2015	ZREST FURNITURE	SUPPLY OF STANDARD Z-REST FOOTRESTS WITH CARPET TOP	1790.00
EFT44464	29/07/2015	KINETIC SUPERANNUATION LTD	SUPERANNUATION CONTRIBUTIONS	193.82
EFT44465	29/07/2015	WBS GROUP PTY LTD	FOOTPATH DEPOSIT REFUND	2500.00
EFT44466	29/07/2015	PU TI LIAN SHE SOCIETY PERTH INC	FOOTPATH DEPOSIT REFUND	1500.00
EFT44467	29/07/2015	JULIA TAYLOR MY KIDS MEDIT8	KEY BOND REFUND	50.00
EFT44468	29/07/2015	STOCK PHOTOGRAPHY PTY LTD	CORPORATE PHOTO LIBRARY MANAGEMENT	3360.00
EFT44469	29/07/2015	URBANECO GARDENS	HOME MAINTENANCE SERVICES	3775.00
EFT44470	29/07/2015	AUSTRALIAN RENOVATION GROUP PTY LTD	PLANNING APPLICATION FEE REFUND	775.52
EFT44471	29/07/2015	PROMOTIONAL EXPOSURE	DEPOSIT FOR COMEDY GOLD BEST OF ADELAIDE FRINGE	500.00

Chq/EFT	Date	Name	Description	Amount
EFT44472	29/07/2015	VILLAGE SOLUTIONS AUSTRALIA RANGEVIEW VILLAGE	REFUND OF 14/15 REBATES FOR RANGEVIEW VILLAGE	4263.69
EFT44473	29/07/2015	KALAMUNDA MUSIC ACADEMY	HALL, KEY & GRAND PIANO BOND REFUND	565.00
EFT44474	29/07/2015	POWERWRAP MASTER PLAN	SUPERANNUATION CONTRIBUTIONS	286.12
EFT44475	29/07/2015	BLACKTREE TECHNOLOGY	LINK FOR RANGERS RADIO	3300.00
EFT44476	29/07/2015	JESSICA PHILIP	REIMBURSEMENT COST OF PRESCRIPTION SAFETY GLASSES	250.00
EFT44477	29/07/2015	NORTH PERSONAL SUPERANNUATION	SUPERANNUATION CONTRIBUTIONS	178.89
EFT44478	29/07/2015	THE SEO SHOP	DELIVERY OF CUSTOMISED 4 HOUR SEO TRAINING WORKSHOP	858.00
EFT44479	29/07/2015	BWMT SUPERANNUATION FUND	SUPERANNUATION CONTRIBUTIONS	147.26
EFT44480	29/07/2015	MURAL CREATIONS	PART PAYMENT FOR HARTFIELD PARK RECREATION CENTRE RPM MURAL	1000.00
EFT44481	29/07/2015	LG ASSIST AUSTRALIA	12 MONTH RENEWAL UNLIMITED ADVERTISING PACKAGE	2200.00
EFT44482	29/07/2015	TELSTRA SNP MONITORING PTY LTD	SECURITY MONITORING AND REPAIR SERVICES	4728.61
EFT44483	29/07/2015	SEMIRA MICALLEF	CROSSOVER CONTRIBUTION	400.00
EFT44484	29/07/2015	DIUYESH PARSANIA & AMEE BUTANI	CROSSOVER CONTRIBUTION	400.00
EFT44485	29/07/2015	JOHN DELLA BONA	FOOTPATH DEPOSIT REFUND	1000.00
EFT44486	29/07/2015	JENNIFER BANFIELD	SALE OF ARTWORK SPRING IN THE HILLS ARTWORK EXHIBITION	315.00
EFT44487	29/07/2015	IO TOU FU	FOOTPATH DEPOSIT REFUND	1500.00
EFT44488	29/07/2015	JESSE SIMPSON	HALL BOND REFUND	200.00
EFT44489	29/07/2015	LFD COLLECTIVE	KEY BOND REFUND	50.00
EFT44490	29/07/2015	MARIA DEBRUYN	REFUND HACC CLIENT ACCOUNT IN CREDIT	36.00
EFT44491	29/07/2015	ANDREW BENHAM	HALL & KEY BOND REFUND	350.00
EFT44492	12/08/2015	A LEVIS & SONS WATER BORE DRILLERS	DRILL AND TEST TWO WATER BORE HOLES AT LENIHAN CR	7196.97

Chq/EFT	Date	Name	Description	Amount
EFT44493	12/08/2015	STYLECORP CORPORATE WEAR	SUPPLY OF UNIFORM FOR VARIOUS STAFF MEMBERS	64.90
EFT44494	12/08/2015	WEX AUSTRALIA PTY LTD WRIGHT EXPRESS FUEL CARDS AUSTRALIA LTD	FUEL - PERIOD ENDING 10/08/15	4532.98
EFT44495	12/08/2015	FORRESTFIELD & DISTRICTS BOWLING CLUB INC	REIMBURSEMENT OF WATER SERVICES CHARGES AS PER LITRE OF VARIATION 03/03/15 MARCH APRIL 2015	507.78
EFT44496	12/08/2015	CARERS ASSOCIATION OF WESTERN AUSTRALIA	BOND REFUND	300.00
EFT44497	12/08/2015	JB HIFI MIDLAND	ELECTRICAL SUPPLIES	622.70
EFT44498	12/08/2015	KALAMUNDA GLASS & WINDSCREENS ON WHEELS	GLASS REPAIRS / MAINTENANCE FOR VARIOUS LOCATIONS	1551.72
EFT44499	12/08/2015	PFD FOOD SERVICES	KIOSK SUPPLIES FOR HARTFIELD PARK RECREATION CENTRE	42.40
EFT44500	12/08/2015	ASSETIC AUSTRALIA PTY LTD	ASSETIC ANNUAL SUPPORT AND MAINTENANCE JULY 2015 TO JUNE 2016	19923.75
EFT44501	12/08/2015	TOP OF THE LADDER GUTTER CLEANING	GUTTER CLEANING SERVICES FOR VARIOUS LOCATIONS	2156.00
EFT44502	12/08/2015	VIP CARPET AND UPHOLSTERY CLEANING SERVICE	CARPET CLEANING AT VARIOUS LOCATIONS	200.00
EFT44503	12/08/2015	MARIA PERKINS	TRAVEL COMMUNITY VISITORS SCHEME REFUND	30.00
EFT44504	12/08/2015	CAROL ANNE CRUTE	CONSIGNMENT SUPPLIER ZIG ZAG CULTURAL CENTRE 01/07/15 - 31/07/15	27.30
EFT44505	12/08/2015	NORMA HATCHETT	KEY BOND REFUND	50.00
EFT44506	12/08/2015	NOORAINI ANASTASI	HALL & KEY BOND REFUND	355.00
EFT44507	12/08/2015	VICKI LEAVER	HALL & KEY BOND REFUND	550.00
EFT44508	12/08/2015	ZANTHORREA NURSERY	SUPPLY OF PLANTS FOR LENIHAN CARPARK	74.70
EFT44509	12/08/2015	NATHAN & MICHELLE PEARCE	FOOTPATH DEPOSIT REFUND	1500.00
EFT44510	12/08/2015	WILHELMUS SMITH	FOOTPATH DEPOSIT REFUND	1500.00

Chq/EFT	Date	Name	Description	Amount
EFT44511	12/08/2015	GILL BAXTER	CONSIGNMENT SUPPLIER ZIG ZAG CULTURAL CENTRE 01/07/15 - 31/07/15	21.00
EFT44512	12/08/2015	SHERREE P DAVITT	INTERIM WEEKLIY CLEANING FOR HIGH WYCOMBE CHILD HEALTH CLINIC	130.00
EFT44513	12/08/2015	ALZTUFF	CONSIGNMENT SUPPLIER ZIG ZAG CULTURAL CENTRE 01/07/15 - 31/07/15	8.75
EFT44514	12/08/2015	WA LOCAL GOVERNMENT SUPERANNUATION PLAN	SUPERANNUATION CONTRIBUTIONS	90951.82
EFT44515	12/08/2015	SHIRE OF KALAMUNDA STAFF SOCIAL CLUB	PAYROLL DEDUCTIONS	526.00
EFT44516	12/08/2015	CHILD SUPPORT AGENCY	PAYROLL DEDUCTIONS	598.17
EFT44517	12/08/2015	AUSTRALIA POST	POSTAL EXPENSES / COUNTER BILLPAY TRANSACTION FEES	8021.12
EFT44518	12/08/2015	BUNNINGS BUILDING SUPPLIES	HARDWARE SUPPLIES FOR VARIOUS LOCATIONS	1377.86
EFT44519	12/08/2015	COVS PARTS PTY LTD	PLANT / VEHICLE PARTS	3721.62
EFT44520	12/08/2015	KALAMUNDA AUTO ELECTRICS	PLANT / VEHICLE PARTS	1336.00
EFT44521	12/08/2015	WA LOCAL GOVERNMENT ASSOCIATION	PROCUREMENT CONSULTANCY SERVICES SUBSCRIPTION 2015/2016	2530.00
EFT44522	12/08/2015	MCLEODS BARRISTERS & SOLICITORS	LEGAL EXPENSES	22992.03
EFT44523	12/08/2015	LANDGATE VALUATIONS	VALUATIONS FOR VARIOUS LOCATIONS	1203.65
EFT44524	12/08/2015	WALKERS HARDWARE (MITRE 10)	HARDWARE SUPPLIES	190.40
EFT44525	12/08/2015	MCKAY EARTHMOVING PTY LTD	PLANT EQUIPMENT AND OPERATOR HIRE FOR VARIOUS LOCATIONS	3877.50
EFT44526	12/08/2015	BORAL CONSTRUCTION MATERIALS GROUP	ROAD MATERIALS FOR VARIOUS LOCATIONS	1440.89
EFT44527	12/08/2015	3 VODAFONE HUTCHISON AUSTRALIA PTY LTD	COMMUNICATION EXPENSES FOR EMERGENCY SERVICES JULY 2015	1968.32
EFT44528	12/08/2015	FASTA COURIERS	COURIER FEES	395.17
EFT44529	12/08/2015	THE WATERSHED WATER SYSTEMS	RETICULATION PARTS FOR VARIOUS RESERVES	423.99
EFT44530	12/08/2015	ALSCO LINEN SERVICE	LINEN HIRE / LAUNDRY SERVICES	1430.20
EFT44531	12/08/2015	BRADOCK PODIATRY SERVICES PTY LTD	PODIATRY SERVICES AT JACK HEALEY CENTRE	1021.90

Chq/EFT	Date	Name	Description	Amount
EFT44532	12/08/2015	DAYNITE TOWING SERVICE (WA) PTY LTD (FORMERLEY MOBITOW PTY LTD)	TOWING SERVICES	418.00
EFT44533	12/08/2015	KALA BOB KATS PTY LTD	PLANT EQUIPMENT AND OPERATOR HIRE FOR VARIOUS LOCATIONS	2202.20
EFT44534	12/08/2015	GRIMES CONTRACTING PTY LTD	CONTRACTOR BUILDING MAINTENANCE FOR VARIOUS BUILDINGS	14215.20
EFT44535	12/08/2015	WESTSIDE FIRE SERVICES	TESTING AND INSPECTION OF FIRE EQUIPMENT / SUPPLIES	104.50
EFT44536	12/08/2015	FOODWORKS FRESH FORRESTFIELD	GROCERY SUPPLIES	435.76
EFT44537	12/08/2015	MARKETFORCE PTY LTD	ADVERTISING FOR VARIOUS JOBS / EVENTS	2511.16
EFT44538	12/08/2015	LOGO APPOINTMENTS	HIRE OF TEMPORARY STAFF FOR DEPOT / ADMIN	8099.46
EFT44539	12/08/2015	GREEN SKILLS (ECOJOBS)	LABOUR ASSISTANCE FOR TREE PLANTING	759.00
EFT44540	12/08/2015	CITY OF ARMADALE	REIMBURSEMENT OF KALAMUNDA'S SHARE OF ECONOMY.ID FOR SOUTH EASTERN METROPOLITAN CORRIDOR LOCAL GOVERNMENTS	1650.00
EFT44541	12/08/2015	AUSTRALIAN INSTITUTE OF MANAGEMENT	REGISTRATION FOR CUSTOMER STRATEGY MEETING	1650.00
EFT44542	12/08/2015	LOVEGROVE TURF SERVICES	TURF MAINTENANCE / SERVICES AT VARIOUS LOCATIONS	2640.00
EFT44543	12/08/2015	KALAMUNDA & DISTRICTS HISTORICAL SOCIETY	CONSIGNMENT SUPPLIER ZIG ZAG CULTURAL CENTRE 01/07/15 - 31/07/15	175.70
EFT44544	12/08/2015	SEBASTIAN BUTCHERS	CATERING SUPPLIES	98.00
EFT44545	12/08/2015	FORRESTFIELD BULLS AMATEUR BOXING CLUB	PART REIMBURSEMENT FOR BOXING CLUB FLOORING AT VENUE	781.65
EFT44546	12/08/2015	CRABBS KALAMUNDA (IGA)	GROCERY SUPPLIES	625.69
EFT44547	12/08/2015	VENTURA HOMES PTY LTD	FOOTPATH DEPOSIT REFUND	1500.00
EFT44548	12/08/2015	DALE ALCOCK HOMES PTY LTD	FOOTPATH DEPOSIT REFUND	1000.00
EFT44549	12/08/2015	HILLS BMX CLUB (INC)	KIDSPORT FUNDING FOR VARIOUS PLAYERS	400.00
EFT44550	12/08/2015	WATTLE GROVE VETERINARY HOSPITAL	VETERINARY FEES	560.00
EFT44551	12/08/2015	HOME GROUP WA PTY LTD	FOOTPATH DEPOSIT REFUND	1500.00
EFT44552	12/08/2015	ASHMY PTY LTD	FOOTPATH DEPOSIT REFUND	1000.00

Chq/EFT	Date	Name	Description	Amount
EFT44553	12/08/2015	ST JOHN AMBULANCE AUSTRALIA (WA) INC	FIRST AID SUPPLIES	277.52
EFT44554	12/08/2015	KALAMUNDA CRICKET CLUB	REIMBURSEMENT OF TURF MANAGEMENT FEES	11500.00
EFT44555	12/08/2015	SWAN EVENT HIRE	EQUIPMENT HIRE FOR VARIOUS EVENTS	82.12
EFT44556	12/08/2015	TOTAL EDEN PTY LTD	RETICULATION PARTS	1521.63
EFT44557	12/08/2015	HIGH WYCOMBE JUNIOR FOOTBALL CLUB	KIDSPORT FUNDING VARIOUS PLAYERS	590.00
EFT44558	12/08/2015	FORRESTFIELD NEWSPAPERS & MAGAZINES DELIVERY	NEWSPAPERS / MAGAZINES DELIVERIES FOR VARIOUS LOCATIONS	83.15
EFT44559	12/08/2015	MELANIE POPLÉ	SALE OF ARTWORK MAKURU EXHIBITION	112.00
EFT44560	12/08/2015	GRASSTREES AUSTRALIA	GARDEN AND VERGE SUPPLIES	627.00
EFT44561	12/08/2015	AMEREX FIRE (WA) (E FIRE AND SAFETY)	FIRE EQUIPMENT MAINTENANCE FOR VARIOUS LOCATIONS	847.10
EFT44562	12/08/2015	HILL TOP GROUP PTY	CONTRACTOR BUILDING MAINTENANCE FOR VARIOUS BUILDINGS	3055.38
EFT44563	12/08/2015	PARKS AND LEISURE AUSTRALIA	REGISTRATION FOR 1 STAFF TO ATTEND WA ACTIVATION OF OPEN SPACE THROUGH ARTS AND CULTURE	132.00
EFT44564	12/08/2015	NEW GENERATION HOMES TANGENT NOMINEES PTY LTD	FOOTPATH DEPOSIT REFUND	1500.00
EFT44565	12/08/2015	TRILOGY SERVICING PTY LTD	AIRCONDITIONING MAINTENANCE / REPAIRS FOR VARIOUS LOCATIONS	3208.63
EFT44566	12/08/2015	AUTO ONE KALAMUNDA	PLANT / VEHICLE PARTS	125.40
EFT44567	12/08/2015	KANYANA WILDLIFE REHABILITATION CENTRE INC	CONSIGNMENT SUPPLIER ZIG ZAG CULTURAL CENTRE 01/07/15 - 31/07/15	314.40
EFT44568	12/08/2015	KRISTIE MOILER	CONSIGNMENT SUPPLIER ZIG ZAG CULTURAL CENTRE 01/07/15 - 31/07/15	6.72
EFT44569	12/08/2015	PERRY ENVIRONMENTAL CONTRACTING	WEED CONTROL AT VARIOUS LOCATIONS	1980.00
EFT44570	12/08/2015	BIG W (AR W1.C3.U.07)	SUPPLY OF BOOKS, DVDS, CDS	721.00
EFT44571	12/08/2015	FOOD TECHNOLOGY SERVICES PTY LTD	HIRE OF TEMPORARY STAFF FOR HEALTH DEPARTMENT	1287.44
EFT44572	12/08/2015	DAVID & JACKI LE PAGE	CROSSOVER CONTRIBUTION	400.00

Chq/EFT	Date	Name	Description	Amount
EFT44573	12/08/2015	DONNA GAHAN	CONSIGNMENT SUPPLIER ZIG ZAG CULTURAL CENTRE 01/07/15 - 31/07/15	80.50
EFT44574	12/08/2015	HORT PLAN PTY LTD	FOOTPATH DEPOSIT REFUND	700.00
EFT44575	12/08/2015	LINDA NORRIS	HALL & KEY BOND REFUND	350.00
EFT44576	12/08/2015	ROSEBRIDGE HOUSE BED & BREAKFAST	EXPENSES FOR COMEDY GOLD PRODUCTION 22 AUGUST 2015	390.00
EFT44577	12/08/2015	BLUEPRINT HOMES	FOOTPATH DEPOSIT REFUND	1000.00
EFT44578	12/08/2015	WOOLWORTHS LIMITED	GROCERY SUPPLIES	317.74
EFT44579	12/08/2015	CELEBRATION NOMINEES PTY LTD	FOOTPATH DEPOSIT REFUND	1000.00
EFT44580	12/08/2015	EASTERN REGION SECURITY	SECURITY SERVICES TO VARIOUS SHIRE BUILDINGS	4806.06
EFT44581	12/08/2015	GLENDA DAWN CHARLTON (PODIATRY)	PODIATRY SERVICES AT JACK HEALEY CENTRE	1439.94
EFT44582	12/08/2015	EFT PAYMENT CANCELLED		
EFT44583	12/08/2015	INSTITUTE OF PUBLIC WORKS ENGINEERING AUST. (NAT)	REGISTRATION FOR 1 STAFF TO ATTEND LEVELS OF SERVICE & COMMUNITY ENGAGEMENT WORKSHOP	715.00
EFT44584	12/08/2015	AUSTRALIAN SUPERANNUATION	SUPERANNUATION CONTRIBUTIONS	1874.28
EFT44585	12/08/2015	REST SUPERANNUATION	SUPERANNUATION CONTRIBUTIONS	2189.35
EFT44586	12/08/2015	JWH GROUP PTY LTD	FOOTPATH DEPOSIT REFUND	1200.00
EFT44587	12/08/2015	JD'S FAST FOODS	CATERING FOR CORYMBIA FESTIVAL 2015	541.10
EFT44588	12/08/2015	SHIRLEY SPENCER	CONSIGNMENT SUPPLIER ZIG ZAG CULTURAL CENTRE 01/07/15 - 31/07/15	42.00
EFT44589	12/08/2015	AMP RETIREMENT SAVINGS ACCOUNT	SUPERANNUATION CONTRIBUTIONS	207.35
EFT44590	12/08/2015	CBUS SUPERANNUATION	SUPERANNUATION CONTRIBUTIONS	346.89
EFT44591	12/08/2015	ROSE SMART	MAINTAIN ROSE BEDS AT VARIOUS LOCATIONS	6087.60
EFT44592	12/08/2015	TOWNLEY'S PLUMBING & GAS SERVICE	PREVENTATIVE & REACTIVE PLUMBING SERVICES	1100.00
EFT44593	12/08/2015	MEGAN MCCORMACK	FOOTPATH DEPOSIT REFUND	1000.00
EFT44594	12/08/2015	TAURUS HOMES	FOOTPATH DEPOSIT REFUND	700.00
EFT44595	12/08/2015	PETER TUCATS SUPERANNUATION FUND	SUPERANNUATION CONTRIBUTIONS	933.53

Chq/EFT	Date	Name	Description	Amount
EFT44596	12/08/2015	COGNET NOMINEES PTY LTD ACF MAP SUPER FUND	SUPERANNUATION CONTRIBUTIONS	92.57
EFT44597	12/08/2015	AMP SUPER LEADER	SUPERANNUATION CONTRIBUTIONS	106.85
EFT44598	12/08/2015	VINCENT DALY T/A EZE CONSTRUCTIONS	FOOTPATH DEPOSIT REFUND AND CROSSOVER CONTRIBUTION	1400.00
EFT44599	12/08/2015	DEBRA A DIMASI	FOOTPATH DEPOSIT REFUND	1500.00
EFT44600	12/08/2015	LIBERTY OIL WESTERN AUSTRALIA PTY LTD	SUPPLY OF FUEL	23864.56
EFT44601	12/08/2015	HOSTPLUS PTY LTD	SUPERANNUATION CONTRIBUTIONS	270.31
EFT44602	12/08/2015	KALAMUNDA GOSPEL TRUST	CROSSOVER CONTRIBUTION	400.00
EFT44603	12/08/2015	PH CONCRETE (WA) PTY LTD	FOOTPATH MAINTENANCE / REPAIRS FOR VARIOUS LOCATIONS	4524.55
EFT44604	12/08/2015	JORGE'S CONTRACTING SERVICES	CLEANING SERVICES FOR PETER ANDERTON CENTRE	2179.10
EFT44605	12/08/2015	BENCHMARK MAINTENANCE SERVICES	CONTRACTOR BUILDING MAINTENANCE VARIOUS BUILDINGS	1589.50
EFT44606	12/08/2015	THE ROOF & WALL DOCTOR	BUILDING APPLICATION FEE REFUND	152.42
EFT44607	12/08/2015	NEROLIE BLURTON	SALE OF ARTWORK MAKURU EXHIBITION	203.00
EFT44608	12/08/2015	NANCY GILLESPIE	CONSIGNMENT SUPPLIER ZIG ZAG CULTURAL CENTRE 01/07/15 - 31/07/15	7.00
EFT44609	12/08/2015	BEAVER TREE SERVICES	TREE REMOVAL / PRUNING FOR VARIOUS LOCATIONS	4067.14
EFT44610	12/08/2015	VISION SUPER PTY LTD	SUPERANNUATION CONTRIBUTIONS	832.63
EFT44611	12/08/2015	SUE GOSLINGSMITH	CONSIGNMENT SUPPLIER ZIG ZAG CULTURAL CENTRE 01/07/15 - 31/07/15	52.50
EFT44612	12/08/2015	WESTSURE GROUP PTY LTD	CASH IN TRANSIT SERVICES JULY 2015	1761.87
EFT44613	12/08/2015	PATRICIA MOSS	CONSIGNMENT SUPPLIER ZIG ZAG CULTURAL CENTRE 01/07/15 - 31/07/15	2.45
EFT44614	12/08/2015	KALEIDOSCOPE CRAFT KITS	DRY CLEANING / WASHING SERVICES FOR HARTFIELD PARK RECREATION	80.00
EFT44615	12/08/2015	KARIN HOTCHKIN	CONSIGNMENT SUPPLIER ZIG ZAG CULTURAL CENTRE 01/07/15 - 31/07/15	10.50

Chq/EFT	Date	Name	Description	Amount
EFT44616	12/08/2015	ERROL DRUMMOND	CROSSOVER CONTRIBUTION	400.00
EFT44617	12/08/2015	LANCE A PORTMAN	FOOTPATH DEPOSIT REFUND	1500.00
EFT44618	12/08/2015	JENNIFER DE YOUNG	VOLUNTEER TRANSPORT REIMBURSEMENT REFUND	328.00
EFT44619	12/08/2015	CLAIRE O'NEILL	CLAIRE'S EMBROIDERY CONSIGNMENT SUPPLIER ZIG ZAG CULTURAL CENTRE 01/07/15 - 31/07/15	95.20
EFT44620	12/08/2015	RHONDA HARDY	REFUND OF EMPLOYMENT CONTRACT ALLOWANCE	1458.00
EFT44621	12/08/2015	LINDA STONES	CONSIGNMENT SUPPLIER ZIG ZAG CULTURAL CENTRE 01/07/15 - 31/07/15	135.80
EFT44622	12/08/2015	IAN MOSS	CONSIGNMENT SUPPLIER ZIG ZAG CULTURAL CENTRE 01/07/15 - 31/07/15	28.00
EFT44623	12/08/2015	IRENE GIERCZYCKI	FOOTPATH DEPOSIT REFUND	1500.00
EFT44624	12/08/2015	EYEZON PTY LTD (WHAT'S ON)	ADVERTISING	449.00
EFT44625	12/08/2015	PETER FALCONER	CONSIGNMENT SUPPLIER ZIG ZAG CULTURAL CENTRE 01/07/15 - 31/07/15	30.10
EFT44626	12/08/2015	KRISTEN LEANNE RODIC	KEY BOND REFUND	50.00
EFT44627	12/08/2015	SAFE T CARD AUSTRALIA PTY LTD	MONTHLY MONITORING CHARGES FOR VARIOUS LOCATIONS	33.00
EFT44628	12/08/2015	MARY FORWARD	CONSIGNMENT SUPPLIER ZIG ZAG CULTURAL CENTRE 01/07/15 - 31/07/15	12.95
EFT44629	12/08/2015	FOXTEL	MONTHLY SUBSCRIPTION FEE FOR HPRC	205.00
EFT44630	12/08/2015	HANDSON INFECTION CONTROL	HEPATITIS VACCINATION FOR STAFF	29.70
EFT44631	12/08/2015	KIERAN INGRAM	CONSIGNMENT SUPPLIER ZIG ZAG CULTURAL CENTRE 01/07/15 - 31/07/15	17.50
EFT44632	12/08/2015	TANGOS NETBALL CLUB	KIDSPORT FUNDING FOR VARIOUS PLAYERS	1600.00
EFT44633	12/08/2015	KALAMUNDA ELECTRICS	ELECTRICAL REPAIRS / MAINTENANCE FOR VARIOUS LOCATIONS	8037.92
EFT44634	12/08/2015	THE ARTFUL FLOWE	FELICIA LOWE CONSIGNMENT SUPPLIER ZIG ZAG CULTURAL CENTRE 01/07/15 - 31/07/15	16.80
EFT44635	12/08/2015	ETTIS PTY LTD	ANNUAL TAGGING AND TESTING OF ELECTIRICAL APPLIANCES	5626.06

Chq/EFT	Date	Name	Description	Amount
EFT44636	12/08/2015	DAVID GREEN	CONSIGNMENT SUPPLIER ZIG ZAG CULTURAL CENTRE 01/07/15 - 31/07/15	181.09
EFT44637	12/08/2015	REDCLIFFE JUNIOR FOOTBALL CLUB	KIDSPORT FUNDING FOR VARIOUS PLAYERS	400.00
EFT44638	12/08/2015	MPJ (WA) PTY LTD	SUPERANNUATION CONTRIBUTIONS	553.09
EFT44639	12/08/2015	MAX OGRADY PROJECT PHOTOGRAPHY	CONSIGNMENT SUPPLIER ZIG ZAG CULTURAL CENTRE 01/07/15 - 31/07/15	10.50
EFT44640	12/08/2015	KALAMUNDA DISTRICTS RUGBY UNION CLUB	KIDSPORT FUNDING FOR VARIOUS PLAYERS	1200.00
EFT44641	12/08/2015	SOVEREIGN BUILDING COMPANY PTY LTD	FOOTPATH DEPOSIT REFUND	1000.00
EFT44642	12/08/2015	NICHOLAS TAYLOR PHOTOGRAPHY	CONSIGNMENT SUPPLIER ZIG ZAG CULTURAL CENTRE 01/07/15 - 31/07/15	77.70
EFT44643	12/08/2015	SILK ON SILK (ROSEMARY LONSDALE)	CONSIGNMENT SUPPLIER ZIG ZAG CULTURAL CENTRE 01/07/15 - 31/07/15	255.50
EFT44644	12/08/2015	CUROST MILK SUPPLY	MILK SUPPLY FOR ADMINISTRATION CENTRE AND DEPOT	125.90
EFT44645	12/08/2015	DFP RECRUITMENT SERVICES PTY LTD	HIRE OF TEMPORARY STAFF	3395.70
EFT44646	12/08/2015	MAVIS PASKULICH	CONSIGNMENT SUPPLIER ZIG ZAG CULTURAL CENTRE 01/07/15 - 31/07/15	91.00
EFT44647	12/08/2015	WATER CORPORATION SUPERANNUATION PLAN	SUPERANNUATION CONTRIBUTIONS	273.16
EFT44648	12/08/2015	TIERRA ECOLOGIA	CONSIGNMENT SUPPLIER ZIG ZAG CULTURAL CENTRE 01/07/15 - 31/07/15	20.30
EFT44649	12/08/2015	MPK TREE SERVICES	TREE REMOVAL / BRANCH PRUNING AT VARIOUS LOCATIONS	12904.49
EFT44650	12/08/2015	A1 TROJAN PEST CONTROL	PEST CONTROL SERVICES FOR VARIOUS LOCATIONS	308.00
EFT44651	12/08/2015	OFF PEN PUBLISHING BETH BAKER	CONSIGNMENT SUPPLIER ZIG ZAG CULTURAL CENTRE 1/7/15 - 31/7/15	42.70
EFT44652	12/08/2015	STAN THE TYRE MAN (STAN'S TYRE SERVICE WA)	PLANT / VEHICLE PARTS	1309.00
EFT44653	12/08/2015	CHRIS KERSHAW PHOTOGRAPHY	PERTH HILLS SPRING FESTIVAL PHOTO SHOOT KALAMUNDA CENTRAL SHOPPING CENTRE	230.00
EFT44654	12/08/2015	TWU SUPERANNUATION FUND	SUPERANNUATION CONTRIBUTIONS	214.25

Chq/EFT	Date	Name	Description	Amount
EFT44655	12/08/2015	TJ BENNETT BUILDERS	FOOTPATH DEPOSIT REFUND	1500.00
EFT44656	12/08/2015	BALLIGART HELEN LOCK	CONSIGNMENT SUPPLIER ZIG ZAG CULTURAL CENTRE 01/07/15 - 31/07/15	4.20
EFT44657	12/08/2015	FLEETCARE PTY LTD	STAFF CONTRIBUTIONS TO NOVATED / OPERATING LEASING	9317.39
EFT44658	12/08/2015	ARTHUR ISSEYEGH	FOOTPATH DEPOSIT REFUND	1500.00
EFT44659	12/08/2015	AUSTRALIAN CATHOLIC SUPERANNUATION & RETIREMENT FUND (ACSRF)	SUPERANNUATION CONTRIBUTIONS	328.86
EFT44660	12/08/2015	LISA DRAPER	HALL & KEY BOND REFUND	350.00
EFT44661	12/08/2015	LINDAS BOOKS / ROLEYSTONE COURIER	CONSIGNMENT SUPPLIER ZIG ZAG CULTURAL CENTRE 01/07/15 - 31/07/15	18.90
EFT44662	12/08/2015	IRENE YOUNG	CONSIGNMENT SUPPLIER ZIG ZAG CULTURAL CENTRE 01/07/15 - 31/07/15	22.40
EFT44663	12/08/2015	IAN SIMPSON	FOOTPATH DEPOSIT REFUND	1000.00
EFT44664	12/08/2015	LINDA RAPHAEL	CONSIGNMENT SUPPLIER ZIG ZAG CULTURAL CENTRE 01/07/15 - 31/07/15	3.15
EFT44665	12/08/2015	WAITAWHILE ART	CONSIGNMENT SUPPLIER ZIG ZAG CULTURAL CENTRE 01/07/15 - 31/07/15	2.52
EFT44666	12/08/2015	KINETIC SUPERANNUATION LTD	SUPERANNUATION CONTRIBUTIONS	203.87
EFT44667	12/08/2015	RONALD PENDAL	VOLUNTEER TRANSPORT REIMBURSEMENT REFUND	136.00
EFT44668	12/08/2015	URBANECO GARDENS	HOME MAINTENANCE SERVICES	2275.00
EFT44669	12/08/2015	THE LUCKY CHARM	FINANCIAL REVIEW AND KALAMUNDA LIBRARY PURCHASES	105.19
EFT44670	12/08/2015	STEVEDORES JAZZ BAND	SUPPLY OF ROVING JAZZ BAND FOR QUIT TARGA WEST EVENT 14 AUGUST 2015	1800.00
EFT44671	12/08/2015	HERB & ESSENCE	CONSIGNMENT SUPPLIER ZIG ZAG CULTURAL CENTRE 01/07/15 - 31/07/15	47.25
EFT44672	12/08/2015	JESSICA JUBB	CONSIGNMENT SUPPLIER ZIG ZAG CULTURAL CENTRE 01/07/15 - 31/07/15	28.00
EFT44673	12/08/2015	SEATADVISOR PTY LTD	TICKET SALES JULY 2015	244.97

Chq/EFT	Date	Name	Description	Amount
EFT44674	12/08/2015	POWERWRAP MASTER PLAN	SUPERANNUATION CONTRIBUTIONS	286.12
EFT44675	12/08/2015	REBECCA SHERIDAN	FOOTPATH DEPOSIT REFUND	1500.00
EFT44676	12/08/2015	KARENNA WOOD	MARKETING SERVICES FOR PERTH HILLS SPRING FESTIVAL	1365.00
EFT44677	12/08/2015	NORTH PERSONAL SUPERANNUATION	SUPERANNUATION CONTRIBUTIONS	158.01
EFT44678	12/08/2015	CT HYDRAULICS	YEARLY INSPECTION OF VEHICLE HOIST - REPLACE BELTS AND RUBBER PADS	493.10
EFT44679	12/08/2015	GYULA KOZMA	FOOTPATH DEPOSIT REFUND	1500.00
EFT44680	12/08/2015	SECURE PAY	SEAT ADVISOR TRANSACTION FEES	6.60
EFT44681	12/08/2015	SONARE MEDIA	MC FOR SHIRE PRESIDENT'S LUNCH	1100.00
EFT44682	12/08/2015	GRANOTEK CONTRACTING	CONSTRUCTION OF FORRESTFIELD SKATE PARK	91850.00
EFT44683	12/08/2015	BWMT SUPERANNUATION FUND	SUPERANNUATION CONTRIBUTIONS	168.31
EFT44684	12/08/2015	BAND & ENTERTAINMENT BOOKING OFFICES	PERFORMANCE FOR MORNING MUSIC JULY 2015	850.00
EFT44685	12/08/2015	DELLA R MORRISON	MAKURU ART EXHIBITION	3300.00
EFT44686	12/08/2015	ASPIRE WORLDWIDE	BOND REFUND FOR THE USE OF THE SEMINAR ROOM AT THE ZIG ZAG CULTURAL CENTRE	300.00
EFT44687	12/08/2015	TURF GROWERS ASSOCIATION OF WA	REGISTRATION FOR 4 STAFF TO ATTEND WA TURF SEMINAR 2015	594.00
EFT44688	12/08/2015	INCLUSIVE BUILDING CONSULTANTS	FOOTPATH DEPOSIT REFUND	1500.00
EFT44689	12/08/2015	432 VENTURE PTY LTD	FOOTPATH DEPOSIT REFUND	1000.00
EFT44690	12/08/2015	KA CHI TUNG	CROSSOVER CONTRIBUTION	400.00
EFT44691	12/08/2015	MICHELE WRAGG	KEY BOND REFUND	50.00
EFT44692	27/08/2015	STYLECORP CORPORATE WEAR	SUPPLY OF UNIFORM FOR VARIOUS STAFF MEMBERS	2165.70
EFT44693	27/08/2015	ROBERT DUVAL FOODS PTY LTD	CATERING FOR QUIT TARGA WEST RALLY 2015	2280.81
EFT44694	27/08/2015	WEX AUSTRALIA PTY LTD WRIGHT EXPRESS FUEL CARDS AUSTRALIA LTD	FUEL - PERIOD ENDING 24/8/15	4059.59
EFT44695	27/08/2015	SALMAT MEDIAFORCE PTY LTD	DISTRIBUTION OF FLYERS FOR EVENTS WITHIN THE SHIRE	2237.10

Chq/EFT	Date	Name	Description	Amount
EFT44696	27/08/2015	VISION IDZ	OFFICE EQUIPMENT / SUPPLIES	301.40
EFT44697	27/08/2015	YMCA OF PERTH INC	YMCA MANAGEMENT AGREEMENT OF THE KALAMUNDA WATER PARK FOR PERIOD APRIL - JUNE 2015	81494.60
EFT44698	27/08/2015	JB HIFI MIDLAND	ELECTRICAL SUPPLIES	198.00
EFT44699	27/08/2015	KALAMUNDA GLASS & WINDSCREENS ON WHEELS	GLASS REPAIRS / MAINTENANCE FOR VARIOUS LOCATIONS	532.45
EFT44700	27/08/2015	FITNESS AUSTRALIA LTD	REGISTRATION RENEWAL 2015/2016	1460.00
EFT44701	27/08/2015	VISUAL PUBLICATIONS P/L COUNTRYWIDE PUBLICATIONS	PERTH HILLS VISITOR CENTRE LISTING ON WA VISITOR CENTRE 2015/16 MAP (GREATER PERTH)	125.00
EFT44702	27/08/2015	FREESTYLE NOW	PAYMENT FOR SKATE COACHING WORKSHOPS JULY AND AUGUST 2015	880.00
EFT44703	27/08/2015	CABCHARGE AUSTRALIA LIMITED	CABCHARGE FEES	61.20
EFT44704	27/08/2015	GREENLINE AG PTY LTD	PLANT / VEHICLE PARTS	2187.52
EFT44705	27/08/2015	PICTON PRESS	PRINTING OF BROCHURES FOR VARIOUS EVENTS	1565.82
EFT44706	27/08/2015	SYRINX ENVIRONMENTAL P/L	PLANTING AT CNR BERKSHIRE & BOODJERA RDS FORRESTFIELD	4595.25
EFT44707	27/08/2015	THE PLANNING GROUP WA PTY LTD	PROFESSIONAL PLANNING SERVICES FOR VARIOUS LOCATIONS	7012.50
EFT44708	27/08/2015	VE GRAPHICS PTY LTD	SUPPLY OF BANNERS FOR QUIT TARGA WEST RALLY	280.50
EFT44709	27/08/2015	BIDVEST FOODSERVICE	GROCERY SUPPLIES FOR PETER ANDERTON CENTRE	1255.74
EFT44710	27/08/2015	TOTALLY WORKWEAR MIDLAND	SUPPLY OF PROTECTIVE CLOTHING	371.22
EFT44711	27/08/2015	COTERRA ENVIRONMENT	ENVIRONMENTAL CONSULTING SERVICES	820.05
EFT44712	27/08/2015	ELIZABETH HELEN THOMPSON	RATES REFUND	352.67
EFT44713	27/08/2015	TREVOR DEAN & SHARON MARY HUDSON	RATES REFUND	843.20
EFT44714	27/08/2015	ROCCO & ANGELA TRIMBOLI	FOOTPATH DEPOSIT REFUND	1500.00
EFT44715	27/08/2015	BRIAN & GRAZINA KAY	RATES REFUND	684.81
EFT44716	27/08/2015	ALLAN MORTON	COUNCILLOR ALLOWANCE 01/08/15 - 31/08/15	2184.17
EFT44717	27/08/2015	ANNE MARGARET FERGUSON	2015 RATES INCENTIVE PRIZE WINNER	1000.00

Chq/EFT	Date	Name	Description	Amount
EFT44718	27/08/2015	STEPHEN LAROSE	2015 RATES INCENTIVE PRIZE WINNER	1000.00
EFT44719	27/08/2015	DIANA PAPPENFUS	SALE OF ARTWORK GATHERING EXHIBITION & HALL BOND REFUNDS	1623.00
EFT44720	27/08/2015	FREDERICK CORLETT	REFUND OF PLANNING APPLICATION FEE	240.04
EFT44721	27/08/2015	BENJAMIN THACKRAY	TRAVEL COMMUNITY VISITORS SCHEME REFUND & VOLUNTEER PETROL REIMBURSEMENT	166.00
EFT44722	27/08/2015	PHILLIP & PATRICIA SAUZIER	CROSSOVER CONTRIBUTION	400.00
EFT44723	27/08/2015	SPECTRUM ARTS	SALE OF ARTWORK GATHERING EXHIBITION	728.00
EFT44724	27/08/2015	GWYNFOR & ANDREA WILLIAMS	RATES REFUND	293.08
EFT44725	27/08/2015	NORMA HELENA GILBERT	RATES REFUND	693.59
EFT44726	27/08/2015	CHRISTINE & JOHN NEWTON	RATES REFUND	318.69
EFT44727	27/08/2015	ROMANUS CHUA	2015 RATES INCENTIVE PRIZE WINNER	1000.00
EFT44728	27/08/2015	CHRISTOPHER MARTIN ROSAGRO	CROSSOVER CONTRIBUTION	400.00
EFT44729	27/08/2015	SHERREE P DAVITT	INTERIM WEEKLY CLEANING FOR HIGH WYCOMBE CHILD HEALTH CLINIC	130.00
EFT44730	27/08/2015	DAVID JONES, PETER JONES AND BRONWYN JONES	FOOTPATH DEPOSIT REFUND	2100.00
EFT44731	27/08/2015	GEORGIA EFFORD	KEY BOND REFUND	50.00
EFT44732	27/08/2015	WA LOCAL GOVERNMENT SUPERANNUATION PLAN	SUPERANNUATION CONTRIBUTIONS	90701.07
EFT44733	27/08/2015	SHIRE OF KALAMUNDA STAFF SOCIAL CLUB	PAYROLL DEDUCTIONS	512.00
EFT44734	27/08/2015	CHILD SUPPORT AGENCY	PAYROLL DEDUCTIONS	604.31
EFT44735	27/08/2015	BUNNINGS BUILDING SUPPLIES	HARDWARE SUPPLIES FOR VARIOUS LOCATIONS	1432.50
EFT44736	27/08/2015	COVS PARTS PTY LTD	PLANT / VEHICLE PARTS	1255.59
EFT44737	27/08/2015	JASOL AUSTRALIA	CLEANING SUPPLIES	593.89
EFT44738	27/08/2015	WA LOCAL GOVERNMENT ASSOCIATION	REGISTRATION FOR 1 STAFF TO ATTEND SPEAK UP AND INFLUENCE PEOPLE	60.01
EFT44739	27/08/2015	LOCAL HEALTH AUTHORITIES ANALYTICAL COMMITTEE	FOOD SAMPLING ANNUAL FEES 2015 - 2016	14682.83

Chq/EFT	Date	Name	Description	Amount
EFT44740	27/08/2015	MCLEODS BARRISTERS & SOLICITORS	LEGAL EXPENSES	20062.97
EFT44741	27/08/2015	STATE LIBRARY OF W.A.	BETTER BEGINNINGS PACKS & LOST AND DAMAGED BOOKS	3634.40
EFT44742	27/08/2015	LANDGATE VALUATIONS	VALUATIONS FOR VARIOUS LOCATIONS	2370.52
EFT44743	27/08/2015	WALKERS HARDWARE (MITRE 10)	HARDWARE SUPPLIES	275.84
EFT44744	27/08/2015	ECHO NEWSPAPER	ADVERTISING FOR VARIOUS JOBS / EVENTS	2855.00
EFT44745	27/08/2015	MCKAY EARTHMOVING PTY LTD	PLANT EQUIPMENT AND OPERATOR HIRE FOR VARIOUS LOCATIONS & FOOTPATH DEPOSIT REFUND	20200.25
EFT44746	27/08/2015	ROCLA QUARRY PRODUCTS	GARDEN / RESERVE SUPPLIES	3425.53
EFT44747	27/08/2015	EASTERN METROPOLITAN REGIONAL COUNCIL	DOMESTIC / WASTE CHARGES RED HILL TIP	153826.80
EFT44748	27/08/2015	BORAL CONSTRUCTION MATERIALS GROUP	ROAD MATERIALS FOR VARIOUS LOCATIONS	994.63
EFT44749	27/08/2015	OFFICE LINE GROUP PTY LTD	OFFICE FURNITURE SUPPLIES	478.50
EFT44750	27/08/2015	3 VODAFONE HUTCHISON AUSTRALIA PTY LTD	COMMUNICATION EXPENSES FOR EMERGENCY SERVICES AUGUST 2015	1894.93
EFT44751	27/08/2015	STATEWIDE BEARINGS	PLANT / VEHICLE PARTS	183.68
EFT44752	27/08/2015	FASTA COURIERS	COURIER FEES	224.90
EFT44753	27/08/2015	THE WATERSHED WATER SYSTEMS	RETICULATION PARTS FOR VARIOUS RESERVES	778.85
EFT44754	27/08/2015	MCINTOSH & SON	PLANT / VEHICLE PARTS	580.25
EFT44755	27/08/2015	SONIC HEALTHPLUS (KINETIC HEALTH GROUP LTD)	PREPLACEMENT MEDICALS / BASELINE HEARING TESTS	866.80
EFT44756	27/08/2015	MAJOR MOTORS PTY LTD	PLANT / VEHICLE PARTS	619.58
EFT44757	27/08/2015	ALSCO LINEN SERVICE	LINEN HIRE / LAUNDRY SERVICES / SANITARY SERVICES AT VARIOUS LOCATIONS	585.77
EFT44758	27/08/2015	BRADOCK PODIATRY SERVICES PTY LTD	PODIATRY SERVICES AT JACK HEALEY CENTRE	1462.57
EFT44759	27/08/2015	DAYNITE TOWING SERVICE (WA) PTY LTD (FORMERLEY MOBITOW PTY LTD)	TOWING SERVICES	451.00
EFT44760	27/08/2015	KALA BOB KATS PTY LTD	PLANT EQUIPMENT AND OPERATOR HIRE FOR VARIOUS LOCATIONS	1929.40

Chq/EFT	Date	Name	Description	Amount
EFT44761	27/08/2015	ACTIMED AUSTRALIA PTY LTD	MEDICAL SUPPLIES FOR PODIARTIST	366.66
EFT44762	27/08/2015	STONETRADERS PTY LTD	GARDEN / RESERVE SUPPLIES	999.60
EFT44763	27/08/2015	GRONBEK SECURITY	SECURITY LOCKSMITH SERVICES TO VARIOUS LOCATIONS	95.84
EFT44764	27/08/2015	GRIMES CONTRACTING PTY LTD	CONTRACTOR BUILDING MAINTENANCE FOR VARIOUS BUILDINGS	7221.75
EFT44765	27/08/2015	BGC ASPHALT	ROAD MATERIALS FOR VARIOUS LOCATIONS	177.27
EFT44766	27/08/2015	WESTSIDE FIRE SERVICES	TESTING AND INSPECTION OF FIRE EQUIPMENT / SUPPLIES	337.51
EFT44767	27/08/2015	STAPLES AUSTRALIA PTY LTD (CORPORATE EXPRESS AUSTRALIA LTD)	STATIONERY / OFFICE SUPPLIES	3443.95
EFT44768	27/08/2015	BRICK CONCEPTS	CROSSOVER MAINTENANCE / REPAIRS FOR VARIOUS LOCATIONS	3300.00
EFT44769	27/08/2015	JOHN GIARDINA	COUNCILLOR ALLOWANCE 01/08/15 - 31/08/15	3471.67
EFT44770	27/08/2015	GEOFF STALLARD	COUNCILLOR ALLOWANCE 01/08/15 - 31/08/15	2184.17
EFT44771	27/08/2015	FOODWORKS FRESH FORRESTFIELD	GROCERY SUPPLIES	1125.79
EFT44772	27/08/2015	AUSTRALASIAN PERFORMING RIGHTS ASSOCIATION	LICENCE FEE FOR THE USE OF COPYRIGHT MUSIC	184.47
EFT44773	27/08/2015	IT VISION	ANNUAL LICENSE FEE, SYNERGYSOFT DATABASE AND USER LICENSE & ATTENDANCE OF 1 STAFF TO IT VISION NATIONAL CONFERENCE	89125.30
EFT44774	27/08/2015	BUCHER MUNICIPAL PTY LTD	PLANT / VEHICLE PARTS	2750.00
EFT44775	27/08/2015	LOGO APPOINTMENTS	HIRE OF TEMPORARY STAFF FOR DEPOT / ADMIN	4319.71
EFT44776	27/08/2015	BRIDGESTONE AUSTRALIA LTD	PLANT / VEHICLE PARTS	1529.10
EFT44777	27/08/2015	GREEN SKILLS (ECOJOBS)	LABOUR ASSISTANCE FOR WEEDING & RUBBISH COLLECTION AT MAIDA VALE RESERVE	896.50
EFT44778	27/08/2015	ONESTEEL DISTRIBUTION (MIDALIA STEEL)	PLANT / VEHICLE PARTS	342.41
EFT44779	27/08/2015	J BLACKWOOD & SON LIMITED	PROTECTIVE WEAR / SUPPLIES	2451.64
EFT44780	27/08/2015	AUSTRALIAN INSTITUTE OF MANAGEMENT	PROFESSIONAL PRESENTATIONS	6589.00
EFT44781	27/08/2015	EASTERN HILLS SAWS AND MOWERS	PLANT / VEHICLE PARTS	129.00

Chq/EFT	Date	Name	Description	Amount
EFT44782	27/08/2015	THE IT VISION USER GROUP	IT VISION USER GROUP SUBSCRIPTION 2015/2016	715.00
EFT44783	27/08/2015	DFES DIRECT BRIGADE ALARM MONITORING	ANNUAL MONITORING 2015/16 KPAC	1728.71
EFT44784	27/08/2015	LOVEGROVE TURF SERVICES	TURF MAINTENANCE / SERVICES AT HARTFIELD PARK	1870.00
EFT44785	27/08/2015	REPCO BRAKE & CLUTCH	PLANT / VEHICLE PARTS	991.01
EFT44786	27/08/2015	CRABBS KALAMUNDA (IGA)	GROCERY SUPPLIES	459.40
EFT44787	27/08/2015	1ST MAIDA VALE SCOUT GROUP	KIDSPORT FUNDING FOR 1 MEMBER	200.00
EFT44788	27/08/2015	KALAMUNDA DISTRICTS HOCKEY CLUB (INC)	KIDSPORT FUNDING FOR VARIOUS PLAYERS	260.00
EFT44789	27/08/2015	FORRESTFIELD FOOTBALL CLUB	KIDSPORT FUNDING FOR VARIOUS PLAYERS	885.00
EFT44790	27/08/2015	VENTURA HOMES PTY LTD	FOOTPATH DEPOSIT REFUNDS	3815.76
EFT44791	27/08/2015	DALE ALCOCK HOMES PTY LTD	PLANNING FEE REFUND	718.17
EFT44792	27/08/2015	MATTHEW GIBNEY CATHOLIC PRIMARY SCHOOL	HALL BOND REFUND	500.00
EFT44793	27/08/2015	HOME GROUP WA PTY LTD	FOOTPATH DEPOSIT REFUND	1500.00
EFT44794	27/08/2015	ASHMY PTY LTD	FOOTPATH DEPOSIT REFUND	3000.00
EFT44795	27/08/2015	PLUNKETT HOMES (1903) PTY LTD	FOOTPATH DEPOSIT REFUND & PLANNING APPLICATION FEE REFUND	1131.68
EFT44796	27/08/2015	ENVIRONMENTAL HEALTH AUSTRALIA (WA) INC	REGISTRATION FOR ENVIRONMENTAL HEALTH AUSTRALIA 69TH ANNUAL STATE CONFERENCE FOR VARIOUS STAFF	2325.00
EFT44797	27/08/2015	AUSTRALIAN LIBRARY AND INFORMATION ASSOCIATION	REGISTRATION FOR 1 STAFF TO PRESENT AT ALIA NATIONAL LIBRARY & INFORMATION ASSOCIATION TECHNICIANS SYMOSIUM	440.00
EFT44798	27/08/2015	JEFFREY ZATELLA	PLANNING FEE REFUND	50.00
EFT44799	27/08/2015	WA & J KING PTY LTD	GARDEN SUPPLIES FOR VARIOUS LOCATIONS	239.00
EFT44800	27/08/2015	COMMISSIONER OF POLICE	VOLUNTEER POLICE CHECKS	29.60
EFT44801	27/08/2015	TOTAL EDEN PTY LTD	RETICULATION PARTS AS REQUIRED	9235.45
EFT44802	27/08/2015	HIGH WYCOMBE JUNIOR FOOTBALL CLUB	KIDSPORT FUNDING FOR VARIOUS PLAYERS	800.00

Chq/EFT	Date	Name	Description	Amount
EFT44803	27/08/2015	KALAMUNDA & DISTRICTS BASKETBALL ASSOCIATION INC	KIDSPORT FUNDING FOR 1 PLAYER	220.00
EFT44804	27/08/2015	SIRENCO	REPAIRS / MAINTENANCR OF ELECTRONIC WARNING SYSTEMS	1226.50
EFT44805	27/08/2015	TOTAL PACKAGING (WA) PTY LTD	SUPPLY OF DOG LITTER BAGS	858.00
EFT44806	27/08/2015	AABEL LINE MARKING	LINE MARKING FOR VARIOUS LOCATIONS	5192.11
EFT44807	27/08/2015	CHILDRENS BOOK COUNCIL OF AUSTRALIA WA BRANCH	LIBRARY SUPPLIES	649.50
EFT44808	27/08/2015	ARCUS REFRIGERATION SERVICE PTY LTD	MAINTENANCE REPAIRS TO REFRIGERATION EQUIPMENT	2339.54
EFT44809	27/08/2015	WA HINO SALES & SERVICE	PLANT / VEHICLE PARTS	2555.58
EFT44810	27/08/2015	LOCAL GOVERNMENT MANAGERS AUSTRALIA (WA DIVISION)	REGISTRATION FOR VARIOUS STAFF MEMBERS TO ATTEND WINNING APPROACHES TO COMMUNITY DEVELOPMENT	110.00
EFT44811	27/08/2015	CHAMBER OF COMMERCE & INDUSTRY OF WA	CONSULTING SERVICES IN RELATION TO EMPLOYEE RELATION MATTERS	17017.00
EFT44812	27/08/2015	IAN JUSTIN WHITTEN	COUNCILLOR ALLOWANCE 01/08/15 - 31/08/15	2184.17
EFT44813	27/08/2015	THE FARM SHOP (WA) PTY LTD	GARDEN / RESERVE SUPPLIES	3069.00
EFT44814	27/08/2015	HILL TOP GROUP PTY	CONTRACTOR BUILDING MAINTENANCE FOR VARIOUS BUILDINGS	27176.22
EFT44815	27/08/2015	TRILOGY SERVICING PTY LTD	AIRCONDITIONING MAINTENANCE / REPAIRS FOR VARIOUS LOCATIONS	830.07
EFT44816	27/08/2015	QUICK CORPORATE AUST PTY LTD	STATIONERY & OFFICE SUPPLIES	4262.73
EFT44817	27/08/2015	AUTO ONE KALAMUNDA	PLANT / VEHICLE PARTS	87.20
EFT44818	27/08/2015	SUSAN BILICH	COUNCILLOR ALLOWANCE 01/08/15 - 31/08/15	7977.92
EFT44819	27/08/2015	COMMUNITY NEWSPAPER GROUP LTD	ADVERTISING FOR VARIOUS JOBS AND EVENTS	3084.43
EFT44820	27/08/2015	SHARON MCMANUS	2015 RATES INCENTIVE PRIZE WINNER	1000.00
EFT44821	27/08/2015	GLYN LOSPER	CROSSOVER CONTRIBUTIONS	400.00
EFT44822	27/08/2015	DUN & BRADSTREET (AUSTRALIA) PTY LTD	DEBT COLLECTION FEES FOR RATES AND DEBTORS	5.50

Chq/EFT	Date	Name	Description	Amount
EFT44823	27/08/2015	BANK OF I.D.E.A.S.	REGISTRATION FOR VARIOUS STAFF MEMBERS TO ATTEND MASTER CLASS IN ASSET BASED COMMUNITY DEVELOPMENT	660.00
EFT44824	27/08/2015	LOCK, STOCK & FARRELL LOCKSMITH PTY LTD	PADLOCKS / KEYS SUPPLIES	231.95
EFT44825	27/08/2015	MADDINGTON CONCRETE PRODUCTS PTY LTD	DRAINAGE SUPPLIES FOR VARIOUS LOCATIONS	2428.80
EFT44826	27/08/2015	THE ARCHIVE MANAGEMENT COMPANY	SUPPLY OF ARCHIVE BOXES	221.65
EFT44827	27/08/2015	SHIRE OF SERPENTINE JARRAHDALE	REPLACEMENT COST OF LOST BOOK FROM MUNDIJONG LIBRARY	8.80
EFT44828	27/08/2015	1ST GOOSEBERRY HILL SCOUT GROUP	KIDSPORT FUNDING FOR 1 MEMBER	400.00
EFT44829	27/08/2015	TONI GLAZEBROOK	FOOTPATH DEPOSIT REFUND	500.00
EFT44830	27/08/2015	THE FOREST CAFE	CATERING SUPPLIES - CEO BREAKFAST	300.00
EFT44831	27/08/2015	COCACOLA AMATIL (AUST) PTY LTD	KIOSK SUPPLIES FOR HARTFIELD RECREATION CENTRE	1007.37
EFT44832	27/08/2015	CONFECT EXPRESS	KIOSK SUPPLIES FOR HARTFIELD RECREATION CENTRE	303.53
EFT44833	27/08/2015	G FORCE PRINTING	SUPPLY OF PRINTED STATIONERY STOCK	628.21
EFT44834	27/08/2015	STAMP IT RUBBER STAMPS	OFFICE SUPPLIES	210.54
EFT44835	27/08/2015	SWAN TOWING SERVICE PTY LTD	TOWING SERVICES	231.00
EFT44836	27/08/2015	HYDROQUIP PUMPS	MAINTENANCE OF PUMPING INSTALLATIONS	352.00
EFT44837	27/08/2015	ABAXA (WH LOCATION SERVICES)	SUPPLY UNDERGROUND SERVICE LOCATIONS AT VARIOUS LOCATIONS	1789.70
EFT44838	27/08/2015	ELIZABETH MAREE HOBBS	LANDSCAPE CONFERENCE REGISTRATION MEMBERS FEE	599.00
EFT44839	27/08/2015	WEST AUSTRALIAN SHOWMEN'S ASSOC (INC)	BOND REFUND KALAMUNDA SHOW	1000.00
EFT44840	27/08/2015	PETER & CHERYL FOWLER	KEY BOND REFUND	50.00
EFT44841	27/08/2015	SPECIALISED SECURITY SHREDDING	SECURE DOCUMENT DISPOSAL BIN REMOVAL AND REPLACEMENT	33.00
EFT44842	27/08/2015	GEMMILL HOMES	FOOTPATH DEPOSIT REFUND	1500.00
EFT44843	27/08/2015	GREENWAY ENTERPRISES	GARDEN / RESERVE SUPPLIES	103.13

Chq/EFT	Date	Name	Description	Amount
EFT44844	27/08/2015	MARGARET THOMAS	COUNCILLOR ALLOWANCE 01/08/15 - 31/08/15	2184.17
EFT44845	27/08/2015	SEANNE DAVIS	TEMPORARY FOOD STALL FEE REFUND	73.00
EFT44846	27/08/2015	MAITLAND CONSULTING GROUP PTY LTD	TRAINING EVALUATION REPORT	677.60
EFT44847	27/08/2015	ANNALISE KERR	HALL & KEY BOND REFUND	750.00
EFT44848	27/08/2015	VERMEER (WA & NT)	PLANT / VEHICLE PARTS	175.43
EFT44849	27/08/2015	JULIE SMITH	KEY BOND REFUND	50.00
EFT44850	27/08/2015	BGC CEMENT BAGGED PRODUCTS	ROAD MATERIALS SUPPLIES	668.98
EFT44851	27/08/2015	INSIGHT CCS PTY LTD	AFTER HOURS ANSWERING SERVICES	2223.65
EFT44852	27/08/2015	NOREEN TOWNSEND	COUNCILLOR ALLOWANCE 01/08/15 - 31/08/15	2184.17
EFT44853	27/08/2015	WOOLWORTHS LIMITED	GROCERY SUPPLIES	263.45
EFT44854	27/08/2015	FORRESTFIELD TENNIS CLUB (INC)	FORRESTFIELD TENNIS CLUB HIRE FEES FROM HARTFIELD PARK RECREATION CENTRE 01/07/15 31/07/15	28.00
EFT44855	27/08/2015	FRANK LINDSEY	COUNCILLOR ALLOWANCE 01/08/15 - 31/08/15	2184.17
EFT44856	27/08/2015	HILLIANS NETBALL CLUB	KIDSPORT FUNDING FOR 1 MEMBER	150.00
EFT44857	27/08/2015	MATTHEW AND JODIE ALCOCK	FOOTPATH DEPOSIT REFUND	1500.00
EFT44858	27/08/2015	THOMAS NIIAKTON JACOBSON	REFUND OF BUILDING SERVICES LEVY	10.00
EFT44859	27/08/2015	MAIDA VALE DELIVERY ROUND	PAPER AND MAGAZINES DELIVERIES FOR HIGH WYCOMBE LIBRARY	51.60
EFT44860	27/08/2015	SIMON DI ROSSO	COUNCILLOR ALLOWANCE 01/08/15 - 31/08/15	2184.17
EFT44861	27/08/2015	GLENDA DAWN CHARLTON (PODIATRY)	PODIATRY SERVICES AT JACK HEALEY CENTRE	325.15
EFT44862	27/08/2015	KIM'S SKIM	PLANT / VEHICLE PARTS	154.00
EFT44863	27/08/2015	GENTRONICS	PLANT / VEHICLE PARTS	445.50
EFT44864	27/08/2015	CASTLEDINE & CASTLEDINE DESIGNERS	SALE OF ARTWORK - GATHERING EXHIBITION	1190.00
EFT44865	27/08/2015	YVONNE POWRIE	KEY BOND REFUND	50.00
EFT44866	27/08/2015	EASIFLEET MANAGEMENT	STAFF CONTRIBUTIONS TO NOVATED / OPERATING LEASES	8302.01
EFT44867	27/08/2015	HUMES	DRAINAGE SUPPLIES FOR VARIOUS LOCATIONS	4056.52

Chq/EFT	Date	Name	Description	Amount
EFT44868	27/08/2015	PREMIERE HOMES	PLANNING FEE REFUND	147.00
EFT44869	27/08/2015	TANIA MILOSEVIC	HALL BOND REFUND	200.00
EFT44870	27/08/2015	BOYA EQUIPMENT PTY LTD	PLANT / VEHICLE PARTS	676.13
EFT44871	27/08/2015	COLOUR WA PTY LTD	RATES REFUND	359.00
EFT44872	27/08/2015	PAUL BELL	FOOTPATH DEPOSIT REFUND	1500.00
EFT44873	27/08/2015	AUSTRALIAN SUPERANNUATION	SUPERANNUATION CONTRIBUTIONS	1979.68
EFT44874	27/08/2015	REST SUPERANNUATION	SUPERANNUATION CONTRIBUTIONS	2254.89
EFT44875	27/08/2015	REDINK HOMES PTY LTD	FOOTPATH DEPOSIT REFUND	3000.00
EFT44876	27/08/2015	PIRTEK WELSHPOOL	PLANT / VEHICLE PARTS	52.99
EFT44877	27/08/2015	MULTILEC ENGINEERING	QUARTERLY SERVICING & TESTING OF LIFTS	723.80
EFT44878	27/08/2015	AMP RETIREMENT SAVINGS ACCOUNT	SUPERANNUATION CONTRIBUTIONS	214.99
EFT44879	27/08/2015	CBUS SUPERANNUATION	SUPERANNUATION CONTRIBUTIONS	346.89
EFT44880	27/08/2015	HOLCIM AUSTRALIA PTY LTD	ROAD MATERIALS FOR VARIOUS LOCATIONS	2247.98
EFT44881	27/08/2015	ANDREW WADDELL	COUNCILLOR ALLOWANCE 01/08/15 - 31/08/15	2184.17
EFT44882	27/08/2015	LESMURDIE SAINTS JUNIOR FOOTBALL CLUB	KIDSPORT FUNDING FOR VARIOUS PLAYERS	390.00
EFT44883	27/08/2015	KALAMUNDA MEN'S SHED INC	SHIRE CONTRIBUTION FOR GREEN ARMY PROJECT	500.00
EFT44884	27/08/2015	PETER TUCATS SUPERANNUATION FUND	SUPERANNUATION CONTRIBUTIONS	933.53
EFT44885	27/08/2015	DRAINFLOW SERVICES PTY LTD	CLEANING / MAINTAINING STORM WATER DRAINS	7098.30
EFT44886	27/08/2015	FORESTVALE TREES PTY LTD	GARDEN / VERGE SUPPLIES	4169.00
EFT44887	27/08/2015	COGNET NOMINEES PTY LTD ACF MAP SUPER FUND	SUPERANNUATION CONTRIBUTIONS	98.92
EFT44888	27/08/2015	NEVERFAIL SPRINGWATER LTD (PETER ANDERTON CEN)	BOTTLED WATER SUPPLIES / MAINTENANCE	45.60
EFT44889	27/08/2015	AMP SUPER LEADER	SUPERANNUATION CONTRIBUTIONS	62.12
EFT44890	27/08/2015	CALLERS ASSOCIATION OF WESTERN AUSTRALIA (INC)	BOND REFUND	300.00
EFT44891	27/08/2015	NEVERFAIL SPRINGWATER LTD (ZZCC)	BOTTLED WATER SUPPLIES / MAINTENANCE	14.05

Chq/EFT	Date	Name	Description	Amount
EFT44892	27/08/2015	SWITCH HOMES FOR LIVING (PINDAN PROJECT HOMES)	FOOTPATH DEPOSIT REFUND	1000.00
EFT44893	27/08/2015	SREEKANTH THUNDATHIL GANGADHARAN	CROSSOVER CONTRIBUTION	400.00
EFT44894	27/08/2015	DYLAN O'CONNOR	COUNCILLOR ALLOWANCE 01/08/15 - 31/08/15	2184.17
EFT44895	27/08/2015	BOWDEN TREE CONSULTANCY	ARBORICULTURAL CONSULTANCY	396.00
EFT44896	27/08/2015	HOSTPLUS PTY LTD	SUPERANNUATION CONTRIBUTIONS	298.45
EFT44897	27/08/2015	PH CONCRETE (WA) PTY LTD	FOOTPATH MAINTENANCE / REPAIRS FOR VARIOUS LOCATIONS	17875.17
EFT44898	27/08/2015	GUNDRY'S CARPET CHOICE	SUPPLY AND INSTALL FLOOR COVERINGS AND TREATMENTS KALAMUNDA LIBRARY	290.00
EFT44899	27/08/2015	STATE WIDE TURF SERVICES	TURF SUPPLIES / MAINTENANCE FOR VARIOUS LOCATIONS	7950.80
EFT44900	27/08/2015	KALAMUNDA UNITED FOOTBALL CLUB	KIDSPORT FUNDING FOR VARIOUS PLAYERS	400.00
EFT44901	27/08/2015	KOTT GUNNING LAWYERS	LEGAL EXPENSES	5567.07
EFT44902	27/08/2015	ARMADILLO GROUP PTY LTD	PLANT / VEHICLE PARTS	2668.16
EFT44903	27/08/2015	BEAVER TREE SERVICES	TREE REMOVAL / PRUNING FOR VARIOUS LOCATIONS	1055.84
EFT44904	27/08/2015	DELL AUSTRALIA	COMPUTER SUPPLIES	173.58
EFT44905	27/08/2015	VISION SUPER PTY LTD	SUPERANNUATION CONTRIBUTIONS	797.92
EFT44906	27/08/2015	CENTURION TEMPORARY FENCING	TEMPORARY FENCING HIRE	2755.50
EFT44907	27/08/2015	POCKETPHONE COMMUNICATIONS	PLANT / VEHICLE PARTS	720.00
EFT44908	27/08/2015	ACCESS OFFICE INDUSTRIES	SHELVING - FORRESTFIELD LIBRARY	1192.40
EFT44909	27/08/2015	SHENAYE HUMMERSTON	SEED COLLECTION WITH GREEN ARMY IN JULY AND AUGUST	700.00
EFT44910	27/08/2015	PETER HAYES	REFUND OF LOCAL GOVERNMENT MANAGERS MEMBERSHIP FEES	505.00
EFT44911	27/08/2015	KENWICK AUTO ELECTRICS	INSURANCE EXCESS & PARTS FOR REPAIRS TO VMB SIGN TRAILER	1918.50
EFT44912	27/08/2015	FUJI XEROX AUSTRALIA PTY LTD	PHOTOCOPYING CHARGES	14220.59

Chq/EFT	Date	Name	Description	Amount
EFT44913	27/08/2015	PAUL DELLABONA & SARAH MORLEYPARKINSON	FOOTPATH DEPOSIT REFUND	1500.00
EFT44914	27/08/2015	EXTREME SUPERFOODS	KEY BOND REFUND	50.00
EFT44915	27/08/2015	CAPTIVATE GLOBAL (DIGITAL MARKETING ATC MPH UNIT TRUST)	ONLINE ON HOLD HALF YEARLY CHARGE	1313.40
EFT44916	27/08/2015	STRATEGEN ENVIRONMENTAL CONSULTANTS	CONSULTANCY FEES FOR WILKINS ROAD	896.50
EFT44917	27/08/2015	NATIONAL MEASUREMENT INSTITUTE	SAMPLE ANALYSIS JULY AND SEPTEMBER 2015	401.85
EFT44918	27/08/2015	HEMA MAPS PTY LTD	GREEN ARMY PROJECT AT VARIOUS LOCATIONS	
EFT44919	27/08/2015	HANDSON INFECTION CONTROL	MAP SUPPLIES FOR ZIG ZAG CULTURALS CENTRE	134.92
EFT44920	27/08/2015	KALAMUNDA ELECTRICS	HEPATITIS B STAFF VACCINATION	200.61
EFT44921	27/08/2015	ADDSTYLE CONSTRUCTIONS PTY LTD	ELECTRICAL REPAIRS / MAINTENANCE FOR VARIOUS LOCATIONS	6380.88
EFT44922	27/08/2015	BELMONT JUNIOR FOOTBALL CLUB	FOOTPATH DEPOSIT REFUND	1200.00
EFT44923	27/08/2015	MPJ (WA) PTY LTD	KIDSPORT FUNDING FOR VARIOUS PLAYERS	380.00
EFT44924	27/08/2015	ROCKWATER PTY LTD	SUPERANNUATION CONTRIBUTIONS	553.09
EFT44925	27/08/2015	HILLS DISTRICT CALISTHENICS CLUB	WATER MONITORING AND SAMPLING DURING THE	3536.25
EFT44926	27/08/2015	KCTT T/A KC TRAFFIC & TRANSPORT PTY LTD	AQUIFER STORAGE AND RECOVERY TRIAL AT HARTFIELD PARK	
EFT44927	27/08/2015	ART GUIDE AUSTRALIA	KIDSPORT FUNDING FOR 1 MEMBER	200.00
EFT44928	27/08/2015	SIMON & MARIE KING	FORRESTFIELD NORTH DSP INFRASTRUCTURE	980.10
EFT44929	27/08/2015	DMC CLEANING	SERVICING REPORT	
EFT44930	27/08/2015	CUROST MILK SUPPLY	12 MONTH SUBSCRIPTION RE EXHIBITION INFORMATION	715.00
EFT44931	27/08/2015	TENNILLE LOUISE OVERTON	PLANNING FEE REFUND	147.00
EFT44932	27/08/2015	ELAN ENERGY MANAGEMENT	CLEANING SERVICES FOR VARIOUS LOCATIONS	54969.29
EFT44933	27/08/2015	DFP RECRUITMENT SERVICES PTY LTD	MILK SUPPLY FOR ADMINISTRATION CENTRE AND DEPOT	125.90
			HALL & KEY BOND REFUND	350.00
			COLLECTION AND DISPOSAL OF TYRES	1766.83
			HIRE OF TEMPORARY STAFF	6208.70

Chq/EFT	Date	Name	Description	Amount
EFT44934	27/08/2015	DEMENTIA CARE AUSTRALIA	HALL BOND REFUND	300.00
EFT44935	27/08/2015	LESMURDIE WARRIORS NETBALL CLUB	KIDSPORT FUNDING FOR VARIOUS PLAYERS	600.00
EFT44936	27/08/2015	WATER CORPORATION SUPERANNUATION PLAN	SUPERANNUATION CONTRIBUTIONS	273.16
EFT44937	27/08/2015	MPK TREE SERVICES	TREE REMOVAL / BRANCH PRUNING AT VARIOUS LOCATIONS	5006.26
EFT44938	27/08/2015	TURFWORKS WA PTY LTD	RESERVE MOWING AT VARIOUS LOCATIONS	9253.46
EFT44939	27/08/2015	NEVERFAIL SPRINGWATER LTD (ADMIN OFFICE)	BOTTLED WATER SUPPLIES / MAINTENANCE	25.60
EFT44940	27/08/2015	STAN THE TYRE MAN (STAN'S TYRE SERVICE WA)	PLANT / VEHICLE PARTS	2293.50
EFT44941	27/08/2015	DATAKOM SYSTEMS (WA) PTY LTD	CHECK POINT MOBILE ACCESS AND 1 YEAR PREMIUM SUPPORT	2759.04
EFT44942	27/08/2015	TERRA SPEI PTY LTD	BUILDING APPLICATION REFUND	7265.16
EFT44943	27/08/2015	GOSNELLS POLICE & COMMUNITY YOUTH CENTRE (PCYC)	KIDSPORT FUNDING FOR 1 MEMBER	200.00
EFT44944	27/08/2015	BIN BOMB PTY LTD	SUPPLY AND DELIVERY OF BIN BOMB DEODORANT PELLETS	1853.50
EFT44945	27/08/2015	ALLEASING PTY LTD	FUJI XEROX PHOTOCOPIERS AND PRINTER LEASE CHARGES 01/10/15 31/12/15	20877.60
EFT44946	27/08/2015	TWU SUPERANNUATION FUND	SUPERANNUATION CONTRIBUTIONS	214.26
EFT44947	27/08/2015	QUEENS PARK JUNIOR FOOTBALL CLUB	KIDSPORT FUNDING FOR VARIOUS PLAYERS	400.00
EFT44948	27/08/2015	JOURNEY JOTTINGS	ASSORTED GOODS FOR RESALE AT PERTH HILLS VISITOR CENTRE	363.30
EFT44949	27/08/2015	PERTH WASTE PTY LTD	DOMESTIC / RECYCLING RUBBISH SERVICES & BIN CHARGES	130343.14
EFT44950	27/08/2015	FORT KNOX RECORDS MANAGEMENT	OFFSITE STORAGE WITH FORT KNOX	711.48
EFT44951	27/08/2015	CRAFT ARTS INTERNATIONAL	CRAFT ARTS INTERNATIONAL MAGAZINE FOR ZIG ZAG GALLERY	660.00
EFT44952	27/08/2015	AUSTRALIAN CATHOLIC SUPERANNUATION & RETIREMENT FUND (ACSRF)	SUPERANNUATION CONTRIBUTIONS	255.61

Chq/EFT	Date	Name	Description	Amount
EFT44953	27/08/2015	NEXT RESIDENTIAL PTY LTD	FOOTPATH DEPOSIT REFUND	1000.00
EFT44954	27/08/2015	RACHEL STEVENS	FOOTPATH DEPOSIT REFUND	1500.00
EFT44955	27/08/2015	LAWRENCE CHONG	CROSSOVER CONTRIBUTION	400.00
EFT44956	27/08/2015	KINETIC SUPERANNUATION LTD	SUPERANNUATION CONTRIBUTIONS	182.41
EFT44957	27/08/2015	DAYTONE PRINTING PTY LTD	PRINTING OF BROCHURES / INVITES FOR VARIOUS LOCATIONS	411.48
EFT44958	27/08/2015	DAVIDSON TRAHAIRE CORPSYCH	EMPLOYEE ASSITANCE PROGRAMME	1650.00
EFT44959	27/08/2015	19TH PERTH (GOSNELLS) GIRLS BRIGADE	KIDSPORT FUNDING FOR 1 MEMBER	200.00
EFT44960	27/08/2015	URBANECO GARDENS	HOME MAINTENANCE SERVICES	3000.00
EFT44961	27/08/2015	WML CONSULTANTS PTY LTD	SUPPLY DESIGN PLANS FOR VARIOUS PROJECTS	57361.65
EFT44962	27/08/2015	THUY THU HANG PHAM & TOAN THANG	FOOTPATH DEPOSIT REFUND	1500.00
EFT44963	27/08/2015	KOSMIC SOUND	ELECTRICAL SUPPLIES FOR KALAMUNDA PERFORMING ARTS CENTRE	4999.00
EFT44964	27/08/2015	BACD ENTERPRISE PTY LTD T/A IDEAL TECHNOLOGY GROUP	BUSINESS WEBSITE HOSTING PACKAGE FOR ZIG ZAG CULTURAL CENTRE	242.00
EFT44965	27/08/2015	PAULINE MANN	ASSORTED MERCHANDISE FOR ZIG ZAG CULTURAL CENTRE	194.00
EFT44966	27/08/2015	PROMOTIONAL EXPOSURE	COMEDY GOLD PERFORMANCE	2525.00
EFT44967	27/08/2015	AAA DEMOLITION & TREE SERVICES	FOOTPATH DEPOSIT REFUND	2100.00
EFT44968	27/08/2015	WOW GROUP (WA) PTY LTD (WOW HOMES)	FOOTPATH DEPOSIT REFUND	1500.00
EFT44969	27/08/2015	POWERWRAP MASTER PLAN	SUPERANNUATION CONTRIBUTIONS	286.12
EFT44970	27/08/2015	2TONE MOTOR TRIMMING	PLANT/VEHICLE PARTS	308.00
EFT44971	27/08/2015	MANDALAY TECHNOLOGIES PTY LTD	ADMINISTRATION TRAINING REQUIREMENTS	1760.00
EFT44972	27/08/2015	NORTH PERSONAL SUPERANNUATION	SUPERANNUATION CONTRIBUTIONS	165.35
EFT44973	27/08/2015	PHOENIX NETBALL CLUB INC	KIDSPORT FUNDING FOR VARIOUS PLAYERS	1000.00
EFT44974	27/08/2015	PERTH PATIO MAGIC	PLANNING FEE REFUND	147.00
EFT44975	27/08/2015	ATLETICO LATINOS FOOTBALL CLUB	KIDSPORT FUNDING FOR VARIOUS PLAYERS	600.00
EFT44976	27/08/2015	INDIAN OCEAN LANDSCAPES	LANDSCAPE VERGE TIDY UP AND PLANTING	4492.84

Chq/EFT	Date	Name	Description	Amount
EFT44977	27/08/2015	GRANOTEK CONTRACTING	CONSTRUCTION OF FORRESTFIELD SKATE PARK	39050.00
EFT44978	27/08/2015	BWMT SUPERANNUATION FUND	SUPERANNUATION CONTRIBUTIONS	168.30
EFT44979	27/08/2015	DEPARTMENT OF FISHERIES	WORKS TO ERRADICATION OF PEST CATFISH FROM NIMBIN ROAD DAM	9333.50
EFT44980	27/08/2015	DRUG SAFE AUSTRALIA PTY LTD T/A FRONTLINE DIAGNOSTICS	RANDOM ONSITE DRUG AND ALCOHOL TESTING	2101.00
EFT44981	27/08/2015	MURAL CREATIONS	PART PAYMENT FOR HARTFIELD PARK RECREATION CENTRE RPM ROOM MURAL	1000.00
EFT44982	27/08/2015	CANNING SOUTH PERTH FOOTBALL CLUB	KIDSPORT FUNDING FOR 1 PLAYER	200.00
EFT44983	27/08/2015	TELSTRA SNP MONITORING PTY LTD	SECURITY MONITORING AND REPAIR SERVICES	808.50
EFT44984	27/08/2015	DOMAIN FORCE SHADE SAILS	SUPPLY AND DELIVERY OF SHADE SAILS AT KOSTERA OVAL	4389.00
EFT44985	27/08/2015	OLD AQUINIANS HOCKEY CLUB	KIDSPORT FUNDING FOR 1 MEMBER	200.00
EFT44986	27/08/2015	ZINFINITY PROJECTS PTY LTD	FOOTPATH DEPOSIT REFUND	2000.00
EFT44987	27/08/2015	ALI MCGREGOR	DEPOSIT FOR ALCHEMY PERFORMANCE	2000.00
EFT44988	27/08/2015	CATHERINE WADE	HALL & KEY BOND REFUND	350.00
EFT44989	27/08/2015	ROBERT PAGE	HALL & KEY BOND REFUND	350.00
68905	29/07/2015	HOSPITAL BENEFIT FUND OF WA	PAYROLL DEDUCTIONS	361.65
68906	29/07/2015	AUSTRALIAN SERVICES UNION	PAYROLL DEDUCTIONS	154.80
68907	29/07/2015	MUNICIPAL EMPLOYEES UNION	PAYROLL DEDUCTIONS	635.50
68908	29/07/2015	TELSTRA CORPORATION	TELEPHONE EXPENSES	1438.47
68909	29/07/2015	WATER CORPORATION	WATER USE AND SERVICE CHARGE FEES	8479.03
68910	29/07/2015	SYNERGY	POWER CHARGES	25.30
68911	29/07/2015	ALINTA ENERGY	GAS CHARGES	23.25
68912	29/07/2015	DIRECTOR OF LICENSING SERVICES	LOCAL AUTHORITY SERIES NUMBER PLATES	200.00
68913	29/07/2015	CASH KALAMUNDA LIBRARY	PETTY CASH REIMBURSEMENT	133.30
68914	29/07/2015	CASH HARTFIELD PARK	PETTY CASH REIMBURSEMENT	220.85
68915	29/07/2015	COLONIAL 1ST STATE SUPERANNUATION	SUPERANNUATION CONTRIBUTIONS	911.75

Chq/EFT	Date	Name	Description	Amount
68916	29/07/2015	HESTA SUPER FUND	SUPERANNUATION CONTRIBUTIONS	1082.38
68917	29/07/2015	AMPLIFE LIMITED	SUPERANNUATION CONTRIBUTIONS	354.21
68918	29/07/2015	MLC MASTERKEY SUPER GOLD STAR VERSION ACCOUNT	SUPERANNUATION CONTRIBUTIONS	199.86
68919	29/07/2015	CASH MEALS ON WHEELS	PETTY CASH REIMBURSEMENT	443.15
68920	29/07/2015	CASH KALAMUNDA HACC	PETTY CASH REIMBURSEMENT	620.65
68921	29/07/2015	ANZ SUPER ADVANTAGE	SUPERANNUATION CONTRIBUTIONS	216.39
68922	29/07/2015	CASH HIGH WYCOMBE LIBRARY	PETTY CASH REIMBURSEMENT	133.59
68923	29/07/2015	ING INTEGRA PERSONAL SUPER	SUPERANNUATION CONTRIBUTIONS	161.52
68924	29/07/2015	MACQUARIE WRAP	SUPERANNUATION CONTRIBUTIONS	656.42
68925	29/07/2015	ONEPATH MASTERFUND	SUPERANNUATION CONTRIBUTIONS	421.32
68926	29/07/2015	BT SUPER FOR LIFE	SUPERANNUATION CONTRIBUTIONS	251.25
68927	29/07/2015	ASGARD & WRAP ALLOCATED PENSION	SUPERANNUATION CONTRIBUTIONS	142.54
68928	29/07/2015	BENDIGO SMART START PERSONAL SUPER	SUPERANNUATION CONTRIBUTIONS	267.55
68929	29/07/2015	ANZ SMART CHOICE SUPER	SUPERANNUATION CONTRIBUTIONS	240.45
68930	29/07/2015	IOOF PORTFOLIO SERVICE PERSONAL SUPERANNUATION	SUPERANNUATION CONTRIBUTIONS	102.60
68931	12/08/2015	HOSPITAL BENEFIT FUND OF WA	PAYROLL DEDUCTIONS	361.65
68932	12/08/2015	AUSTRALIAN SERVICES UNION	PAYROLL DEDUCTIONS	284.83
68933	12/08/2015	MUNICIPAL EMPLOYEES UNION	PAYROLL DEDUCTIONS	676.50
68934	12/08/2015	MEAD MEDICAL GROUP	HEALTH CHECK AFTER EXPOSURE TO CHEMICAL SPILL FOR 7 STAFF MEMBERS	458.00
68935	12/08/2015	TELSTRA CORPORATION	TELEPHONE EXPENSES	88135.25
68936	12/08/2015	WATER CORPORATION	WATER USE AND SERVICE CHARGE FEES	4726.64
68937	12/08/2015	BCITF	LEVY FEE - JULY 2015	29306.60
68938	12/08/2015	SYNERGY	POWER CHARGES	146179.80
68939	12/08/2015	ALINTA ENERGY	GAS CHARGES	5943.10
68940	12/08/2015	DIRECTOR OF LICENSING SERVICES	LOCAL AUTHORITY SERIES NUMBER PLATES	600.00

Chq/EFT	Date	Name	Description	Amount
68941	12/08/2015	BUILDING COMMISSION	BUILDING LEVY - JULY 2015	21233.43
68942	12/08/2015	CASH ADMIN	PETTY CASH REIMBURSEMENT	654.15
68943	12/08/2015	CASH FORRESTFIELD LIBRARY	PETTY CASH REIMBURSEMENT	51.45
68944	12/08/2015	COLONIAL 1ST STATE SUPERANNUATION	SUPERANNUATION CONTRIBUTIONS	869.37
68945	12/08/2015	HESTA SUPER FUND	SUPERANNUATION CONTRIBUTIONS	1123.56
68946	12/08/2015	AMPLIFE LIMITED	SUPERANNUATION CONTRIBUTIONS	360.57
68947	12/08/2015	MLC MASTERKEY SUPER GOLD STAR VERSION ACCOUNT	SUPERANNUATION CONTRIBUTIONS	199.86
68948	12/08/2015	CASH MEALS ON WHEELS	PETTY CASH REIMBURSEMENT	473.60
68949	12/08/2015	CASH KALAMUNDA HACC	PETTY CASH REIMBURSEMENT	35.25
68950	12/08/2015	ANZ SUPER ADVANTAGE	SUPERANNUATION CONTRIBUTIONS	216.39
68951	12/08/2015	ING INTEGRA PERSONAL SUPER	SUPERANNUATION CONTRIBUTIONS	53.01
68952	12/08/2015	CASH ZIG ZAG CULTURAL CENTRE	PETTY CASH REIMBURSEMENT	34.30
68953	12/08/2015	CASH KPAC	PETTY CASH REIMBURSEMENT	99.35
68954	12/08/2015	MACQUARIE WRAP	SUPERANNUATION CONTRIBUTIONS	656.42
68955	12/08/2015	ONEPATH MASTERFUND	SUPERANNUATION CONTRIBUTIONS	421.32
68956	12/08/2015	BT SUPER FOR LIFE	SUPERANNUATION CONTRIBUTIONS	251.25
68957	12/08/2015	ASGARD & WRAP ALLOCATED PENSION	SUPERANNUATION CONTRIBUTIONS	120.90
68958	12/08/2015	BENDIGO SMART START PERSONAL SUPER	SUPERANNUATION CONTRIBUTIONS	267.55
68959	12/08/2015	ANZ SMART CHOICE SUPER	SUPERANNUATION CONTRIBUTIONS	240.45
68960	12/08/2015	IOOF PORTFOLIO SERVICE PERSONAL SUPERANNUATION	SUPERANNUATION CONTRIBUTIONS	138.35
68961	26/08/2015	HOSPITAL BENEFIT FUND OF WA	PAYROLL DEDUCTIONS	361.65
68962	26/08/2015	AUSTRALIAN SERVICES UNION	PAYROLL DEDUCTIONS	414.85
68963	26/08/2015	MUNICIPAL EMPLOYEES UNION	PAYROLL DEDUCTIONS	697.00
68964	26/08/2015	TELSTRA CORPORATION	TELEPHONE EXPENSES	260.70
68965	26/08/2015	WATER CORPORATION	WATER USE AND SERVICE CHARGE FEES	233.67
68966	26/08/2015	SYNERGY	POWER CHARGES	28267.90

Chq/EFT	Date	Name	Description	Amount
68967	26/08/2015	ALINTA ENERGY	GAS CHARGES	27.55
68968	26/08/2015	DIRECTOR OF LICENSING SERVICES	LOCAL AUTHORITY SERIES NUMBER PLATES	200.00
68969	26/08/2015	FINES ENFORCEMENT REGISTRY	FINES ENFORCEMENT REGISTRY	1456.00
68970	26/08/2015	CASH KALAMUNDA LIBRARY	PETTY CASH REIMBURSEMENT	224.13
68971	26/08/2015	CASH HARTFIELD PARK	PETTY CASH REIMBURSEMENT	208.30
68972	26/08/2015	COLONIAL 1ST STATE SUPERANNUATION	SUPERANNUATION CONTRIBUTIONS	873.38
68973	26/08/2015	HESTA SUPER FUND	SUPERANNUATION CONTRIBUTIONS	1115.73
68974	26/08/2015	AMPLIFE LIMITED	SUPERANNUATION CONTRIBUTIONS	344.32
68975	26/08/2015	MLC MASTERKEY SUPER GOLD STAR VERSION ACCOUNT	SUPERANNUATION CONTRIBUTIONS	199.86
68976	26/08/2015	CASH MEALS ON WHEELS	PETTY CASH REIMBURSEMENT	330.45
68977	26/08/2015	CASH KALAMUNDA HACC	PETTY CASH REIMBURSEMENT	228.20
68978	26/08/2015	ANZ SUPER ADVANTAGE	SUPERANNUATION CONTRIBUTIONS	205.00
68979	26/08/2015	CASH HIGH WYCOMBE LIBRARY	PETTY CASH REIMBURSEMENT	114.81
68980	26/08/2015	ING INTEGRA PERSONAL SUPER	SUPERANNUATION CONTRIBUTIONS	129.21
68981	26/08/2015	UNISUPER	SUPERANNUATION CONTRIBUTIONS	56.20
68982	26/08/2015	MACQUARIE WRAP	SUPERANNUATION CONTRIBUTIONS	656.42
68983	26/08/2015	ONEPATH MASTERFUND	SUPERANNUATION CONTRIBUTIONS	421.32
68984	26/08/2015	BT SUPER FOR LIFE	SUPERANNUATION CONTRIBUTIONS	251.25
68985	26/08/2015	BEN TRAGER HOMES	FOOTPATH DEPOSIT REFUND	1500.00
68986	26/08/2015	ASGARD & WRAP ALLOCATED PENSION	SUPERANNUATION CONTRIBUTIONS	128.80
68987	26/08/2015	BENDIGO SMART START PERSONAL SUPER	SUPERANNUATION CONTRIBUTIONS	267.55
68988	26/08/2015	ANZ SMART CHOICE SUPER	SUPERANNUATION CONTRIBUTIONS	240.45
68989	26/08/2015	IOOF PORTFOLIO SERVICE PERSONAL SUPERANNUATION	SUPERANNUATION CONTRIBUTIONS	150.79

3213085.97

Payroll Payments

Chq/EFT	Date	Name	Description	Amount
F508122627129	11/08/2015	SHIRE OF KALAMUNDA PAYROLL	FOR THE PERIOD TO 11 AUGUST 2015 VARIOUS AWARDS	553814.82
F508263252962	25/08/2015	SHIRE OF KALAMUNDA PAYROLL	FOR THE PERIOD TO 25 AUGUST 2015 VARIOUS AWARDS	558053.45
				1111868.27

Attachment 2

**SHIRE OF KALAMUNDA
 SUMMARY OF DEBTORS
 FOR THE PERIOD ENDED 31 AUGUST 2015**

Sundry Debtors Trial Balance (excluding trust balances) - Summary Aged Listing

	> 90 days	> 60 days	> 30 days	Current	Total
September 14	\$572,315	\$10,832	\$33,781	\$18,257	\$635,185
October 14	\$567,963	\$15,753	\$5,483	\$102,266	\$691,466
November 14	\$571,997	\$3,680	\$36,713	\$371,070	\$983,459
December 14	\$565,418	\$21,805	\$18,617	\$80,765	\$686,604
January 15	\$25,805	\$11,841	\$45,278	\$2,938,970	\$3,021,893
February 15	\$17,884	\$38,295	\$29,893	\$332,021	\$418,092
March 15	\$42,362	\$6,134	\$34,711	\$69,419	\$152,626
April 15	\$39,128	\$2,100	\$14,226	\$84,112	\$139,566
May 15	\$32,601	\$10,401	\$21,704	\$103,860	\$168,565
June 15	\$12,559	\$6,161	\$17,913	\$173,414	\$210,047
July 15	\$8,043	\$9,817	\$65,469	\$77,801	\$161,131
August 15	\$14,332	\$19,206	\$29,134	\$140,189	\$202,861

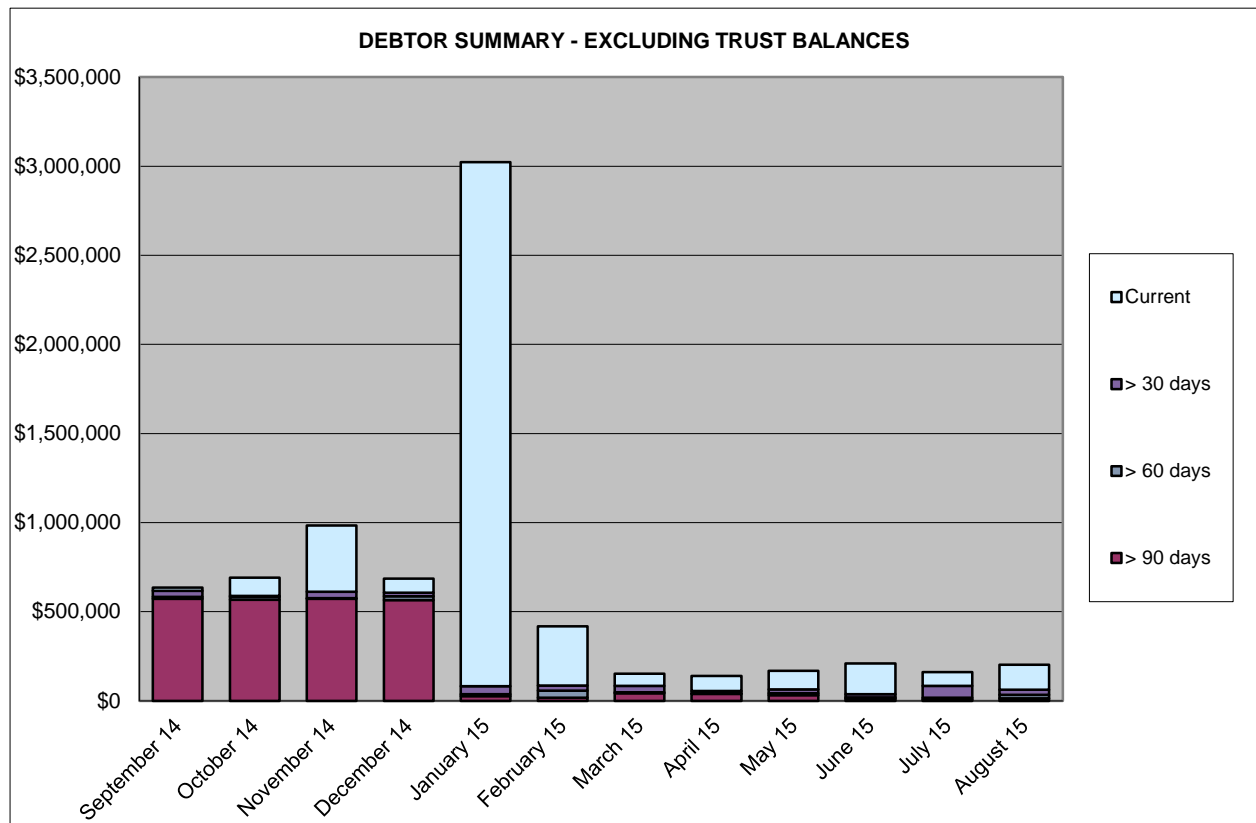

SHIRE OF KALAMUNDA			
SUMMARY OF DEBTORS – FOR THE PERIOD ENDED 31 AUGUST 2015			
AMOUNT	DEBTOR	DETAILS	STATUS
> 90 days			
\$2,695.88	Kalamunda & Canning Rugby League Club	Operating Expenses	Holding discussions with Community Development regarding finances
\$3,388.07	Forrestfield United	Loan 214	Direct Debit Payment
\$2,730.71	Kalamunda Cricket Club	Loan / Operating Expenses	Advised payment to be made in August - to contact Club
\$2,655.31	Zig Zag Café ^	Lease / Operating Expenses	Direct Debit Payment
\$2,862.41	90+ Days Debts consisting of amounts under \$1,000.00.		Debtors to be contacted to advise debt recovery action pending / final notices issued / debt with D&B or possible write-off of debt pending.
\$14,332.38	Total Debts 90+ Days	Excluding Trust Balances	
> 60 days			
\$1,203.00	Better Health Company	Hall Hire	Paid 01/09
\$1,137.50	Born to Sing	Hall Hire	Debtor advised payment pending
\$1,680.00	Early Bird Learning	Hall Hire	To contact
\$1,243.00	Fayyaz Ahmad Raja	Health Services	To contact
\$1,148.13	Plume Estate	Private Works	To contact
\$5,102.06	Zig Zag Café	Lease / Operating Expenses	Direct Debit Payment
\$7,692.00	60+ Days Debts consisting of amounts under \$1,000.00		All debtors to be contacted by telephone / email - copy invoices mailed as required.
\$19,205.69	Total Debts 60+ Days		
> 30 days			
\$1,067.00	Haynes Street Larder	Health Services	Reminder Invoice to be mailed
\$1,067.00	JJ's Sweet Bliss	Health Services	Reminder Invoice to be mailed
\$1,661.55	MKP Management PTY	Cash in Lieu - Planning Expense	Reminder Invoice to be mailed
\$1,067.00	The Icecream Man	Health Services	Reminder Invoice to be mailed
\$2,291.67	Zig Zag Gymnastics	Hall Hire	Invoiced in advance

\$21,979.66	30+ Days Debts consisting of amounts under \$1,000.00.		Reminder invoices to be sent.
\$29,133.88	Total Debts 30+ Days	Excluding Trust Balances	
< 30 days			
\$145,848.24	Total of Current Debts		
\$5,659.50	Total of Accounts in Credit		
\$202,860.69	Total - Debtors Trial Balance	Excluding Trust Balances	
FOOTNOTES			
* Denotes currently in negotiation of invoice amount and details			
^ Denotes payment arrangement in place			

Attachment 3

**SHIRE OF KALAMUNDA
 SUMMARY OF CREDITORS
 FOR THE PERIOD ENDED 31 AUGUST 2015**

Sundry Creditors Trial Balance - Summary Aged Listing

Month End	> 90 days	> 60 days	> 30 days	Current	Total
31/07/2014	\$9,347	\$1,978	\$27,392	\$449,082	\$487,799
31/08/2014	\$1,000	\$208,043	\$15,978	\$601,439	\$826,460
30/09/2014	\$11,865	\$62,484	\$62,683	\$908,456	\$1,045,488
31/10/2014	\$2,955	\$3,399	\$76,354	\$1,209,519	\$1,292,227
30/11/2014	\$6,311	\$15,497	\$89,340	\$1,137,344	\$1,248,492
31/12/2014	\$16,026	\$3,890	\$42,960	\$837,074	\$899,950
31/01/2015	\$5,137	\$407,117	\$4,182	\$292,502	\$708,938
28/02/2015	\$0	\$0	\$81,137	\$511,560	\$592,697
31/03/2015	\$13,318	\$1,430	\$17,916	\$406,194	\$438,858
30/04/2015	\$3,023	\$8,397	\$182,562	\$526,209	\$720,191
31/05/2015	\$11,955	\$13,047	\$34,358	\$1,538,190	\$1,597,551
30/06/2015	\$6,259	\$16,998	\$91,434	\$3,391,506	\$3,506,197
31/07/2015	\$1,100	\$2,200	\$81,330	\$570,084	\$654,714
31/08/2015	\$3,787	\$7,093	\$297,295	\$2,823,505	\$3,131,680

Comment

- > 90 days Original Invoices for Coolbinia Bombers Junior Football Club, St Brigids College, Modern Home Improvers & Aveling Homes not received in Accounts to process.
- > 60 days Original Invoices for Maddington Junior Football Club, D S Agencies Pty Ltd, Marketforce Pty Ltd & Plunket Homes not received in Accounts to process.
- > 30 days These invoices are paid on the third fortnightly payment run.

Creditor Payments made

Month	Amount \$	Quantity		
		Cheques	EFTs	Total
Jul-14	\$ 3,439,392	70	511	581
Aug-14	\$ 3,890,438	101	630	731
Sep-14	\$ 4,467,596	70	536	606
Oct-14	\$ 4,009,379	77	535	612
Nov-14	\$ 3,259,838	81	539	620
Dec-14	\$ 3,255,778	83	526	609
Jan-15	\$ 4,323,371	118	530	648
Feb-15	\$ 3,335,267	83	479	562
Mar-15	\$ 5,324,488	87	510	597
Apr-15	\$ 2,454,269	77	546	523
May-15	\$ 3,263,699	63	524	587
Jun-15	\$ 3,661,757	67	584	651
Jul-15	\$ 4,574,236	60	545	605
Aug-15	\$ 3,213,086	85	659	744

*Excludes net staff payroll

*Creditors on 30 day terms are paid on the 28th of the month following.

*Local suppliers are paid on 14 day terms.

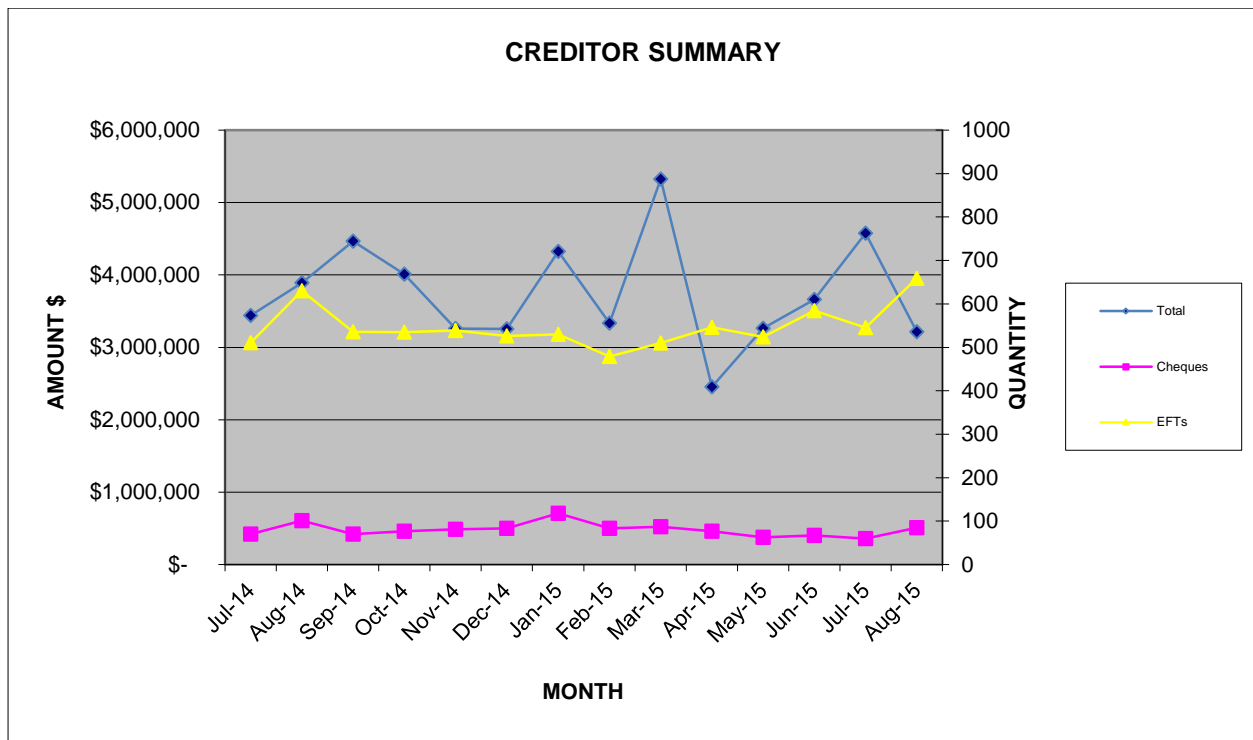

Declaration of financial / conflict of interests to be recorded prior to dealing with each item.

34. Rates Debtors Report for the Period Ended 31 August 2015

Previous Items N/A
 Responsible Officer Director Corporate Services
 Service Area Finance
 File Reference FI-DRS-004
 Applicant N/A
 Owner N/A

Attachment 1 Summary of Outstanding Rates for the period ended 31 August 2015

PURPOSE

1. To receive the report on rates debtors for the period ended 31 August 2015 (Attachment 1).

BACKGROUND

2. Rates notices were issued on 13 July 2015 with the following payment options:-

Options	Payment Dates			
Full Payment	17 August 2015			
Two Instalments	17 August 2015	10 December 2015		
Four Instalments	17 August 2015	12 October 2015	10 December 2015	08 February 2016

3. Rates Levied for the 2015/2016 Financial Year totalled \$31,884,691. Of this amount, approximately \$16.2m has been collected as at 31 August 2015. A total of 22,834 rate notices were sent on 13 July 2015. The rates department launched three additional services to better assist ratepayers in paying their amounts due. These are:
 - "A smarter way to pay" – allows the ratepayer to pay in small instalments over a 12 month period via direct debit. The model calculates a figure which ensures that the ratepayer will be in credit for the following year's rates. To date 346 ratepayers have signed up for the various direct debit option on offer of which 231 have elected the smarter way to pay.
 - "eRates" – allows the ratepayer to receive their future rates notices by email instead of the post. This will improve efficiency, is traceable and the ratepayer can be anywhere in the world and still receive their rates notice. It will also save the Shire >\$1 for every notice sent via email and not the post. To promote this service, one of the rates prizes traditionally offered was converted to purchasing apple and android tablets to obtain a better outcome. To date 996 properties have registered for electronic delivery. As Australia Post is set to increase postal charges by 40% from current rates, the more mail the Shire can send electronically will reduce our postal outgoings. The Shire has already recovered its set up fees and will be cash positive going forward.¹

-
- "Bpay View" – Allows the ratepayer to link the rates notice to their banking institution. This is an additional service that has been provided at no cost to the Shire by Commonwealth Bank of Australia (CBA). To date 119 people have signed up.
4. A total of 8,934 ratepayers have taken up an instalment option so far. Of these, 1,583 have taken up the option to pay by two instalments and 7,351 to pay by four instalments. A total of 12,457 ratepayers have paid in full. The due date for taking up the instalment options was 17 August 2015.
 5. As noted on (Attachment 1), the Shire has collected \$16,233,863, or 50.37% of the debt from the date the rates and service charges were raised, compared to 50.17% at the same period last year.
 6. The raising of Interim Rates for the 2015/2016 financial year will commence after the first instalment close date of 27 August 2015.

DETAILS

Debt Recovery

7.
 - From 2012/2013 to 2013/2014 there are now nine claims outstanding with five claims waiting for a Property Seizure and Sales Order (PSSO) Land. These five properties have had rates outstanding for three years and over and all legal attempts to collect the rates has been unsuccessful. A briefing session was provided to Council on 25 May 2015. These five properties are now being passed on to the Shire's legal representatives for processing.
 - The Shire has issued 246 General Procedure Claims through the Courts for 2014/15 rates and service charges outstanding. Of these 246, the Shire has an active default judgement on 32 properties of which two are being defended. A total of 214 of these matters have been closed due to payment being received.
 - Of the 37 properties where the Shire has default judgement active, a total of 27 properties have had a Property Seizure and Sales Order (PSSO) Goods, issued or are awaiting issue through the Courts.
 - Debt recovery for 2015/16 commenced on 11 September 2015. Final Notices were sent to all properties with an outstanding balance of more than \$50.

STATUTORY AND LEGAL CONSIDERATIONS

8. The Shire collects its rates debts in accordance with the *Local Government Act (1995) Division 6 – Rates and Service Charges under the requirements of subdivision 5 – Recovery of unpaid rates and service charges.*

POLICY CONSIDERATIONS

9. Nil.

COMMUNITY ENGAGEMENT REQUIREMENTS

10. Nil.

FINANCIAL CONSIDERATIONS

11. The early raising of rates in July has allowed the Shire's operations to commence without delays in addition to earning additional interest income.

STRATEGIC COMMUNITY PLAN

Strategic Planning Alignment

12. *Kalamunda Advancing: Strategic Community Plan to 2023*

OBJECTIVE 6.8 – To ensure financial sustainability through the implementation of effective financial management, systems and plans.

Strategy 6.8.4 Provide effective financial services to support the Shire's operations and to meet sustainability planning, reporting and accountability requirements.

SUSTAINABILITY

Social Implications

13. Debt collection can have implications upon those ratepayers facing hardship and the Shire must ensure equity in its debt collection processes.

Economic Implications

14. Effective collection of all outstanding debtors leads to enhanced financial sustainability for the Shire.

Environmental Implications

15. Nil.

RISK MANAGEMENT CONSIDERATIONS

- 16.
- | Risk | Likelihood | Consequence | Rating | Action/Strategy |
|---|------------|-------------|--------|--|
| Ratepayers defaulting on payment obligation resulting in the disruption of cash flows and increase of collection costs. | Possible | Major | High | Ensure debt collections is rigorously managed. |

OFFICER COMMENT

17. The Shire's debt collection strategy has proven to be very effective with a 98.70% collection rate in the 2014/2015 financial year. With the additional services launched, it is envisaged that a similar collection rate will be achieved again for 2015/2016 financial year.

Voting Requirements: Simple Majority

OFFICER RECOMMENDATION (C&C 34/2015)

That Council:

1. Receives the rates debtors report for the period ended 31 August 2015 (Attachment 1).

Moved:

Seconded:

Vote:

Attachment 1

**SHIRE OF KALAMUNDA
 SUMMARY OF OUTSTANDING RATES
 FOR THE PERIOD ENDED 31 AUGUST 2015**

Rates Outstanding Debtors

	3rd Previous Year + Outstanding	2nd Previous Year Outstanding	Previous Year Outstanding	Current Outstanding	Total Outstanding	Previous Year Total Outstanding
30-Jun-15	Balance Forward				\$856,619	\$869,771
30-Jul-15	\$374,611	\$125,242	\$303,167	\$27,284,384	\$28,087,404	\$26,049,358
31-Aug-15	\$367,738	\$123,002	\$244,670	\$15,772,037	\$16,507,447	\$15,674,989

Rates Outstanding as at 30/06/2015 \$856,619

Rate Levied 2015/2016 \$31,884,691
 Interim 2015/2016 \$0
 Back Rates \$0

Total Levies To Date for 2015/2016 \$31,884,691

Total Collectable \$32,741,310

Total Collected to date \$16,233,863

Total Rates Outstanding \$16,507,447

Current Deferred Rates Amount (from Rate Reports) \$514,420

Total Rates amount to be collected not including deferred \$15,993,027

% of Rates Outstanding: 49.63%

% of Rates Collected: 50.37%

Comment

[The 2014/2015 Instalment Dates are as follows:](#)

	4 x instalments	2 x instalments
1st Instalment	17/08/2015	17/08/2015
2nd Instalment	12/10/2015	10/12/2015
3rd Instalment	10/12/2015	
4th Instalment	08/02/2016	

Declaration of financial / conflict of interests to be recorded prior to dealing with each item.

35. Community Care Quarterly Report – June 2015

Previous Items	N/A
Responsible Officer	Director Corporate Services
Service Area	Community Care
File Reference	CO-SPC-022
Applicant	N/A
Owner	N/A
Attachment 1	Volumes Report – Monthly Hours Worked by Category
Attachment 2	Community Care Financials
Attachment 3	Meals on Wheels Financials

PURPOSE

1. To endorse the Community Care Quarterly Report – June 2015.

BACKGROUND

2. The quarterly report is prepared in accordance with Kalamunda Achieving: Corporate Business Plan 2015-2018. The basis of which is *“Produce a quarterly progress report for Community Care services”*.

DETAILS

3. Referrals for Home and Community Care (HACC) support are received from the Regional Assessment Service. Community Care do not screen for eligibility nor assess potential consumers for services and as such, are dependent on these referrals to maintain and increase service levels.
4. Inception of the Assessment Framework in 2011 has resulted in increased compliance with eligibility criteria and people receiving services based on assessed need and not just an eligibility status, meaning a person with an ongoing functional disability may be eligible for HACC support but with the provision of the correct assistive equipment may continue to support themselves independently without formalised support.

HACC SERVICE DELIVERY

5. The Volumes Report (Attachment 1) shows how Community Care is performing in relation to its contracted service provision levels for the HACC program for the period of April, May and June 2015.
6. The HACC Contract contains service groups that cluster, where appropriate, like service types together. Service Group 1 includes the following service types: domestic assistance, personal care, social support, respite and other food services.
7. Service Group 1 was contracted to provide hours of support against the service types listed in paragraph 6. This allows the service types to be adjusted to meet the needs of eligible consumers regardless of the contracted number of hours against each service type.

-
8. Because of this service grouping, a service type such as domestic assistance can achieve higher than 100% of service delivery, providing other service types are not also achieving 100%. The hours are used in a flexible manner to address need.
 9. During this quarter Community Care was contracted to provide 6285 hours across Service Group 1 to eligible community members. A total of 4299 hours were provided (68.5%). This is a 0.5% decrease from last quarter.
 10. During the course of 2014/2015 Community Care was contracted to provide a total of 25,144 hours across Service Group 1 to eligible community members. A total of 17,788 hours were provided (71%). This is an 11% increase from 2013/2014.

Domestic Assistance (Service Group 1)

11. During this quarter Community Care was contracted to provide 2928 hours to eligible community members. A total of 3174 hours were provided (108%). This is equal to last quarter.
12. Impacts on these hours included 837.75 hours that were not provided due to public holidays or consumers exercising their right of choice and cancelling services to attend to other commitments. Had these hours been delivered domestic assistance would have achieved 138% which is accommodated by the flexible delivery model assigned to Service Group 1 as describe in paragraph 7.
13. During the course of 2014/2015 Community Care was contracted to provide a total of 11,710 hours of domestic assistance to eligible community members. A total of 13,077 hours were provided (112%). This is a 17% increase from 2013/2014.

Respite (Service Group 1)

14. During this quarter Community Care was contracted to provide 450 hours to eligible community members. A total of 96 hours were provided (21%). This is a 2% decrease from last quarter.
15. Impacts on these hours included 52.5 hours that were not provided due to public holidays or consumers exercising their right of choice and cancelling services to attend to other commitments. Had these hours been provided, Respite would have achieved 33%.
16. During the course of 2014/2015 Community Care was contracted to provide a total of 1800 hours of respite to eligible community members. A total of 418 hours were provided (23%). This is an 8% increase from 2013/2014.

Other Food Services (Service Group 1)

17. During this quarter Community Care was contracted to provide 96 hours to eligible community members. A total of 13 hours were provided (13.5%). This is a 5% decrease from last quarter.

-
18. Impacts on these hours included 1.25 hours that were not provided due to public holidays or consumers exercising their right of choice and cancelling services to attend to other commitments. Had these hours been provided, Other Food Services would have achieved 15%.
 19. During the course of 2014/2015 Community Care was contracted to provide a total of 386 hours of other food services to eligible community members. A total of 79 hours were provided (20%). This is equal to 2013/2014.

Social Support (Service Group 1)

20. During this quarter Community Care was contracted to provide 1875 hours to eligible community members. A total of 766 hours were provided (41%). This is a 1% decrease from last quarter.
21. Impacts on these hours included 105.25 hours that were not provided due to public holidays or consumers exercising their right of choice and cancelling services to attend to other commitments. Had these hours been provided Social Support would have achieved 46%.
22. During the course of 2014/2015 Community Care was contracted to provide a total of 7500 hours of social support to eligible community members. A total of 3193 hours were provided (43%). This is 9% increase from 2013/2014.

Personal Care (Service Group 1)

23. During this quarter Community Care was contracted to provide 936 hours to eligible community members. A total of 250 hours were provided (27%). This is a 3% decrease from last quarter.
24. Impacts on these hours included 67.5 hours that were not provided due to public holidays or consumers exercising their right of choice and cancelling services to attend to other commitments. Had these hours been provided, Personal Care would have achieved 34%.
25. During the course of 2014/2015 Community Care was contracted to provide a total of 3748 hours of personal care to eligible community members. A total of 1021 hours were provided (27%). This is 2% decrease from 2013/2014.

Centre Based Day Care (Service Group 4)

26. During this quarter Community Care was contracted to provide 9981 hours to eligible community members. A total of 8162 hours were provided (82%). This is a 4% decrease from last quarter.
27. Impacts on these hours included 4002 hours that were not provided due to public holidays or consumers exercising their right of choice and cancelling services to attend to other commitments. Had these hours been provided, Centre Based Day Care would have achieved 122%.
28. During the course of 2014/2015 Community Care was contracted to provide a total of 39,924 hours of social support to eligible community members. A

total of 32,913 hours were provided (82%). This is 7% increase from 2013/2014.

Meals on Wheels (Service Group 6)

29. During this quarter Community Care was contracted to provide 1500 meals to eligible community members. A total of 1294 meals were provided (86%). This is a 2% decrease from last quarter.
30. Impacts included 342 meals that were not provided due to public holidays or consumers exercising their right of choice and cancelling services to attend to other commitments. Had these hours been provided, Meals on Wheels would have achieved 109%.
31. During the course of 2014/2015 Community Care was contracted to provide a total of 6000 meals to eligible community members. A total of 5388 meals were provided (90%). This is 40% increase from 2013/2014.

Transport (Service Group 7)

32. During this quarter Community Care was contracted to provide 6816 one way trips to eligible community members. There were 4106 one way trips provided (60%). This is a 0.5% increase from last quarter.
33. Impacts included 1691 one way trips that were not provided due to public holidays or consumers exercising their right of choice and cancelling services to attend to other commitments. Had these hours been provided, Transport would have achieved 85%.
34. During the course of 2014/2015 Community Care was contracted to provide a total of 27265 one way trips to eligible community members. A total of 16,007 one way trips hours were provided (59%). This is 4% increase from 2013/2014.

Consumer Support Information and Advocacy (Service Group 9)

35. During this quarter Community Care was contracted to provide 645 hours to eligible community members. A total of 182 hours were provided (28%).
36. During the course of 2014/2015 Community Care was contracted to provide a total of 2574 hours of consumer support information and advocacy to eligible community members. A total of 1065 hours were provided (41%). This is 2% decrease from 2013/2014.

Home Maintenance (Service Group 10)

37. During this quarter Community Care was contracted to provide 1788 hours to eligible community members. A total of 1414 hours were provided (79%). This is a 4% decrease from last quarter.
38. In November 2014, the Shire ceased accepting new referrals for Home Maintenance due to a change of staffing arrangements resulting in a risk of not being able to fulfil consumer requests.

-
39. Impacts on these hours included 144.5 hours that were not provided due to public holidays or consumers exercising their right of choice and cancelling services to attend to other commitments. Had these hours been provided, Home Maintenance would have achieved 87%.
40. During the course of 2014/2015 Community Care was contracted to provide a total of 7166 hours of home maintenance to eligible community members. A total of 6136 hours were provided (86%). This is 14% increase from 2013/2014.

COMMUNITY VISITORS SCHEME

41. During this quarter Community Care was contracted to provide 270 visits to eligible residents in approved Commonwealth Funded residential facilities. There were 291 visits provided (107%).
42. During the course of 2014/2015 Community Care was contracted to provide a total of 1080 visits. A total of 1136 visits were provided (105%)

HOME CARE PACKAGES LEVEL 2

43. During this quarter Community Care was contracted to provide 20 packages to eligible community members. A total of 15 packages were provided (75%).
44. Referrals for packages come from the Aged Care Assessment Team (ACAT). Community Care do not screen for eligibility nor assess potential consumers for services and as such, we are dependent on these referrals to maintain and increase service levels.
45. Home Care Packages are being transitioned to Consumer Directed Care Packages as of 1 July 2015. Community Care are preparing an implementation plan to drive this program, procedural and cultural change.

STATUTORY AND LEGAL CONSIDERATIONS

46. Nil.

POLICY CONSIDERATIONS

47. Nil.

COMMUNITY ENGAGEMENT REQUIREMENTS

48. During this quarter Community Care conducted a feedback survey with day centre consumers to determine their level of satisfaction with the fresh daily prepared meals.
- The outcome was positive with the findings showing that:
- 75% of participants were satisfied with the meal size,
 - 97% of participants were satisfied with the presentation of meals,
 - 100% of participants were satisfied with the quality of the meals, and
 - 99% of participants were satisfied with the variety of the meals.

-
49. Community Care are currently conducting a HACC service wide satisfaction survey.

FINANCIAL CONSIDERATIONS

50. The Community Care Program (HACC) had anticipated a small surplus for the 14/15 financial year. The program, however, has returned an operating deficit of \$73,508. While provision had been made through the year for annual and long service leave a further \$133,635 was required when the leave provisions were reconciled. A number of staff have reached eight years of service and this alters the probability calculation for long service leave.
51. The provisions will be reviewed when the HACC audit is carried out by the Shire auditors so the HACC financials are not yet finalised. Any deficit can be carried forward to the 15/16 financial year.
52. The Meals on Wheels Program has an operating deficit of \$25,884.

STRATEGIC COMMUNITY PLAN

Strategic Planning Alignment

53. *Kalamunda Advancing: Strategic Community Plan to 2023*

OBJECTIVE 1.1 - To be a community that carers for its aged and frail and those less fortunate.

Strategy 1.1.2 - Continue to deliver relevant and effective programs to our elderly so that they can feel socially connected and supported from within the Community.

SUSTAINABILITY

Social Implications

54. *Shire of Kalamunda Aged Accommodation Strategy 2008:*

6.1 A strong desire to “age in place” is now the well-established preference for older people and is a key theme that underlies Commonwealth and State Government policy and programs. This encompasses being able to continue to live in the familiar surroundings of the home and local environment as independently as possible, and with support services if required.

Economic Implications

55. Nil.

Environmental Implications

56. Nil.

RISK MANAGEMENT CONSIDERATIONS

57.

Risk	Likelihood	Consequence	Rating	Action/Strategy
Surplus funding – Home and Community Care	Likely	Major	High	<ul style="list-style-type: none"> • Continue to promote Community Care as provider of choice in region. • Ensure recruitment and retention strategies are fully utilised. • Continue to analyse and evaluate service delivery statistics monthly to identify trends and opportunities for improvement.
Seniors in the Shire are not supported.	Unlikely	Major	Medium	<ul style="list-style-type: none"> • Continue to promote services and programs as a Shire core business. • Continue to work in partnership with other local providers. • Continue to attend HACC, HCP and Swan Hospital Networking Meetings. • Ensure staffing levels are retained at a level that facilitates ongoing service provision. • Progress the development of Marketing and Communication Plan. • Progress the development of the Ageing Population Plan • Commence consultation and engagement opportunities to determine what is working well and not working well and develop an action plan to address identified opportunities for improvement.

OFFICER COMMENT

58. The transition of Home Care Packages to Consumer Directed Care Packages is moving forward and it is anticipated that Community Care will be on track to commence the formal transition of our existing package consumers in June prior to the required 1 July 2015 timeframe.
59. Community Care are working closely with National Disability Insurance Scheme (NDIS) to transition HACC people under the age of 65 who have successfully explored NDIS eligibility to an NDIS support plan.
60. During this quarter Community Care had 29 consumers exit the HACC program. The feedback from consumers and/or family as to why the services were ceasing were:
- The consumer has moved to a higher level of community care support or residential care – 15 responses
 - The consumer is now self-managing - six responses
 - The consumer has passed away – six responses
 - The consumer has relocated out of the service area – two responses

Voting Requirements: Simple Majority

OFFICER RECOMMENDATION (C&C 35/2015)

That Council:

1. Receives the Community Care Quarterly Report – June 2015.

Moved:

Seconded:

Vote:

Attachment 1
Community Care 14/15
Monthly Hours Worked By Category

OUTPUT DELIVERABLES		SERVICE VOLUME			July	Aug	Sept	Oct	Nov	Dec	Jan	Feb	Mar	Apr	May	Jun	MDS	ACTUAL	Contracted	% Met	Variance		
		P.A	P. Mth	Ave 12/13																		Ave 13/14	Ave 14/15
Service Group 1																							
DOMESTIC ASSISTANCE	1231	11,710	976	837	915	1,090	1,130	1,005	1,071	1,165	1,019	1,096	1,004	1,036	1,135	993	1,093	1,088	244	13,077	11,710	111.67%	1,367
SOCIAL SUPPORT	1222	7,500	625	246	224	266	306	248	239	279	248	261	248	270	274	265	246	255	56	3,193	7,500	42.58%	-4,307
PERSONAL CARE	1232	3,748	312	104	92	86	100	78	64	87	68	85	83	85	101	88	75	87	32	1,031	3,748	27.51%	-2,717
OFS	1234	386	32	3	7	7	10	8	6	7	6	7	6	6	6	4	5	4	4	79	386	20.40%	-307
RESPIRE	1224	1,800	150	12	23	35	27	37	47	41	21	42	33	30	41	31	30	35	5	419	1,800	23.26%	-1,381
TOTAL SERVICE GROUP 1																				17,799	25,144	70.79%	-7,346
Service Group 9																							
CSIA	1227	2,574	215	64	94	89	58	55	70	60	42	47	68	51	71	56	71	55	361	1,065	2,574	41.36%	-1,509
Service Group 4																							
CNTR BASED DAY CARE	1221	39,924	3,327	2,567	2,499	2,743	2,994	2,664	2,678	2,967	2,520	2,340	2,724	2,880	3,026	2,436	2,836	2,890	-42	32,913	39,924	82.44%	-7,011
Service Group 10																							
HOME MAINTENANCE	1230	7,166	597	438	431	511	519	494	491	568	497	501	478	480	523	475	457	482	174	6,136	7,166	85.63%	-1,030
Service Group 7																							
TRANSPORT(occasions)	1229	17,985	1,499	394	439	459	462	433	445	501	459	438	383	406	495	493	498	495		5,508	17,985	30.63%	-12,477
TRANSPORT(CBDC)	1233	9,280	773	842	803	875	957	852	842	935	804	734	869	922	983	782	915	923	-19	10,499	9,280	113.14%	1,219
TOTAL SERVICE GROUP 7																				16,007	27,265	58.71%	-11,258
TOTAL		102,073	8,506	5,506	5,526	6,160	6,562	5,873	5,952	6,609	5,683	5,550	5,896	6,165	6,653	5,623	6,226	6,313	815	73,919	102,073	72%	-35,499

OUTPUT DELIVERABLES		SERVICE VOLUME			July	Aug	Sept	Oct	Nov	Dec	Jan	Feb	Mar	Apr	May	Jun	MDS	ACTUAL	Contracted	Met	Variance		
		Total	P. Mth	Ave 12/13																		Ave 13/14	Ave 14/15
Service Group 6																							
MEALS ON WHEELS		6,000	500	512	410	449	500	384	389	464	469	530	462	446	420	401	436	457	30	5,388	6,000	90%	-612

Attachment 2

Home and Community Care Service Financials 2014/2015

INCOME AND EXPENDITURE	Budget 2014/15	Actuals 2014/15
Recurrent Income and Expenditure		
Income		
Fees - Adult Day Care Attendance	(41,240)	(42,757)
Fees - Adult Day Care Transport	(25,780)	(26,700)
Fees - In Home Respite	(2,702)	(3,248)
Fees - Social Support	(23,490)	(23,670)
Fees - Transport / Shoppers Bus	(30,865)	(32,726)
Fees - Personal Care	(8,732)	(7,768)
Fees - Domestic Assistance	(101,880)	(100,004)
Fees - Gardening	(48,208)	(47,219)
Fees - Other Food Services	(616)	(630)
Fees - Meals / Brokerage Adult Day Care	(65,281)	(67,655)
Notional Income - Volunteer	(42,095)	(42,097)
Brokerage Income	(23,000)	(22,884)
Interest on Reserve Funds		(12,271)
Refund on Long Service Leave Payment		(5,212)
Government Grants	(2,834,483)	(2,834,482)
Total Recurrent Income	(3,248,371)	(3,269,321)
Expenses		
Salaries and Wages and on costs	2,331,604	2,319,168
Leave Accruals	172,852	306,488
Workers Compensation	40,123	39,431
Volunteer Notional Expenditure	42,095	42,097
Contractors	78,967	76,129
Accommodation Expenses	107,808	109,531
Motor Vehicle Expenses	57,500	47,052
Fringe Benefits Tax	6,600	4,630
Insurance	2,295	1,509
Printing and Stationery	3,898	3,832
Subscriptions	4,549	4,549
Purchases - Consumables / Materials	31,752	31,114
Purchases - Sundry	36,391	34,898
Depreciation	72,165	66,443
Audit	3,610	1,270
Loss on Sale (Vehicles)	0	33,417
Management Fee - Administration and Accounting	100,080	99,536
Management Fee - Human Resources	33,647	28,844
Management Fee - Information Technology	34,155	38,056
Meal Expenses - Clients	65,281	68,266
Total Recurrent Expenditure	3,225,372	3,356,260
Deduct Brokerage Fees - Non-HACC Income		22,884
Net Recurrent Income/Expenses		109,822
Add Adjustment to Asset Provision Account		99,860
Add Income / Adjustment to Leave Provision Account		36,314
Revised Net Recurrent Income/Expenses	(22,999)	(26,352)

Net Recurrent Income / Expenses to be finalised - Audit of financials and leave / asset provisions pending

Attachment 3

Meals on Wheels Financials 14/15

Income / Expenditure Description	Budget 2014/15	Actuals 2014/15
Recurrent Income and Expenditure		
Income		
Fees - Brokerage	-	(446)
Notional Income Volunteers	(27,234)	(27,234)
Fees - MOW's	(62,738)	(59,860)
Government Grants - State Operating	(2,836)	(2,837)
Total Recurrent Income	(92,808)	(90,377)
Expenses		
Shire Service Fees	10,038	10,016
Volunteer Reimbursements (Delivery / Fuel)	12,360	9,540
Notional Expenditure Volunteers	27,234	27,234
Purchases - Consumables	70,000	66,239
Purchases - Sundry	2,486	3,231
Total Recurrent Expenses	122,119	116,261
Net Recurrent Income/Expenses	29,311	25,884

Declaration of financial / conflict of interests to be recorded prior to dealing with each item.

36. Community Groups Lease Policy Proposed Amendments

Previous Items	
Responsible Officer	Director Corporate Services
Service Area	Property Services
File Reference	
Applicant	N/A
Owner	N/A
Attachment 1	Community Groups Lease Policy
Attachment 2	Proposed Community Groups Lease Policy
Attachment 3	Facilities Hire Agreement

PURPOSE

1. To approve proposed amendments to the Community Groups Lease Policy (Attachment 2), that will provide Council with a policy position to deal with Community Groups who refuse to sign the Council adopted Community Groups Lease.

BACKGROUND

2. At the Ordinary Council Meeting on 25 February 2013 Council adopted Lease Policy LEA1 – Community Groups Lease Council Policy (the Policy) (Attachment 1).
3. The Policy was designed to provide greater transparency and equity in administering the lease of facilities to Community Groups and its implementation has been very successful.
4. As part of the implementation process, the Shire has worked closely with user groups to improve and clarify the Lease Agreements.

DETAILS

5. There are currently a small number of user groups who have refused to sign the Lease Agreement as specified within the Policy. The current Community Group's Lease Policy provides for a dispute resolution process. This process applies where a user group with a signed a Lease Agreement is in dispute with the Shire over interpretations relating to the Agreement.
6. The Shire does not currently have a clear policy position regarding user groups who have not signed a Lease Agreement.
7. It is proposed that the Community Group's Lease Policy be amended to provide Council with a policy position to enable the management of user groups who are not subject to an approved Lease Agreement.

-
8. It is proposed the Community Group's Lease Policy be amended to stipulate that user groups who do not sign the Lease Agreement will be offered the use of facilities under a Facility Hire Agreement (Attachment 3), through the inclusion of the following paragraph in the Policy Statement:

Community Groups unwilling to sign a Lease Agreement in accordance with this Policy, will be required to hire the facilities in accordance with the Shire's Casual Facility Hire Agreement at the rate applicable for the facility.

9. It is essential any agreements clearly outline the nature of the hire arrangements, roles and responsibilities of parties to the Agreement and outline fees and charges payable under the agreement. Importantly, under a Facility Hire Agreement, the user group will not have exclusive use of the facility.
10. The Shire's preferred position is to have user groups operating under the Community Group's Lease Agreement.

STATUTORY AND LEGAL CONSIDERATIONS

11. Section 3.58 Disposing of Property in the *Local Government Act 1995* states: "*Dispose includes to sell, lease or otherwise dispose of, whether absolutely or not*"

POLICY CONSIDERATIONS

12. The amendment to this policy will address a current policy gap and will provide the Shire with a clear position for handling situations in which user groups choose not to sign the adopted Community Group's Lease Agreement.

COMMUNITY ENGAGEMENT REQUIREMENTS

13. The original policy was referred to all User Groups for comment. Following assessment of the comments meetings were held with 39 User Groups to discuss a proposed way forward.
14. Since the adoption of the Community Group's Lease Agreement in February 2013, the Shire has met regularly with User Groups to ensure Lease Agreements are operating effectively.

FINANCIAL CONSIDERATIONS

15. The proposed amendment to the Community Groups' Lease Policy will ensure financial arrangements are clear and there is equity and consistency in the way the Shire's User Groups are managed.

STRATEGIC COMMUNITY PLAN

Strategic Planning Alignment

16. *Kalamunda Advancing: Strategic Community Plan to 2023*

OBJECTIVE 4.7 – To ensure the selection, maintenance, inspection, renewal and disposal of all categories of assets within the Shire is managed efficiently.

Strategy 4.7.1 Maintain, refurbish or upgrade existing infrastructure, including public buildings, parks, reserves, local roads, footpaths, cycle ways, verges and drainage networks to encourage increased utilization and extension of asset life.

SUSTAINABILITY

Social Implications

17. Equitable access to community and cultural infrastructure is considered an essential element in creating safe, inclusive, accessible and sustainable communities.

Economic Implications

18. The proposed policy amendment will provide User Groups with clarity regarding their financial obligations.

Environmental Implications

19. Nil.

RISK MANAGEMENT CONSIDERATIONS

- 20.
- | Risk | Likelihood | Consequence | Rating | Action/Strategy |
|--|------------|-------------|--------|---|
| That Council does not support the amended policy | Unlikely | Minor | Low | Ensure that Council is aware of the need to ensure that Community Groups are treated fairly and equitably |

OFFICER COMMENT

21. The key principles of good policy are transparency, consistency and equity. The draft policy amendments addresses these factors and addresses a current policy gap.

-
22. The proposed Policy amendments will provide the Shire with a policy position to enable the management of user groups that are not subject to an approved Lease Agreement.
 23. The Shire will continue to work proactively with user groups to ensure that community facilities are operating under the approved Community Groups Lease Policy. Where a Community Group is not prepared to sign a Lease Agreement, in accordance with the amended Lease Policy, the Community Group will utilise facilities in accordance with a Facilities Hire Agreement.
 24. Where a user group is operating under a Facilities Hire Agreement, the user group will not have exclusive use of the facility.
 25. Typically under a hire agreement scenario, sporting facilities are shared between various users therefore storage of memorabilia and other equipment would not normally remain on site.

Voting Requirements: Simple Majority

OFFICER RECOMMENDATION (C&C 36/2015)

That Council:

1. Approves the amended Community Groups' Lease Policy (Attachment 2).

Moved:

Seconded:

Vote:

Attachment 1

C-PP02 – Community Groups’ Leases

Management Procedure	Relevant Delegation
CM-PP02 – Community Groups’ Leases	N/A

Purpose

To provide spaces for community groups within the Shire and ensure consistency and transparency for all leasing activities. This Policy will also ensure that lessees maintain a sense of responsibility toward Shire assets and provide for the effective use and efficient management of those facilities to the benefit of ratepayers.

Policy Statement

The Shire is committed to providing long-term leased facilities to community groups within the Shire to support their activities for the benefit of ratepayers. Leases are on the basis that the community group will be responsible for the consumables they use, minor maintenance and other nominal costs. Such leases are available only to associations formed under the *Associations Incorporation Act 1987*, all other long-term leases will be considered as Commercial Leases.

In recognition of the community benefit provided by Associations, the lease fee applicable will be \$1.00 per annum (peppercorn).

Lease terms should not generally be negotiated for a total term, including options, longer than 10 years.

Related Local Law	
Related Policies	
Related Budget Schedule	
Legislation	<i>Local Government Act 1995, Section 3.58</i>
Conditions	
Authority	
Adopted	20 February 2012
Next Review Date	

Attachment 2

C-PP02 - Community Groups' Lease Council Policy	
Management Procedure CM-PP02 Community Groups' Leasing Guideline Policy Procedure	Relevant Delegation

Purpose

To provide spaces for community groups within the Shire and ensure consistency and transparency for all leasing activities. This Policy will also ensure that lessees maintain a sense of responsibility toward Shire assets and provide for the effective use and efficient management of those facilities to the benefit of the community ratepayers.

Policy Statement

The Shire is committed to providing long-term leased facilities to community groups within the Shire to support their activities for the benefit of the community ratepayers.

Lease terms should not generally be negotiated for a total term, including options, longer than 10 years. Such leases are available only to associations formed under the *Associations Incorporation Act 1987*, all other long-term leases will be considered as Commercial Leases.

Leases are on the basis that the community group will be responsible for the consumables they use, minor maintenance and other nominal costs, except those costs identified within the Management Procedures to this Policy as being the responsibility of the Shire. In recognition of the community benefit provided by Associations, the lease fee applicable will be \$1.00 per annum (peppercorn).

Community Groups unwilling to sign a Lease Agreement in accordance with this Policy, will be required to hire the facilities in accordance with the Shire's Casual Facility Hire Agreement at the rate applicable for the facility.

Related Local Law	
Related Policies	
Related Budget Schedule	
Legislation	<i>Local Government Act 1995, Section 3.58</i>
Conditions	
Authority	
Adopted	Next Review Date

Attachment 3

Conditions of Hire Shire Facilities



Conditions:

1. All functions are to finish by your booked time and the facility cleaned and vacated (including equipment) within the agreed time, unless otherwise arranged. Any unpaid amendments to bookings will be deducted from the bond or met by the hirer.
2. Following the booking all lights and electrical appliances are to be switched off, exit doors and internal doors locked and windows secured.
3. The facility shall be left in a clean and tidy condition with:
 - Tables and chairs cleaned and stacked away in the designated storage areas.
 - The floor swept and mopped with the equipment provided. (Cleaning products not supplied).
 - All rubbish being placed in the wheelie bins provided. It is the hirer's responsibility to provide additional bins or have rubbish removed from a venue if a function generates an excessive amount of rubbish.
4. All costs for losses, damage or extra cleaning required inside and/or outside of the hall will be deducted from the bond or met by the hirer. The hirer must inform the Shire if any damage is discovered prior to the commencement of their booking. Failure to do so may jeopardise the bond. Any unreported damage may also be charged to the hirer.
5. The driving of tacks, nails, screws or fixing of blue tack etc. into any of the woodwork or walls or any part of the building, furniture or fixtures is strictly forbidden. No internal or external decorations are permitted to be erected without the approval of Council Officers.
6. The use of candles or smoke devices within Shire facilities is not permitted as they will cause the fire alarm to activate.
7. It is the responsibility of the hirer to ensure that no person behaves in a disorderly manner or causes a nuisance or annoyance. The hirer must ensure order of guests and that decent behaviour is maintained both inside and outside the hall (e.g. in car park and surrounding areas) before, during and after the function. If police are called out due to excessive noise or to maintain order or disperse a disorderly crowd, the bond may be forfeited.
8. In the event of a breakdown in services, utilities, equipment etc. no responsibility will be accepted by the Shire but every care and precaution will be taken in this regard.
9. It may be necessary for maintenance work to be carried out on grounds and venues during the year and your allocated period of hire may be affected. If this is the case you will be contacted and advised of the nature of work and proposed timeframe. Every effort is made to find an alternative venue for the hirer however no guarantee can be given.
10. The Shire has a **NO SMOKING POLICY** which applies to all Shire buildings.
11. With the exception of Jorgensen Pavilion, Headingly Road Cottage, Town Square Hall, Anderson Road Community Hall, Gooseberry Hill Multi-Use Facility & Forrestfield Library Exhibition Room, all Council facilities are available for usage where alcohol is either sold or consumed, subject to the following:
 - If alcohol is to be consumed, a "Permit to Consume Alcohol" form must be obtained from the Shire offices at a cost of \$24.00.
 - If alcohol is to be sold a license needs to be obtained from the Office of Racing, Gaming and Liquor (Licensing Division), 87 Adelaide Terrace, Perth, 9425 1888 **14 days prior to**

- your function. A copy of this permit must be sent to the Shire of Kalamunda a minimum of 7 days before the date of your hire.**
- 12.** Alcohol is not to be consumed outside of the building.
 - 13.** Each building is equipped with a limited number of tables and chairs. Any additional equipment required is to be provided at the hirer's expense. **Please note: cutlery, crockery and audio visual equipment is not provided.**
 - 14.** The Shire cannot offer exclusive use of facilities to any one group or individual and may on occasion allow usage of a facility by other community groups, individuals or the Shire itself. In the event of this happening, hirers will be given adequate notice and if practical, another facility made available.
 - 15.** Casual users will be invoiced and payment is required **four** weeks prior to function. The booking will be automatically cancelled if payment is not received by the due date. Permanent Booking accounts are sent at the end of each three months.
 - 16.** Cancellations of 'Permanent User' bookings must be received **in writing two weeks in advance** to avoid being charged.
 - 17.** Casual Bookings cancelled within 14 days of the booking will result in a 50% cancellation fee.
 - 18.** If the Shire's Rangers or contracted Security Company are required to attend before or after the prearrange time, the cost of this call-out will be met by the hirer.
 - 19.** The use of any stage in a Shire facility is at the risk of the hirer.

PRIVATE PARTIES & FUNCTIONS CONSUMING/SELLING ALCOHOL

- For all functions involving alcohol, the following additional conditions apply:
 Bookings forms must be received at least **8 weeks** in advance and are required to be approved by the Coordinator Customer Relations. Bookings will not be accepted if forms are submitted less than 8 weeks prior to the booking date.
- 20.** A Statutory Declaration must be completed and submitted with the booking application forms advising that a full and accurate disclosure of all booking details has been made and the hirer has read and is bound by the Conditions of Hire. If a breach of the Conditions of Hire is made the hirer will automatically forfeit the full bond.
 - 21.** Council reserves the right to insist on security/crowd control. This would involve hiring of a licensed security firm at a ratio of 1:40 guests. Proof of this would be required in writing from the security company.
 - 22.** Proof of a formal invitation is required before an application will be approved.
 - 23.** Functions with alcohol must finish at 12 midnight.
 - 24.** Bookings may be declined at the discretion of the Coordinator Customer Relations.

I hereby acknowledge that I have read the conditions of hire as outlined above and agree to comply with them.

Name:	Signature:	Date:
Organisation	Facility:	Invoice:

For further information contact Shire of Kalamunda on 9257 9999. PO Box 42, Kalamunda 6926.

Declaration of financial / conflict of interests to be recorded prior to dealing with each item.

37. Community Sport and Recreation Facilities Fund Annual Grants 2015/16

Previous Items	Nil
Responsible Officer	Chief Executive Officer
Service Area	Community Development
File Reference	
Applicant	N/A
Owner	

Attachment 1 Hill's BMX Facility Upgrade Scope of Works

PURPOSE

1. To consider supporting one application for funding through the Department of Sport and Recreation's (DSR) Community Sport and Recreation Facilities Fund (CSRFF) Annual Grants Round.

BACKGROUND

2. Through the CSRFF program, the State Government provides financial assistance to community groups and local government authorities to develop basic infrastructure for sport and recreation. The program aims to increase participation in sport and recreation with an emphasis on increasing physical activity through the provision of well-planned facilities.
3. The Shire's role in the provision of the funding is to call for applications, assess them in priority order and rate each application received (Attachment 1).
4. The maximum grant approved will be no greater than one third of the total estimated project cost.
5. There is no obligation on the local government authority to make any contribution to a project.
6. All applications for this annual grants round are to be received by the DSR by 4pm on the last working day of September 2015 for assessment.
7. Successful applicants will be advised in February 2016, with funds to be expended by 15 June 2017.

DETAILS

8. The Shire of Kalamunda has one external application for the DSR's CSRFF 2015/16 Annual Grants Round.

Hills BMX Club

9. The application is for a proposed re-design of the Start Gate Ramp from 2.5 metres to 5 metres, also enabling an upgrade and refurbishment of the club rooms at the BMX track at Ray Owen Reserve in Lesmurdie.
10. The Project will contribute to the sustainability of the BMX Club with improved facilities allowing the Hills BMX Club to retain and attract a strong membership base and better accommodate the wider BMX community.
11. Specifically, the Project will allow the Club to remain competitive within the sporting market by providing an updated facility to attract local, State and National competitors and competitions to the venue.
12. The Club has provided a cost estimate for the project of \$226,350. Based on the standard one third each split, the proposed cost contribution is as follows:

Organisation	Contributions ex GST
CSRFF	\$75,450
Shire of Kalamunda	\$75,450
Hills BMX	\$75,450
Total Project Cost	\$226,350

STATUTORY AND LEGAL CONSIDERATIONS

13. Nil.

POLICY CONSIDERATIONS

14. Nil.

COMMUNITY ENGAGEMENT REQUIREMENTS

15. Should the CSRFF funding be successful with the DSR, further consultation will be undertaken with relevant site stakeholders.

FINANCIAL CONSIDERATION

16. The Shire of Kalamunda's contribution towards the proposed projects will be dependent on the outcome of the CSRFF applications and is proposed to be considered as part of the 2016/17 budget process.
17. The Hills BMX Club have indicated they would be willing to fund up to two thirds of the project should the Shire of Kalamunda not be in a position to provide funding assistance.

18. At present, within the Long Term Financial Plan, \$100,000 (2018/19), \$2.5 million (2019/20) and \$2.5 million (2020/21) respectively has been allocated towards the implementation of the Ray Owen Master Plan, which supported this project.

STRATEGIC COMMUNITY PLAN

Strategic Planning Alignment

19. *Kalamunda Advancing Strategic Community Plan to 2023*

OBJECTIVE 1.9 - To provide high quality facilities to meet the needs of our current and our future community.

SUSTAINABILITY

Social Implications

20. The provision of high quality community sport and recreation facilities is essential in fostering a positive sense of community health and wellbeing.

Economic Implications

21. Nil.

Environmental Implications

22. It is proposed that additional bush protection measures shall be required as part of any upgrades to the new starting ramp, ensuring that the bushland is protected from any unwanted BMX track material run off and the footprint is retained.

RISK MANAGEMENT CONSIDERATIONS

- 23.
- | Risk | Likelihood | Consequence | Rating | Action/Strategy |
|--|-------------------|--------------------|---------------|---|
| That the CSRFF application is unsuccessful | Possible | Minor | Medium | Council and/or the BMX Club may decide to contribute the full amount of the total project cost. |

OFFICER COMMENT

24. Through the CSRFF program, the State Government provides financial assistance to community groups and local government authorities to develop basic infrastructure for sport and recreation. The program aims to increase participation in sport and recreation with an emphasis on increasing physical activity through the provision of well-planned facilities.
25. The DSR requires all applications to be assessed by each local government authority and provided with a ranking according to the local government's assessment. It should be noted, there is no obligation on the Shire to support a project.
26. This project has been ranked as the first and only priority in regards to facility development within the Shire of Kalamunda.
27. The BMX Club has noted a marked increase in membership within the last five years and their existing facility is unable to cope with the current and projected participation numbers. The track itself is in good condition however, the starting ramp does not currently provide the National and State height required (5m) for the Club to bid to host State, National and International events.
28. Club facilities are ageing with the first aid room currently housed within a rusting sea container. The clubroom and office areas are small and need extending to provide adequate facilities to the growing membership.
29. The proposed facility development will allow the Club to better accommodate existing membership in addition to positioning the Club to attract bigger events and competitors from the State, National and International BMX community.
30. The need for an upgraded, refurbished clubroom facility and a new five metre starting ramp is supported by the findings within the Ray Owen Master Plan (endorsed by Council February 2015).

Voting Requirements: Simple Majority

OFFICER RECOMMENDATION (C&C 37/2015)

That Council:

1. Endorses a Community Sport and Recreation Facilities Fund annual grant application from the Hills BMX Club towards a proposed new ramp and an upgrade and refurbishment of club rooms at Ray Owen Reserve in Lesmurdie.

Following success of the Community Sport and Recreation Facilities Funding the cost contribution will be:

Organisation	Contributions ex GST
CSRFF	\$75,450
Shire of Kalamunda	\$75,450
Hills BMX	\$75,450
Total Project Cost	\$226,350

2. Notes in the event of a successful Community Sport and Recreation Facilities Fund application, an amount of \$75,450 will be considered as part of the 2016/17 annual budget deliberation process.

Moved:

Seconded:

Vote:

Attachment 1

Hill's BMX Facility upgrade

Hills BMX club is seeking assisting funding from DSR to re-design the start gate from 2.5 meters to 5 meters in height also clubroom upgrade to improve the facility to required UCI standards and attract local, state and national level BMX competitions to Hills in the future.

The start gate will be extended in height and length to accommodate additional office, first aid and storage rooms beneath the ramp. Supporting structures to be constructed of "concrete box culvert tunnels" as a cost effective and lasting solution to house transportable offices and storage area.

Start ramp:



Existing 2.5 meter high start ramp.

Proposed 5 meter start ramp extension including offices / storage underneath.

Works will need to include relocation of roof structure above start gate and secondary staging area.

New start gate dimensions:

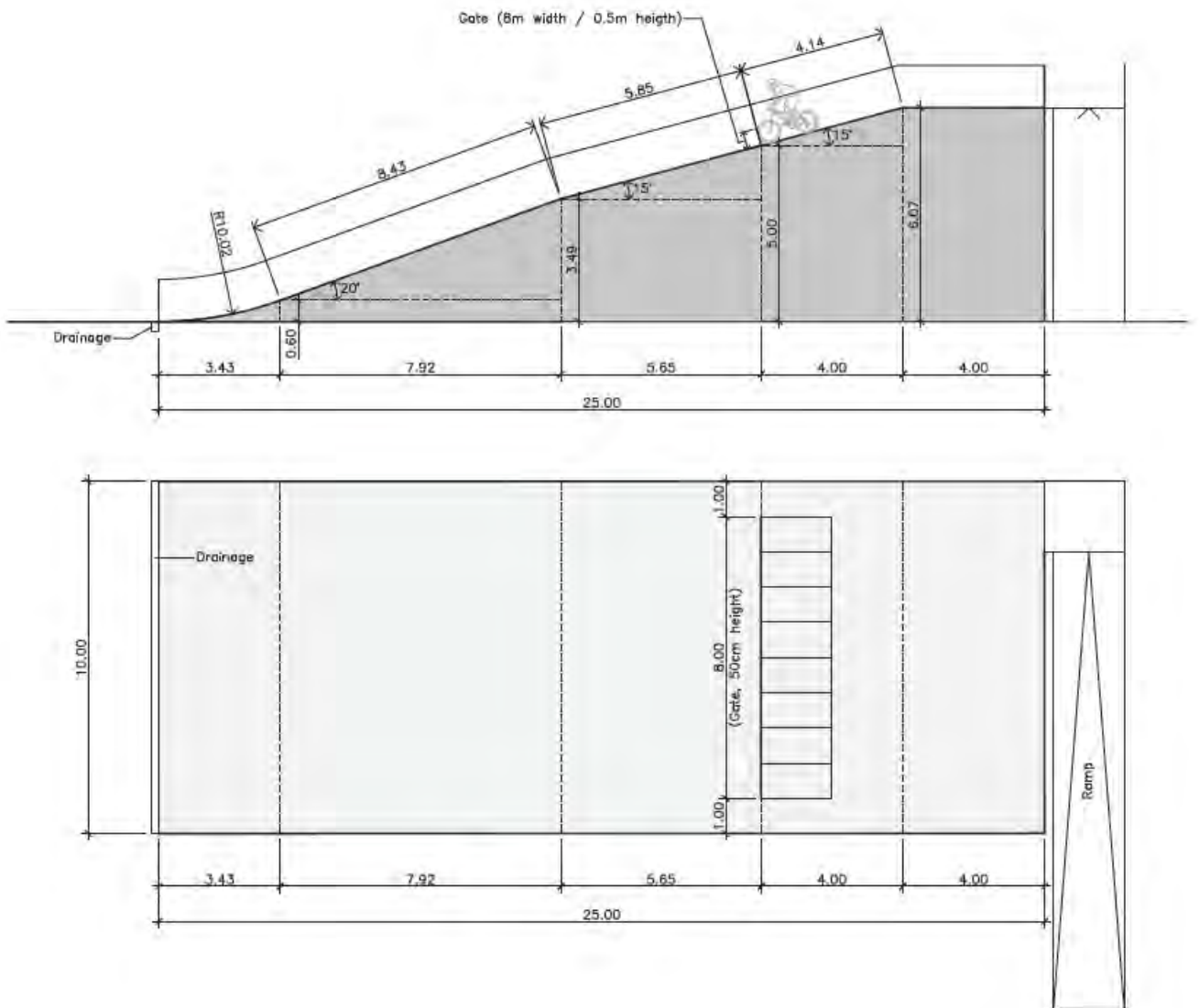

Proposed concrete box culvert tunnels to house offices and storage area's:



Clubrooms:

Present clubrooms house toilets, kitchen and office. Due the expansion of our club's members in recent years the current building is proving too small for the club's needs. The office is too small during racing events and also the 2 small toilets are inadequate for the large volume of participants and supports during weekly race nights.

Below is a floor plan of the current layout:

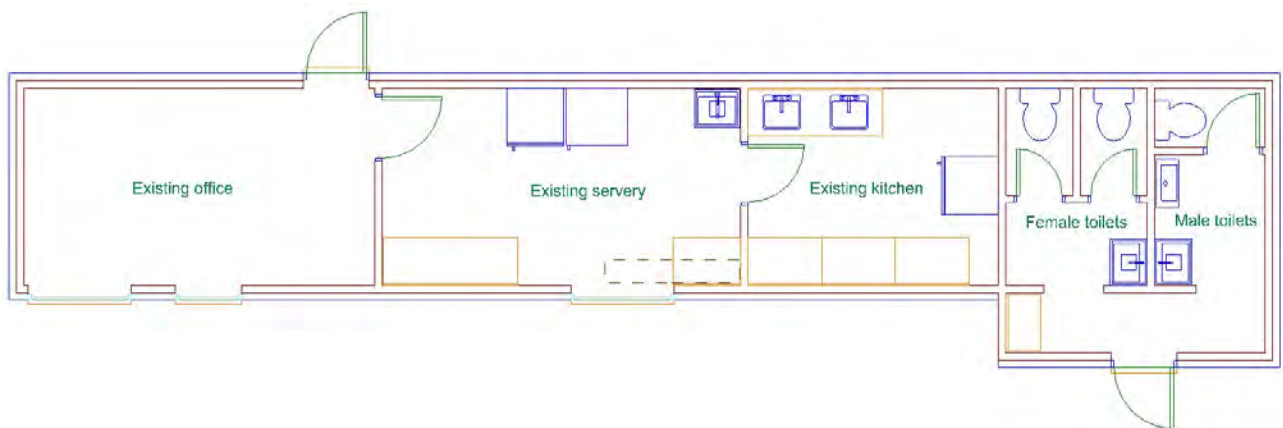

Our new proposed lay out would move the existing office to the new office built under the new start ramp allowing for a greater toilet area. Kitchen and servery area would be relocated with several upgrades to comply with current health standards.

New proposed clubroom layout:

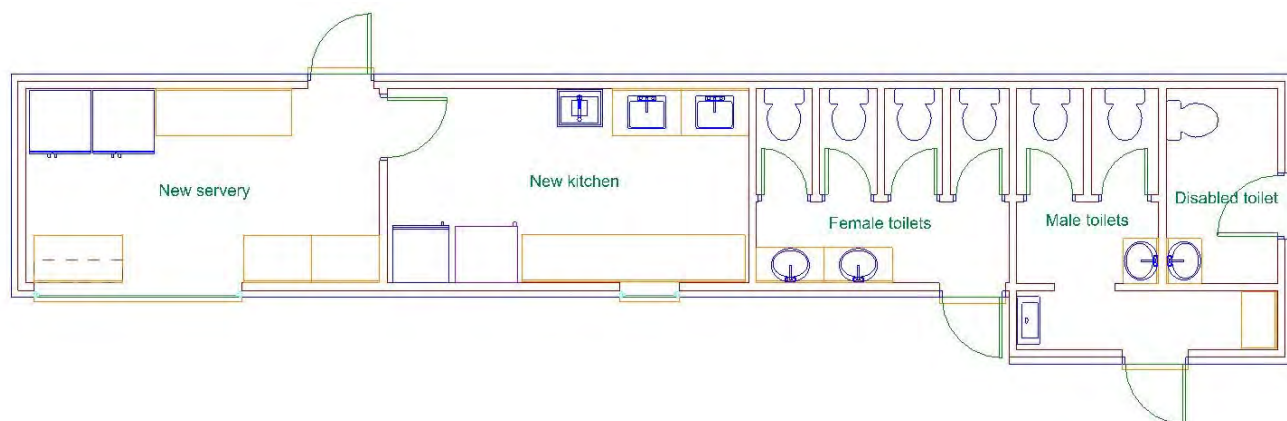

Our principle aspect of requested upgrades is to provide a competitive and attractive facility to allow local and regional riders to practice and participate in the growing sport of BMX. Hill's BMX facility originates from the early 80's and is in desperate need of the upgrades to continue to grow as a healthy club. With the upgrades it can also move its first aid room currently located in a shipping container into the office area provided under the ramp. The upgrade will also result in the removal of two unsightly sea containers currently located onsite to provide storage and first aid.

*Expected cost for start gate upgrade including relocation of roof structure, supply and install culverts, earthworks, fencing, relocation of gate and bitumen works: **\$129,000***

*Supply and connection of transportable offices including vandal proof entry doors: **\$32,500***

*Clubroom upgrade: **\$64,850***

Total project budget: \$226,350 + GST

Declaration of financial / conflict of interests to be recorded prior to dealing with each item.

38. Draft Pioneer Park Master Plan

Previous Items	Nil
Responsible Officer	Chief Executive Officer
Service Area	Community Development
File Reference	
Applicant	N/A
Owner	
Attachment 1	Pioneer Park Master Plan

PURPOSE

1. For Council to receive the Pioneer Park Master Plan (Attachment 1).

BACKGROUND

2. Pioneer Park is Crown Land vested with the Shire for the purposes of recreation and is located in Forrestfield. The Reserve is approximately 57ha in size and is currently home to the Kalamunda/Canning Rugby League Club (KCRLC).
3. Prior to Pioneer Park being used for recreation and sporting pursuits, the land was formally used as a landfill site, operating from 1975 and closing in July 1997.
4. From 2008 to 2010 Pioneer Park was established inclusive of access roads and car parks for the purpose of use for recreation and sporting pursuits.
5. Consequently, given the chequered history relating to previous land use and subsequent remediation a number of issues have been experienced at the site. This has included an unstable surface caused by subsidence and soil consolidation, which has resulted in infrastructure such as flood lighting having to be removed due to safety concerns.
6. Due to the complex nature of the issues being experienced at Pioneer Park, the Shire has undertaken a number of studies and investigations in to potential solutions and alternative sites including the Darling Range Master Plan and an Environmental Impact Assessment of Pioneer Park.
7. The Darling Range Master Plan was endorsed by Council in July 2013, identified the need to undertake a Master Planning process at Pioneer Park.
8. The key factors providing the catalyst for the development of the Master Plan included:
 - a. A number of issues with the integrity of the playing surface i.e. subsidence, drainage etc. that have caused the playing surface to be unsuitable for play.
 - b. Supporting infrastructure having been previously removed because of subsidence.

-
- c. The age and condition of the existing infrastructure.
 - d. The need to identify a long term home for the Kalamunda and Districts Rugby League Club.
9. A Community Sport and Recreation Facilities Fund (CSRFF) application was then submitted to the Department of Sport and Recreation (DSR) in 2014 to engage a consultant to assist in undertaking a Master Plan study and subsequently the Shire was successful in obtaining a grant of \$18,333.
 10. In mid-2014, AECOM were engaged to develop the Pioneer Park Master Plan.
 11. In August 2015, Councillors received a presentation from AECOM on the Pioneer Park Master Plan. As such, the Master Plan is now presented for Council to receive.

DETAILS

12. The Pioneer Park Master Plan investigated the feasibility of remediating and redeveloping the Pioneer Park playing fields.
13. The Master Plan process included a significant amount of research into previous studies, an audit and review of facilities, community consultation and costing of options.
14. The Master Plan has estimated the total cost of remediating the site to be in the region of \$30-\$50 million plus associated building and infrastructure costs.
15. A summary of the key recommendations has been outlined below:
 - That the Shire meet with rugby and softball clubs to discuss the outcomes of the Master Plan.
 - As an interim solution, relocate the KCRLC immediately to Morrison Oval at Hartfield Park Reserve.
 - Undertake a feasibility study at Maida Vale Reserve to consider potential of converting existing netball courts into rectangular and diamond playing fields.
 - Investigate possibilities and availability of purchasing freehold land within the Forrestfield area as development occurs.
 - Consider other possible land uses for Pioneer Park.

-
16. Of the key actions outlined within the Master Plan, the priority short-term action is to work with the KCRLC and relevant clubs based at the Hartfield Park precinct to determine a suitable ground and home for them to train and play in 2016.

STATUTORY AND LEGAL CONSIDERATIONS

17. *Local Government Act 1995* Section 3.18 (c) - Effective Management of Local Government Services & Facilities.

POLICY CONSIDERATIONS

18. Nil.

COMMUNITY ENGAGEMENT REQUIREMENTS

19. A significant amount of community consultation was undertaken during the development of the Master Plan, including preliminary discussions being held with all clubs based at the Reserve, relevant state associations, neighbouring local government authorities and local schools.
20. Further consultation will be required with affected clubs based at the Reserve to confirm Pioneer Park is no longer a viable site for sport and then enable alternative options at the Hartfield Park precinct to be considered.

FINANCIAL CONSIDERATION

21. The Pioneer Park Master Plan has estimated remediation costs for the site would be in the vicinity of \$30-\$50 million, with a further \$9.6-\$9.9 million required for construction works.
22. Within the Long Term Financial Plan no funds that have been specifically set aside for the development of a new rugby league facility. However funds totalling \$2M (made up of four amounts x \$500,000 per year, commencing in 2017/18) has been included for the upgrading of Pioneer Park playing fields and additional capping works.
23. Given redeveloping facilities at Pioneer Park is no longer considered feasible, there is an option to consider reallocating these funds towards new facilities should be required.

Strategic Planning Alignment

24. *Kalamunda Advancing: Strategic Community Plan to 2023*
Strategy 1.9.1 - Support and deliver a long term approach to community facilities planning

SUSTAINABILITY

Social Implications

25. The undertaking of a study to provide strategic direction and guidance in the provision of sport and recreation infrastructure at Pioneer Park, greatly assists a long term approach in the sustainable provision of sporting facilities within the Shire.

Economic Implications

26. Nil.

Environmental Implications

27. A number of issues have been experienced at the site, including an unstable surface caused by subsidence, drainage, and soil consolidation that has resulted in the playing surface being unsuitable for play, in addition flood lighting infrastructure having to be removed due to safety concerns.

RISK MANAGEMENT CONSIDERATIONS

Risk	Likelihood	Consequence	Rating	Action/Strategy
That the affected clubs want to remain at Pioneer Park.	Possible	Minor	Medium	Emphasise that it is not financially viable to undertake required works.
That the Forrestfield Cricket Club will not want to share facilities.	Possible	Major	High	Consult with Cricket Club to explain circumstance and alternate season compatibility.
That no long term facility is available for the affected clubs.	Possible	Major	High	Further facility investigations are undertaken both within the Shire and broader region.

OFFICER COMMENT

29. The Pioneer Park Master Plan findings and associated costs have confirmed an investment of \$30-\$50 million for site remediation and a further \$9.6-\$9.9 million will be required for construction of sporting fields.
30. The findings confirm it is not financially viable to invest significant funding into remedial works and construction for it to be safe and suitable again for sports activity.

-
31. Given the key findings of the Master Plan, it is suggested the Shire undertake individual follow up with the affected user groups, as opposed to a period of public comment.
 32. The KCRLC are the only existing user group and will now require an alternative location to play and train for the 2016 season and beyond.
 33. As an interim solution, the Pioneer Park Master Plan recommends the relocation of the KCRLC immediately to Morrison Oval at Hartfield Park Reserve.
 34. The Shire is supportive of this recommendation on the basis that KCRLC affiliated junior members have been operating at Morrison Oval for the past two years, utilising the club room facility. The major benefit to the arrangement being that rugby and cricket operate during alternate sporting seasons (winter/summer).
 35. Morrison Oval is currently shared between Forrestfield United Soccer Club, Forrestfield Cricket Club and more recently the Kalamunda and Districts Rugby Union Club (KDRUC) have also been using the field to access the training lighting given the lighting on the Rugby fields has been inadequate.
 36. The floodlighting on the rugby union fields are currently being upgraded as part of the Hartfield Park Master Plan for both training and competition purposes, this will minimise the current need for KDRUC to train on the Morrison Oval and enabling KCRLC to utilise the Morrison Oval site.
 37. The extension of grounds at Morrison (cricket) Oval, with works to be completed by June 2016 is another supporting element to the proposed short-term move, providing greater capacity for shared use by the KCRLC and FUSC.
 38. In terms of the preferred longer term approach, Council has recently supported the submission of a CSRFF application to the DSR to undertake a feasibility study to consider a shared, multi-purpose club room facility at Hartfield Park that would consider the needs of a variety of potential user groups.
 39. An alternative long term approach, to be investigated in the future and referenced in the Pioneer Park Master Plan, is a feasibility study into maximising future sports use at the Maida Vale Reserve. The need for a Master Plan for the Maida Vale Reserve was supported within the Community Facilities Plan however was not deemed a high priority, therefore no funds have been identified within the Long Term Financial Plan to undertake this study within the next 10 years.

Voting Requirements: Simple Majority

OFFICER RECOMMENDATION (C&C 38/2015)

That Council:

1. Notes and receives the Pioneer Park Master Plan (Attachment 1).
2. Requests the Chief Executive Officer to convey the Pioneer Park Master Plan findings to affected Pioneer Park User Groups.
3. Notes:
 - i. the interim intention to relocate the Kalamunda/Canning Rugby League Club to Morrison Oval; and
 - ii. a long term solution for affected user groups is being progressed as part of an impending feasibility study relative to a shared use club room facility at Hartfield Park.

Moved:

Seconded:

Vote:

Attachment 1

Pioneer Park Master Plan

[Click here to go directly to the document](#)

Declaration of financial / conflict of interests to be recorded prior to dealing with each item.

39. Shire of Kalamunda Advisory Committees – Proposed Changes

Previous Items	
Responsible Officer	Chief Executive Officer
Service Area	Governance
File Reference	N/A
Applicant	N/A
Owner	N/A
 Attachment 1	 Membership and Terms of Reference for Management & Advisory Committees

PURPOSE

1. For Council to consider changes to or the abolition of a number of its Advisory Committees.

BACKGROUND

2. The Council has approved the establishment pursuant to the provisions of section 5.8 of the *Local Government Act 1995* (the Act) of 12 Management and Advisory Committees, see (Attachment 1) for details.
3. Periodic reviews of these Committees are undertaken to ensure they are operating efficiently and fulfilling the role expected when established.

DETAILS

4. The provisions of the Act require that the membership of these Committees is renewed following each local government election.
5. In preparation for the post 2015 local government election a review has been undertaken and the following issues have been identified which should be addressed prior to the election:

Abolish the following Committees

- Jack Healey Centre Advisory Committee
It is intended that there be established a Committee that considers seniors and ageing issues over the whole of the Shire.
- Falls Farm Advisory Committee
No longer serves any purpose.
- Gooseberry Hill Hall Committee
No longer serves any purpose

Amendment Required to Terms of Reference

- Community Safety and Crime Prevention Advisory Committee
Amend Clause 4.1 to – The Committee shall meet as required.
This is intended to provide flexibility with respect business demands for the committee to meet.

STATUTORY AND LEGAL CONSIDERATIONS

6. Sections 5.8, 5.9 and 5.10 of the *Local Government Act 1995*.

POLICY CONSIDERATIONS

7. Nil.

COMMUNITY ENGAGEMENT REQUIREMENTS

8. Community engagement has not been undertaken with respect to this Report.

FINANCIAL CONSIDERATIONS

9. Nil.

STRATEGIC COMMUNITY PLAN

Strategic Planning Alignment

10. *Kalamunda Advancing: Strategic Community Plan to 2023*

Strategy 6.3.3 – Regularly review the organisation’s structure, policies and procedures in response to changing circumstances.

SUSTAINABILITY

Social Implications

11. It is not expected that there will any negative social impacts from the proposed Committee changes.

Economic Implications

12. Nil.

Environmental Implications

13. Nil

RISK MANAGEMENT CONSIDERATIONS

- 14.
- | Risk | Likelihood | Consequence | Rating | Action/Strategy |
|---|------------|-------------|--------|--|
| That Council does not approve the changes to committees | Unlikely | Minor | Low | Ensure Council is aware of the need to update committee details when required. |

OFFICER COMMENT

15. Details with respect to a proposed new Seniors Committee are currently being developed.
16. It is considered a new seniors Committee should have representation from a broad range of community members to enable the Shire to consult regularly with seniors about local and shire wide issues and, amongst other matters, would support work being undertaken to develop an age-friendly community and associated plans.
17. The proposed abolition/changes to these Council Committees will ensure that all Committees are fulfilling the role when established and operating efficiently.

Voting Requirements: Simple Majority

OFFICER RECOMMENDATION (39/2015)

That Council:

1. Pursuant to section 5.8 of the *Local Government Act 1995*:
 - (a) Abolishes the Jack Healey Centre Advisory, Falls Farm Advisory and Gooseberry Hill Hall Advisory Committees.
 - (b) Approves amendments to the Terms of Reference for the following Committee:
 - (i) Community Safety and Crime Prevention Advisory Committee
Amend Clause 4.1 to – The committee shall meet as required.

Moved:

Seconded:

Vote:

Attachment 1

Membership and Terms of Reference for Management & Advisory Committees

[Click here to go directly to the document](#)

Declaration of financial / conflict of interests to be recorded prior to dealing with each item.

40. Pickering Brook Stone Fruit Festival

Previous Items	N/A
Responsible Officer	Director Development Services
Service Area	Development Services
File Reference	CO-CEV-043
Applicant	Pickering Brook Sports Club
Owner	
 Attachment 1	 Pickering Brook Stone Fruit Festival Event Plan

PURPOSE

1. To consider an application from the Pickering Brook Sports Club (the Club) for sponsorship from the Shire for the inaugural Pickering Brook Stone Fruit Festival (the Festival) in February 2016.

BACKGROUND

2. The Club proposes to organise and host the inaugural Pickering Brook Stone Fruit Festival on Saturday 13 February 2016.
3. The Club seeks sponsorship from the Shire in the sum of \$15,000 plus GST. Sponsorship is also being sought through a number of other sources including Lotterywest.

DETAILS

4. The concept of the Festival is to establish a flagship annual event focusing on and celebrating the provenance and quality of fresh local produce.
5. The Festival organisers plan to create an event that will be a culinary experience including cooking demonstrations and showcasing local produce. The event will be a celebration of food and drink with seasonal stone fruit at the forefront. It will include tastings of local seasonal produce, cider, wine and other locally produced food and drink.
6. The Festival organisers have engaged a professional event organiser to assist with the event development, budget and logistics of the inaugural event.

STATUTORY AND LEGAL CONSIDERATIONS

7. Section 3.1 *Local Government Act 1995* permits sponsorship contributions to be made.

Section 6.8 (1) (b) *Local Government Act 1995* permits expenditure from the municipal fund when it has not previously been included in the annual budget where authorised in advance by resolution.

POLICY CONSIDERATIONS

8. Hills Rural Study
Event Sponsorship Policy – COMR19

COMMUNITY ENGAGEMENT REQUIREMENTS

9. The event organisers have consulted with the Shire regarding their proposal to develop the Pickering Brook Stone Fruit Festival 2016. The Hills Orchard Improvement Group and other local community groups have also been consulted and it is anticipated they will be involved in the event.

FINANCIAL CONSIDERATIONS

10. The request for sponsorship was received after the annual event funding was finalised for the 2015/16 budget.
11. The Shire currently contributes to a range of events organised by external organisations. In the 2015/16 budget, Council approved funding contributions for events including:
- Kalamunda Show (\$13,792)
 - Bickley Harvest Festival (\$13,636)
 - Zig Zag Community Arts Festival (\$33,827)
 - Carols in the Park (\$4,244)
12. No funding has been allocated for this event from the 2015/16 budget.

STRATEGIC COMMUNITY PLAN

Strategic Planning Alignment

13. *Kalamunda Advancing: Strategic Community Plan to 2023*

OBJECTIVE 1.8 - Support local community groups to grow, prosper and shape the future of Kalamunda.

Strategy 1.8.3 Proactively investigate opportunities that facilitate the establishment and/or growth of local community groups.

Strategy 3.1.3 Identify collaborative on-ground projects that can be achieved in partnership with the community

OBJECTIVE 2.2 - To provide high quality and age appropriate entertainment for the benefit and happiness of our community

Strategy 2.2.1 Continue to provide a range of events and festivals that target the many different demographics and interest groups within the community.

Strategy 2.2.2 Investigate funding opportunities and partnerships to enhance existing events and festivals or facilitate the establishment of new events and festivals.

SUSTAINABILITY

Social Implications

14. The Festival will provide family entertainment for residents and visitors and the opportunity for community capacity building within a rural area of the Shire.
15. The Festival will provide a program of events which engages and educates on the topics of healthy eating.

Economic Implications

16. The event will provide marketing opportunities to local growers and producers. There will also be an opportunity for producers to add value to primary produce through the development of additional products.
17. It is envisioned that the 2016 Stone Fruit Festival will bring economic benefits to the community through increased visitation and through raising the profile of the Perth Hills as a visitor destination.
18. There are also opportunities to explore recommendations contained in the Hills Rural Study – Economic Development Discussion Paper such as promoting local products under a unified brand.
19. The Festival organisers project visitor numbers to be around 2,000 for the event. This would represent a significant direct benefit the local growers, businesses and the local economy.

Environmental Implications

20. The Festival will promote a lifestyle that reduces the impact on the environment and pressure on natural resources through education about local in-season produce.
21. The event will also promote local history and heritage through the involvement of the Pickering Brook Heritage Group.

RISK MANAGEMENT CONSIDERATIONS

22.	<table border="1"><thead><tr><th>Risk</th><th>Likelihood</th><th>Consequence</th><th>Rating</th><th>Action/Strategy</th></tr></thead><tbody><tr><td>The Festival does not proceed due to lack of funding</td><td>Unlikely</td><td>Minor</td><td>Low</td><td>Council allocates funding</td></tr></tbody></table>	Risk	Likelihood	Consequence	Rating	Action/Strategy	The Festival does not proceed due to lack of funding	Unlikely	Minor	Low	Council allocates funding
Risk	Likelihood	Consequence	Rating	Action/Strategy							
The Festival does not proceed due to lack of funding	Unlikely	Minor	Low	Council allocates funding							

OFFICER COMMENT

23. The Shire of Kalamunda Events Strategy focuses on developing events that provide economic value to the community and raise the profile of the area as a destination to potential visitors. The Pickering Brook Stone Fruit Festival should achieve this outcome if the organisers can deliver an ambitious inaugural event.

-
24. Festival organisers have demonstrated an increased capacity to deliver the event by engaging the same professional event organiser that was responsible for the successful Astronomy Lesson World Record in February 2015. The Pickering Brook Stone Fruit Festival Event Plan is shown as (Attachment 1).
 25. Council has previously endorsed the Hills Rural Study which foreshadowed the need for growers to diversify and add value to produce. This event will create an opportunity for growers to showcase value-added products and promote to a wider audience.
 26. Using tourism economic impact modelling forecasts, visitor numbers of 2,000 at the Pickering Brook Stone Fruit Festival 2016 would represent a direct benefit the local economy of approximately \$214,000.

Voting Requirements: Simple Majority

OFFICER RECOMMENDATION (C&C 40/2015)

That Council:

1. Approves an allocation of \$15,000 plus GST from the 2015/16 budget for sponsorship of the Pickering Brook Stone Fruit Festival 2016, from the New Event Development Account (315730.609 – 1165).

Moved:

Seconded:

Vote:

Attachment 1



INTRODUCTION



An initiative of the Pickering Brook Sports Club, it is proposed that the first Stone fruit focused festival be held at the Pickering Brook Sports Club Oval on Saturday 13 February 2016. This summer event will include tastings of local seasonal produce, cider, wine, food, Celebrity Chefs, cooking demonstrations and children's activities.

Whilst showcasing locally grown produce is the central focus of this festival, it is envisioned that the 2016 Stonefruit Festival will bring economic benefits to the local community and beyond through the attraction of high numbers of visitors to the region.

Pickering Brook is a part of the Eastern Rural Districts area of the Shire of Kalamunda and is bordered by Carmel, Bickley, Hacketts Gully, Pauls Valley and the Korung National Park. One of WA's most prolific stone-fruit growing regions, Pickering Brook is a mix of State Forest, catchment areas, hobby farms, orchards and vineyards.

STONEFRUIT FESTIVAL OBJECTIVES

- Establish a flagship annual Stone Fruit festival in the Perth Hills, focusing on and celebrating the regions growers and the Pickering Brook area.
- Strengthen the community spirit and pride in the unique culture and heritage of Pickering Brook.
- Provide sales and marketing opportunities to local growers and producers.
- Provide a program of events which engages and educates people on healthy eating and locally grown and in-season produce.
- Build the Perth Hills and Pickering Brook reputation as a major destination for quality locally produced food and wine.
- Showcase the regions environment, history and community spirit through inclusive Stone fruit themed, low cost accessible activities
- To add to the events prestige by attracting acclaimed Chefs to present Cooking Demonstrations and other activities
- To assist in building Western Australia's reputation as a producer of quality stone fruit.

STAKEHOLDERS

- Pickering Brook Sports Club
- Pickering Brook Community
- Hills Orchard Improvement Group
- Festival Partners and Sponsors



FESTIVAL NAME

The name of a festival needs to summarise the theme of the event. As a general rule the name should be short and relevant as lengthy labels can be difficult to remember. By hearing or reading the name once, people should be able to recognise the event and have a sense of what it is about. Common, but precise, terms that are on topic are the building blocks of a strong event title. It should also be easy to pronounce and pleasant to hear.

It is recommended that the name of the festival be '**Pickering Brook Stonefruit Festival**' which encapsulates the above elements.

TARGET AUDIENCE

35 to 60 year olds who live both locally and in the wider Perth area, with an interest in fresh food, wine and live entertainment.

Families who live both locally and in the wider Perth area, seeking to access affordable entertainment in a well-managed and safe environment.

Visitors from regional Western Australia, Interstate and Overseas with an aim to showcase the Perth Hills.

TICKET PRICE

The ticket price for a festival must be appropriate for the target audience and provide a revenue stream. It is proposed that the tickets be priced as follows.

Adults \$10.00 per head

Cost includes entry and can include product sampling.

Children under 12yrs free

Tickets will be pre-sold online via a ticket selling website (EventBrite, TryBooking etc.) and at the gate.

FESTIVAL ELEMENTS

- Big Top Marquee - fruit tasting and sales
- Kitchen Stage - cooking demonstrations by celebrity chefs and local talented chefs, jam making demonstration, cooking with kids
- Entertainment Stage - music, peach eating competition etc.
- Marquee 1 - cider & wine tasting tent
- Activity Area - children's activities & games
- Gourmet Food Vendors - food trucks
- Local Produce stalls - food, cheese, chocolate, asparagus etc.
- Clubhouse - Bar, lunches & musician

EVENT FUNDING



FUNDING APPLICATIONS

LOTTERYWEST

A funding application must be submitted to Lotterywest on or before the 1 August 2015. As a general rule, grants by Lotterywest are to complement other sources of support, including a contribution from the organisation's own resources. Lotterywest can also assist with combining their grant with other sources of funding.

SHIRE OF KALAMUNDA

A funding proposal must be submitted to the Shire of Kalamunda on or before the 1 August 2015. The proposal will be submitted to council in late August, the final decision on the funding amount will be decided at this time.

CORPORATE SPONSORSHIP INFORMATION

A professional sponsorship package illustrating commercial advantages and the 'fit' between the sponsor and the Stonefruit Festival is vital. This includes highlighting potential corporate objectives like social and community engagement, brand-related and sales objectives and media coverage.

The Stonefruit Festival sponsorship package can be developed to meet the needs of different types of sponsors, for example, Major Partner (naming rights) <\$25,000, Platinum Partner <\$10,000, Gold Partner <\$5000 and Corporate Partner <\$1000.

CORPORATE PARTNERS

Once created, the sponsorship package should target state and local sponsors, national companies with local interests and local advertisers - See example of potential partners below.

LiveLighter
Healthway
Act Belong Commit
Perth Airport
Commercial Television and Radio
Great Greengrocer
Summerfruit Australia
Visy
Kleenheat
Healthway

Good Guys
High Wycombe Community Bank® Branch of Bendigo Bank
Forrestfield Community Bank® Branch of Bendigo Bank
Kalamunda Chamber of Commerce
Kalamunda Toyota
Core Cider House
Hidden Valley Eco Lodges and Day Spa
Due Jolly Winery
Myattsfield Vineyards
Hainault Vineyard

Plume Estate Vineyard
Carldenn Homestead Wines
All We Need Is Right Here
Bank of Ideas
Pickering Brook Sports Club

DRAFT BUDGET

The draft festival budget is a projection of the income and expenditure that the festival will incur based on plans made and information gathered.

It is expected that there will be numerous adjustments and refinements to the budget throughout the planning process.

It is not possible to know every cost from the start, nor is it possible to know whether efforts to secure sponsorship and government funding will be successful.



Stonefruit Festival 2016 Draft Budget - Breakdown

INCOME	PROJECTED
Government	
Shire of Kalamunda	\$15,000.00
Litterywest	\$10,000.00
Sponsorship	
Sponsors Package	\$20,000.00
Ticket Sales	
2000 Ticket sales @ \$10.00	\$20,000.00
Exhibitors	
10 exhibitors @ \$150,000 ea.	\$1,500,000
	\$106,500.00

EXPENDITURE	PROJECTED
Equipment	
Marquees	\$18,000.00
Generators	\$2,500.00
Fencing	\$2,000.00
Furniture	\$2,000.00
Staging	\$10,000.00
Toilets	\$1,500.00
Cool rooms	\$100.00
Bins	\$100.00
Kitchen	\$2,000.00
Big Screen HVT	\$2,000.00

EXPENDITURE	PROJECTED
Entertainment	
MC	\$2,000.00
Celebrity Chef/s	\$12,000.00
Musicians	\$3,000.00
Children's Activities	\$2,000.00
Promotion & Marketing	
Design/Artwork	\$2,000.00
Programs, Sponsorship & Signage	\$1,000.00
Printing	\$2,500.00
Newspaper/Magazine	\$1,000.00
Social Media	\$300.00
Online	\$300.00
Radio/Television	\$5,000.00
Staff & Management	
230hrs Event Coordination	\$10,000.00
Security	\$3,000.00
First Aid	\$1,000.00
Production (Sound & Stages)	\$2,000.00
Administration	
Council Permits	\$400.00
Liquor Licence	\$150.00
Sundry	\$950.00
Contingency	
Approx. 5% of the total budget	\$5,000.00
	\$106,500.00



COMMUNITY PARTNERS

Events provide Community Groups with wider access to the public to showcase their organisation, build social connections and fundraise. The Stonefruit Festival will provide an opportunity to local community groups to be involved on festival day through the provision of food, activities and education. Examples of local community groups;

- Hills Orchard Improvement Group
- Pickering Brook Heritage Group
- Pickering Brook Primary School
- Local sporting groups
- Guide & Scout Groups

MARKETING

A comprehensive marketing strategy to achieve marketing objectives is required to ensure that the Stonefruit Festival is connecting with the identified target market. The plan should include the marketing budget and marketing tools to be used.

- Print: posters, leaflets, postcards, programmes, etc.
- Direct mail and print distribution
- Media advertising: print, radio and TV
- Website/internet/e-bulletins
- Outdoor advertising: banners, billboards, bus sides etc.
- Media releases, promotions and activity
- Media sponsorship



DRAFT TIMELINE

July	August	September	October	November	December	January	February
PBSC event agreement	Finalise Sponsorship Plan	Start supplier negotiation	Source entertainment	Commence pre-advertising	Merchandise if required	Create risk management plan	Bump in/out
Set up Festival Committee	Finalise Marketing Plan	Call for expressions of interest - food, produce etc.		Tickets on-sale	Order branded event shirts	Volunteer recruitment	De-brief & planning for 2017
Submit Lotterywest Application	Engage with external potential sponsors and community groups			Prepare press release, media alert, posters, brochures, signage	Distribute promo materials	Press release	
Submit SOK Proposal	Start talent negotiation			Apply for permits		Site signage - toilets, parking etc.	
Commence graphic design drafts - logo, promo materials						Re-confirm all suppliers & organise a site visit	

Declaration of financial / conflict of interests to be recorded prior to dealing with each item.

41. Lesmurdie Tennis Club (Inc.) of 22 Falls Road, Lesmurdie – Term of Lease

Previous Items	OCM 23/2013
Responsible Officer	Director Corporate Services
Service Area	Financial Services
File Reference	FL-02/022
Applicant	Lesmurdie Tennis Club (Inc)
Owner	Shire of Kalamunda
Attachment 1	Letter from Lesmurdie Tennis Club

PURPOSE

1. To consider a request from Lesmurdie Tennis Club (the Club) for a lease term of 10 years plus an option of a further 10 year period (Attachment 1).

BACKGROUND

2. At the Ordinary Council Meeting held on 25 February 2013, Council adopted Lease Policy LEA1 – Community Groups' Lease Council Policy.
3. The Club's existing lease (with a term of five years and an option of five years) expired on 30 September 2009.
4. The Shire has been in negotiations with the Club for an extended period of time in attempting to resolve concerns regarding the structure of the Lease Agreement, particularly related to the responsibilities for maintenance and repairs. During that time briefings have been provided to Ward Councillors regarding the status of negotiations and the two parties have been working through a process to resolve the Club's issues.
5. The Club recently held a committee meeting to discuss the status of the Lease Agreement and confirmed that it was their intention to accept the current lease agreement, provided that the lease term would accommodate a term of 10 years and an option of a further 10 years. The Club was advised that an extended lease period could only be approved by Council
6. The Club's request for a lease period of 10 years plus an option of a further 10 years relates to their proposed significant capital investment into the playing surfaces which will result in the life span of these facilities extending well past the lease term. Current projections by the Club propose to invest more than \$100,000 into the replacement and improvement of their playing surfaces over the next five years.
7. The associated procedure noted that a typical lease term would be five years, however the Shire at its discretion, may consider a longer term where the term is required to support a loan arrangement or, in other extenuating circumstances, where approved by resolution of Council.

DETAILS

8. The Club is seeking a lease term of 10 years plus an option of a further 10 years on the grounds that they will be making lump sum capital contributions towards various renewal and maintenance works over coming years. It is envisaged that the total investment will exceed \$100,000 over the next five years.
9. The Club advises that it is likely that the first two synthetic courts will be replaced in 2016/17 with an annual cost of approximately \$40,000. The next two synthetic courts will be due for replacement in 2018/19. In addition, it is likely that a further \$30,000 will be required to resurface flexi pave courts in 2018/19. It should be noted that these costs are indicative and will be dependent on a number of factors, including available funding from the State Government.
10. The Club proposes to seek funding of the planned renewal and maintenance works through a variety of sources. They intend to seek support from the State Government, the Shire of Kalamunda and through their own capital contributions.

STATUTORY AND LEGAL CONSIDERATIONS

11. Nil.

POLICY CONSIDERATIONS

12. LEA1 – Community Groups Lease policy – Term of Lease.

COMMUNITY ENGAGEMENT REQUIREMENTS

13. Nil.

FINANCIAL CONSIDERATIONS

14. There are no significant financial implications for 2015/16. However, the Club may seek Shire contribution to proposed works in future years.

STRATEGIC COMMUNITY PLAN

Strategic Planning Alignment

15. *Kalamunda Advancing: Strategic Community Plan to 2023*

OBJECTIVE 1.8 – Support local community groups to grow, prosper and shape the future of Kalamunda.

Strategy 1.8.3 – Proactively investigate opportunities that facilitate the establishment and/or growth of local community groups.

SUSTAINABILITY

Social Implications

16. Nil.

Economic Implications

17. Nil.

Environmental Implications

18. Nil.

RISK MANAGEMENT CONSIDERATIONS

19.

Risk	Likelihood	Consequence	Rating	Action/Strategy
Council may resolve not to support the recommendation made	Possible	Minor	Medium	Inform Council of the group background

OFFICER COMMENT

20. The Club's request for a lease period of 10 years plus an option of a further 10 years is supported based on plans to invest more than \$100,000 into the replacement and improvement of their playing surfaces over the next five years.
21. Formalisation of a Lease Agreement will provide greater certainty to the Club and the Shire in the utilisation of community facilities. It will also ensure that Community Groups are treated more equitably.
22. Considerable effort has gone into developing a stronger working relationship between the Shire and the Club. These efforts are now bringing some positive results, illustrated in the Club's willingness to enter into a Lease Agreement.

Voting Requirements: Simple Majority

OFFICER RECOMMENDATION (C&C 41/2015)

That Council:

1. Agrees to the request from Lesmurdie Tennis Club for a lease term of 10 years with a further option of 10 years in accordance with Policy LEA1 – Community Groups Lease Policy – Term of Lease.

Moved:

Seconded:

Vote:

Attachment 1

LESMURDIE TENNIS CLUB (Inc.)

PO Box 91
Kalamunda WA 6926

ABN 97 132 750 426

PRESIDENT:
John Ferguson

SECRETARY:
Hilary Rowland

19 January 2014

Mr Warwick Carter
Manager Economic Property and Procurement Services
Shire of Kalamunda
PO Box 42 Kalamunda WA 6926

Dear Warwick,

New Lease Document – Application for 10 Year Terms

I refer to the Shire's letter dated 9 January 2014.

- 1: Thank you for clarifying procedures concerning negotiation of the term of the new lease.

In line with your clarification under "Comment 36" of that letter, we hereby provide written confirmation that the Club makes application for a 10 Year Term commencing 1 July 2013 and a Further 10 Year Term commencing 1 July 2023,

The circumstances are that we will, in all probability, be making lump sum capital contributions towards various renewal and maintenance works in and around the Lesmurdie tennis facility over the coming years. The contributions would be substantial of the order of thousands to tens of thousands of dollars in each case.

As you are aware, these works deliver outcomes which vest in the Shire and not the Club.

The way the Club can secure its investment is by way of a lease agreement with the Shire.

Also, these capital contributions deliver outcomes which have relatively long life spans – of the order of 8-20 years. Logically, any lease agreement needs to operate over equivalent time spans. This ensures that the lessee gets full value from the capital contributions it has made.

In the foreseeable future, lump sum capital contributions are likely to be made for the following:

- Clubhouse extensions and refit – final payment in the next few months with a remaining life span of 18 years
- Toilet/bathroom renewal – in two years' time with a life span of 20 years
- Hard court resurfacing and net post/winder replacement – in two years' time with a lifespan of 8 years

- Synthetic grass court resurfacing and net post/winder replacement - in one to five years' time with a life span of 11 years
- Court 4 light tower modification – in one years' time with a life span of 20 years

2. Thank you for clarifying your interpretation of Clause 18 "Option to Renew".
However, from our point of view, the contentious part of this clause remains:

"...the Lessor shall grant to the Lessee a lease for the Further Term at the Rent and on terms and conditions similar to this Lease... and on such other terms and conditions as the Lessor may consider appropriate."

Our interpretation of this statement is that it gives the Shire absolute discretion to change the terms and conditions of any renewal as it sees fit. As such it defeats the purpose of an option to renew. To be of value, the terms of a renewed lease need to be predictable at the time of entering into the initial lease. Where that is not the case, any right to renew is of questionable value and cannot be relied on as providing certainty past the initial term.

We consider the wording of our expired lease (refer Clause 3. below) encapsulates a genuine option to renew and should be reflected in the new lease. Neither party has the right to make any unilateral changes to the terms of the lease.

OPTION OF RENEWAL

The Lessee having duly and punctually paid the rent hereby reserved and complied with, observed and performed all of the terms, covenants and conditions herein contained or implied on the part the Lessee to be complied with, observed by and performed shall have the option at the expiration of the term hereby granted of extending this Lease for the further term specified in Item 4 of the schedule exercisable by the written request of the Lessee made not more than six (6) months nor less than three (3) months prior to the expiration of the term specified in Item 2 of the schedule upon the same covenants, conditions and stipulations as are contained in this Lease (except for this present option of renewal) and the rent during the further term as agreed upon by the parties prior to commencement of the option term or as specified in Item 5 of the schedule.

We trust you will rule in our favour on these issues as outlined above and look forward to a positive outcome from Council.

Many thanks.

Yours sincerely,

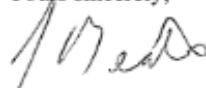

Geoff Meates
Shire Liaison

10.0 MOTIONS OF WHICH PREVIOUS NOTICE HAS BEEN GIVEN

11.0 QUESTIONS BY MEMBERS WITHOUT NOTICE

12.0 QUESTIONS BY MEMBERS OF WHICH DUE NOTICE HAS BEEN GIVEN

12.1 Cr Justin Whitten – Lighting a the New Skate Park

Q. Please could staff investigate the cost of lighting at the new skate park as I feel some passive surveillance would be appropriate?

A. This matter is being investigated, along with the provision of a toilet block, CCTV cameras and a safe crossing of Hale Road. A report will be presented to Council on the options and associated costs.

12.2 Cr Simon Di Rosso – Stirk Park Master Plan

Q. I believe there is a Stirk Park Master Plan, could Council have an update on the progress of this?

A. An in house project team will commence the planning and preparation of a Stirk Park Master Plan early in 2016.

13.0 URGENT BUSINESS APPROVED BY THE PRESIDING MEMBER OR BY DECISION

14.0 MEETING CLOSED TO THE PUBLIC

15.0 CLOSURE